



Full wwPDB X-ray Structure Validation Report ⓘ

Mar 4, 2024 – 01:01 AM EST

PDB ID : 6OZK
Title : Crystal structure of *Mus musculus* (Mm) Endonuclease V in complex with a 23mer RNA oligo containing an inosine after 68h soak in Ca²⁺
Authors : Samara, N.L.; Yang, W.
Deposited on : 2019-05-15
Resolution : 2.10 Å (reported)

This is a Full wwPDB X-ray Structure Validation Report for a publicly released PDB entry.

We welcome your comments at validation@mail.wwpdb.org

A user guide is available at

<https://www.wwpdb.org/validation/2017/XrayValidationReportHelp>

with specific help available everywhere you see the ⓘ symbol.

The types of validation reports are described at

<http://www.wwpdb.org/validation/2017/FAQs#types>.

The following versions of software and data (see [references ⓘ](#)) were used in the production of this report:

MolProbity : 4.02b-467
Mogul : 1.8.5 (274361), CSD as541be (2020)
Xtriage (Phenix) : 1.13
EDS : 2.36
buster-report : 1.1.7 (2018)
Percentile statistics : 20191225.v01 (using entries in the PDB archive December 25th 2019)
Refmac : 5.8.0158
CCP4 : 7.0.044 (Gargrove)
Ideal geometry (proteins) : Engh & Huber (2001)
Ideal geometry (DNA, RNA) : Parkinson et al. (1996)
Validation Pipeline (wwPDB-VP) : 2.36

1 Overall quality at a glance

The following experimental techniques were used to determine the structure:

X-RAY DIFFRACTION

The reported resolution of this entry is 2.10 Å.

Percentile scores (ranging between 0-100) for global validation metrics of the entry are shown in the following graphic. The table shows the number of entries on which the scores are based.

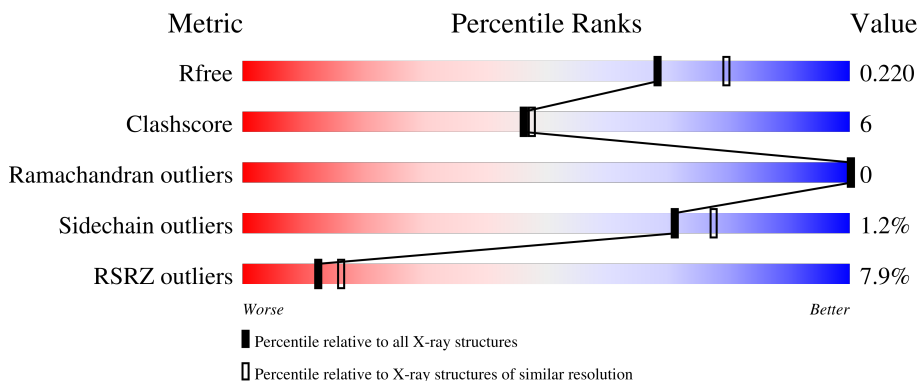

Metric	Whole archive (#Entries)	Similar resolution (#Entries, resolution range(Å))
R_{free}	130704	5197 (2.10-2.10)
Clashscore	141614	5710 (2.10-2.10)
Ramachandran outliers	138981	5647 (2.10-2.10)
Sidechain outliers	138945	5648 (2.10-2.10)
RSRZ outliers	127900	5083 (2.10-2.10)

The table below summarises the geometric issues observed across the polymeric chains and their fit to the electron density. The red, orange, yellow and green segments of the lower bar indicate the fraction of residues that contain outliers for ≥ 3 , 2, 1 and 0 types of geometric quality criteria respectively. A grey segment represents the fraction of residues that are not modelled. The numeric value for each fraction is indicated below the corresponding segment, with a dot representing fractions $\leq 5\%$. The upper red bar (where present) indicates the fraction of residues that have poor fit to the electron density. The numeric value is given above the bar.

Mol	Chain	Length	Quality of chain
1	A	246	
1	B	246	
2	C	23	
2	D	23	

The following table lists non-polymeric compounds, carbohydrate monomers and non-standard

residues in protein, DNA, RNA chains that are outliers for geometric or electron-density-fit criteria:

Mol	Type	Chain	Res	Chirality	Geometry	Clashes	Electron density
6	TLA	A	309	-	X	-	-
6	TLA	A	310	-	X	-	-

2 Entry composition [i](#)

There are 8 unique types of molecules in this entry. The entry contains 4735 atoms, of which 0 are hydrogens and 0 are deuteriums.

In the tables below, the ZeroOcc column contains the number of atoms modelled with zero occupancy, the AltConf column contains the number of residues with at least one atom in alternate conformation and the Trace column contains the number of residues modelled with at most 2 atoms.

- Molecule 1 is a protein called Endonuclease V.

Mol	Chain	Residues	Atoms					ZeroOcc	AltConf	Trace
			Total	C	N	O	S			
1	A	244	Total	C	N	O	S	0	5	0
			1918	1217	347	346	8			
1	B	246	Total	C	N	O	S	0	7	0
			1954	1242	358	346	8			

There are 2 discrepancies between the modelled and reference sequences:

Chain	Residue	Modelled	Actual	Comment	Reference
A	251	ALA	-	expression tag	UNP Q8C9A2
B	251	ALA	-	expression tag	UNP Q8C9A2

- Molecule 2 is DNA/RNA hybrid called DNA/RNA (5'-R(P*CP*GP*GP*UP*AP*AP*CP*CP*C)-D(P*I)-R(P*AP*UP*AP*UP*GP*CP*AP*UP*GP*CP*AP*UP*U)-3').

Mol	Chain	Residues	Atoms					ZeroOcc	AltConf	Trace
			Total	C	N	O	P			
2	C	15	Total	C	N	O	P	0	0	0
			315	142	53	105	15			
2	D	15	Total	C	N	O	P	0	0	0
			315	142	53	105	15			

- Molecule 3 is CALCIUM ION (three-letter code: CA) (formula: Ca) (labeled as "Ligand of Interest" by depositor).

Mol	Chain	Residues	Atoms		ZeroOcc	AltConf
3	A	2	Total	Ca	0	0
			2	2		
3	B	2	Total	Ca	0	0
			2	2		

- Molecule 4 is GLYCEROL (three-letter code: GOL) (formula: C₃H₈O₃).



Mol	Chain	Residues	Atoms	ZeroOcc	AltConf
4	A	1	Total C O 6 3 3	0	0
4	A	1	Total C O 6 3 3	0	0
4	A	1	Total C O 6 3 3	0	0
4	A	1	Total C O 6 3 3	0	0
4	A	1	Total C O 6 3 3	0	0

- Molecule 5 is 1,2-ETHANEDIOL (three-letter code: EDO) (formula: C₂H₆O₂).



Mol	Chain	Residues	Atoms			ZeroOcc	AltConf
5	A	1	Total	C	O	0	0
			4	2	2		

- Molecule 6 is L(+)-TARTARIC ACID (three-letter code: TLA) (formula: C₄H₆O₆).

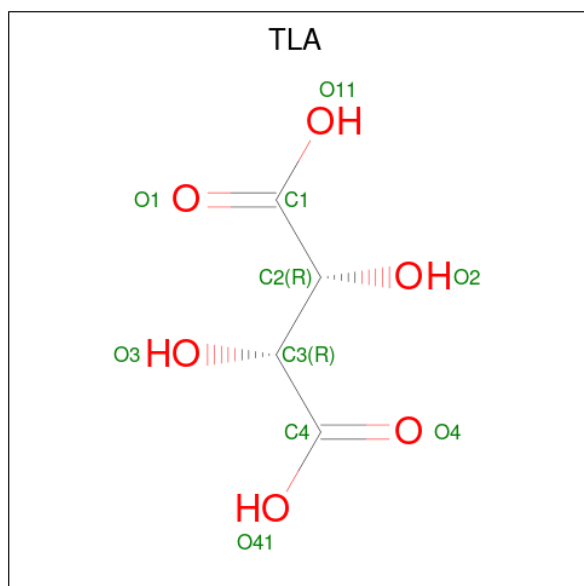

Mol	Chain	Residues	Atoms			ZeroOcc	AltConf
6	A	1	Total	C	O	0	0
			10	4	6		
6	A	1	Total	C	O	0	0
			10	4	6		
6	D	1	Total	C	O	0	0
			10	4	6		

- Molecule 7 is TRIETHYLENE GLYCOL (three-letter code: PGE) (formula: C₆H₁₄O₄).



Mol	Chain	Residues	Atoms	ZeroOcc	AltConf
7	B	1	Total C O 10 6 4	0	0
7	B	1	Total C O 10 6 4	0	0

- Molecule 8 is water.

Mol	Chain	Residues	Atoms	ZeroOcc	AltConf
8	A	80	Total O 80 80	0	0
8	B	45	Total O 45 45	0	0
8	C	9	Total O 9 9	0	0
8	D	11	Total O 11 11	0	0

3 Residue-property plots [i](#)

These plots are drawn for all protein, RNA, DNA and oligosaccharide chains in the entry. The first graphic for a chain summarises the proportions of the various outlier classes displayed in the second graphic. The second graphic shows the sequence view annotated by issues in geometry and electron density. Residues are color-coded according to the number of geometric quality criteria for which they contain at least one outlier: green = 0, yellow = 1, orange = 2 and red = 3 or more. A red dot above a residue indicates a poor fit to the electron density ($RSRZ > 2$). Stretches of 2 or more consecutive residues without any outlier are shown as a green connector. Residues present in the sample, but not in the model, are shown in grey.

- Molecule 1: Endonuclease V

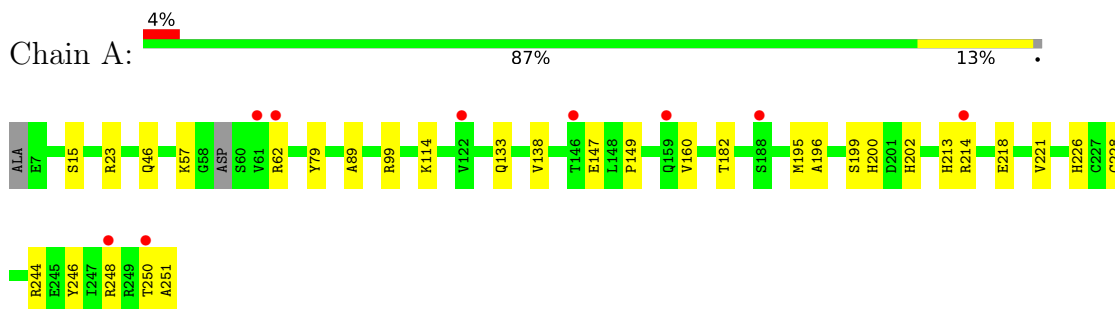

- Molecule 1: Endonuclease V

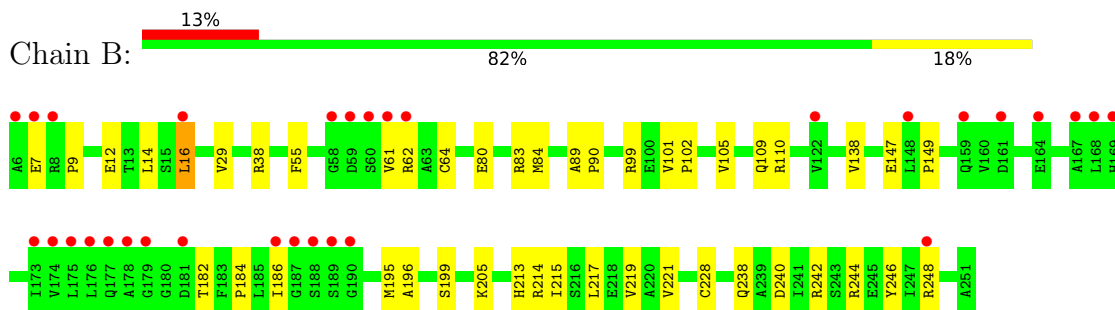

- Molecule 2: DNA/RNA (5'-R(P*CP*GP*GP*UP*AP*AP*CP*CP*C)-D(P*I)-R(P*AP*UP*A P*UP*GP*CP*AP*UP*GP*CP*AP*UP*U)-3')

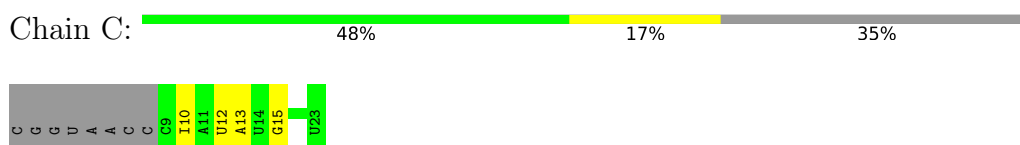

- Molecule 2: DNA/RNA (5'-R(P*CP*GP*GP*UP*AP*AP*CP*CP*C)-D(P*I)-R(P*AP*UP*A P*UP*GP*CP*AP*UP*GP*CP*AP*UP*U)-3')



4 Data and refinement statistics i

Property	Value	Source
Space group	P 21 21 21	Depositor
Cell constants a, b, c, α , β , γ	71.82Å 73.01Å 155.23Å 90.00° 90.00° 90.00°	Depositor
Resolution (Å)	35.54 – 2.10 41.98 – 2.10	Depositor EDS
% Data completeness (in resolution range)	93.8 (35.54-2.10) 93.7 (41.98-2.10)	Depositor EDS
R_{merge}	(Not available)	Depositor
R_{sym}	(Not available)	Depositor
$\langle I/\sigma(I) \rangle$ ¹	3.11 (at 2.10Å)	Xtrriage
Refinement program	PHENIX 1.10.1_2155	Depositor
R, R_{free}	0.177 , 0.214 0.184 , 0.220	Depositor DCC
R_{free} test set	2235 reflections (4.95%)	wwPDB-VP
Wilson B-factor (Å ²)	37.9	Xtrriage
Anisotropy	0.741	Xtrriage
Bulk solvent k_{sol} (e/Å ³), B_{sol} (Å ²)	0.35 , 52.7	EDS
L-test for twinning ²	$\langle L \rangle = 0.48$, $\langle L^2 \rangle = 0.31$	Xtrriage
Estimated twinning fraction	0.025 for k,h,-l	Xtrriage
F_o, F_c correlation	0.96	EDS
Total number of atoms	4735	wwPDB-VP
Average B, all atoms (Å ²)	54.0	wwPDB-VP

Xtrriage's analysis on translational NCS is as follows: *The analyses of the Patterson function reveals a significant off-origin peak that is 22.97 % of the origin peak, indicating pseudo-translational symmetry. The chance of finding a peak of this or larger height randomly in a structure without pseudo-translational symmetry is equal to 5.1159e-03. The detected translational NCS is most likely also responsible for the elevated intensity ratio.*

¹Intensities estimated from amplitudes.

²Theoretical values of $\langle |L| \rangle$, $\langle L^2 \rangle$ for acentric reflections are 0.5, 0.333 respectively for untwinned datasets, and 0.375, 0.2 for perfectly twinned datasets.

5 Model quality [i](#)

5.1 Standard geometry [i](#)

Bond lengths and bond angles in the following residue types are not validated in this section: TLA, PGE, EDO, CA, GOL

The Z score for a bond length (or angle) is the number of standard deviations the observed value is removed from the expected value. A bond length (or angle) with $|Z| > 5$ is considered an outlier worth inspection. RMSZ is the root-mean-square of all Z scores of the bond lengths (or angles).

Mol	Chain	Bond lengths		Bond angles	
		RMSZ	# Z >5	RMSZ	# Z >5
1	A	0.41	0/1969	0.58	0/2664
1	B	0.36	0/2009	0.53	0/2720
2	C	0.50	0/326	0.91	0/502
2	D	0.53	0/326	1.12	4/502 (0.8%)
All	All	0.41	0/4630	0.65	4/6388 (0.1%)

There are no bond length outliers.

All (4) bond angle outliers are listed below:

Mol	Chain	Res	Type	Atoms	Z	Observed(°)	Ideal(°)
2	D	9	C	C5-C6-N1	5.96	123.98	121.00
2	D	9	C	C6-N1-C2	-5.77	117.99	120.30
2	D	9	C	C2-N1-C1'	5.57	124.93	118.80
2	D	9	C	O4'-C1'-N1	5.46	112.57	108.20

There are no chirality outliers.

There are no planarity outliers.

5.2 Too-close contacts [i](#)

In the following table, the Non-H and H(model) columns list the number of non-hydrogen atoms and hydrogen atoms in the chain respectively. The H(added) column lists the number of hydrogen atoms added and optimized by MolProbity. The Clashes column lists the number of clashes within the asymmetric unit, whereas Symm-Clashes lists symmetry-related clashes.

Mol	Chain	Non-H	H(model)	H(added)	Clashes	Symm-Clashes
1	A	1918	0	1967	22	0
1	B	1954	0	2022	32	0
2	C	315	0	160	4	0

Continued on next page...

Continued from previous page...

Mol	Chain	Non-H	H(model)	H(added)	Clashes	Symm-Clashes
2	D	315	0	160	3	0
3	A	2	0	0	0	0
3	B	2	0	0	0	0
4	A	30	0	40	4	0
5	A	4	0	6	0	0
6	A	20	0	8	2	0
6	D	10	0	4	0	0
7	B	20	0	28	2	0
8	A	80	0	0	1	0
8	B	45	0	0	2	0
8	C	9	0	0	0	0
8	D	11	0	0	0	0
All	All	4735	0	4395	57	0

The all-atom clashscore is defined as the number of clashes found per 1000 atoms (including hydrogen atoms). The all-atom clashscore for this structure is 6.

All (57) close contacts within the same asymmetric unit are listed below, sorted by their clash magnitude.

Atom-1	Atom-2	Interatomic distance (Å)	Clash overlap (Å)
1:A:23:ARG:NH1	8:A:401:HOH:O	2.14	0.79
1:A:89:ALA:O	1:A:99:ARG:NH1	2.15	0.78
1:B:240:ASP:OD2	1:B:244:ARG:NH2	2.19	0.75
1:A:114:LYS:HE2	4:A:303:GOL:H2	1.73	0.70
1:B:238:GLN:OE1	1:B:242[A]:ARG:NH1	2.28	0.67
1:B:195:MET:HG3	1:B:221:VAL:HG21	1.78	0.64
1:A:57:LYS:HB2	2:C:13:A:H4'	1.82	0.62
1:B:55:PHE:CD1	2:D:12:U:H4'	2.36	0.60
1:A:199:SER:HB2	1:A:228:CYS:SG	2.44	0.58
1:B:213:HIS:CD2	1:B:214[B]:ARG:HG3	2.39	0.57
1:B:9:PRO:HG2	1:B:14:LEU:HD21	1.87	0.57
1:A:138:VAL:H	2:C:10:DI:H1	1.54	0.56
1:A:195:MET:HG3	1:A:221:VAL:HG21	1.87	0.56
1:B:38:ARG:HG3	7:B:303:PGE:H52	1.89	0.55
1:B:38:ARG:NH2	8:B:401:HOH:O	2.37	0.55
1:A:182:THR:O	6:A:309:TLA:C4	2.55	0.54
1:B:248:ARG:CZ	2:C:15:G:H5''	2.37	0.54
1:A:57:LYS:HE2	2:C:12:U:O2'	2.06	0.54
1:B:199:SER:HB2	1:B:228:CYS:SG	2.49	0.53
1:B:138:VAL:H	2:D:10:DI:H1	1.57	0.53
1:B:7:GLU:O	1:B:90:PRO:HG3	2.10	0.51

Continued on next page...

Continued from previous page...

Atom-1	Atom-2	Interatomic distance (Å)	Clash overlap (Å)
1:A:79:TYR:CE2	4:A:303:GOL:H12	2.46	0.51
1:B:83:ARG:HD2	1:B:110:ARG:NH1	2.25	0.51
1:B:84:MET:HG2	1:B:246:TYR:CE2	2.45	0.51
1:A:147:GLU:O	1:A:214[A]:ARG:NH1	2.44	0.50
1:B:64:CYS:SG	1:B:246:TYR:HD2	2.34	0.49
1:B:9:PRO:HD3	1:B:90:PRO:HG2	1.94	0.49
6:A:309:TLA:O41	6:A:309:TLA:O2	2.23	0.48
1:B:12:GLU:O	1:B:16:LEU:HD22	2.13	0.48
1:A:46:GLN:HB3	4:A:307:GOL:H32	1.95	0.48
1:B:195:MET:HG2	1:B:217:LEU:HD21	1.94	0.48
1:A:182:THR:HA	1:A:196:ALA:O	2.14	0.48
1:B:214[A]:ARG:NH2	8:B:406:HOH:O	2.47	0.47
1:A:244:ARG:HG2	1:A:248:ARG:NH1	2.29	0.47
1:A:250:THR:OG1	1:A:251:ALA:N	2.46	0.47
7:B:304:PGE:H3	7:B:304:PGE:H5	1.75	0.47
1:B:105:VAL:O	1:B:109:GLN:HG3	2.14	0.46
1:B:29:VAL:HG21	1:B:214[B]:ARG:NH1	2.31	0.46
1:A:133:GLN:HA	1:A:160:VAL:HG21	1.99	0.45
1:B:147:GLU:OE2	1:B:214[B]:ARG:NH2	2.47	0.45
1:B:215:ILE:HD11	1:B:219:VAL:HG12	1.97	0.45
2:D:9:C:H1'	2:D:10:DI:OP1	2.17	0.45
1:A:218:GLU:H	1:A:218:GLU:CD	2.18	0.45
1:B:184:PRO:HB2	1:B:186:ILE:HD11	1.99	0.45
1:B:9:PRO:HD3	1:B:90:PRO:CG	2.47	0.44
1:A:226:HIS:HA	4:A:304:GOL:H2	2.00	0.43
1:B:29:VAL:HG21	1:B:214[B]:ARG:HH12	1.84	0.43
1:B:149:PRO:HA	1:B:213:HIS:O	2.19	0.42
1:B:89:ALA:O	1:B:99:ARG:NH1	2.49	0.42
1:A:149:PRO:HA	1:A:213:HIS:O	2.21	0.41
1:B:101[A]:VAL:HG12	1:B:102:PRO:HD3	2.03	0.41
1:B:182:THR:HA	1:B:196:ALA:O	2.21	0.41
1:B:80:GLU:HG3	1:B:242[A]:ARG:HD3	2.03	0.41
1:A:182:THR:HG21	1:A:221:VAL:HG11	2.02	0.40
1:B:205:LYS:HE3	1:B:205:LYS:HB3	1.61	0.40
1:A:200:HIS:CE1	1:A:202:HIS:HB2	2.56	0.40
1:A:246:TYR:O	1:A:250:THR:HG23	2.20	0.40

There are no symmetry-related clashes.

5.3 Torsion angles [i](#)

5.3.1 Protein backbone [i](#)

In the following table, the Percentiles column shows the percent Ramachandran outliers of the chain as a percentile score with respect to all X-ray entries followed by that with respect to entries of similar resolution.

The Analysed column shows the number of residues for which the backbone conformation was analysed, and the total number of residues.

Mol	Chain	Analysed	Favoured	Allowed	Outliers	Percentiles	
1	A	245/246 (100%)	237 (97%)	8 (3%)	0	100	100
1	B	251/246 (102%)	244 (97%)	7 (3%)	0	100	100
All	All	496/492 (101%)	481 (97%)	15 (3%)	0	100	100

There are no Ramachandran outliers to report.

5.3.2 Protein sidechains [i](#)

In the following table, the Percentiles column shows the percent sidechain outliers of the chain as a percentile score with respect to all X-ray entries followed by that with respect to entries of similar resolution.

The Analysed column shows the number of residues for which the sidechain conformation was analysed, and the total number of residues.

Mol	Chain	Analysed	Rotameric	Outliers	Percentiles	
1	A	212/210 (101%)	209 (99%)	3 (1%)	67	73
1	B	215/210 (102%)	212 (99%)	3 (1%)	67	73
All	All	427/420 (102%)	421 (99%)	6 (1%)	71	73

All (6) residues with a non-rotameric sidechain are listed below:

Mol	Chain	Res	Type
1	A	15[A]	SER
1	A	15[B]	SER
1	A	62	ARG
1	B	16	LEU
1	B	61	VAL
1	B	62	ARG

Sometimes sidechains can be flipped to improve hydrogen bonding and reduce clashes. There are

no such sidechains identified.

5.3.3 RNA [i](#)

There are no RNA molecules in this entry.

5.4 Non-standard residues in protein, DNA, RNA chains [i](#)

There are no non-standard protein/DNA/RNA residues in this entry.

5.5 Carbohydrates [i](#)

There are no monosaccharides in this entry.

5.6 Ligand geometry [i](#)

Of 15 ligands modelled in this entry, 4 are monoatomic - leaving 11 for Mogul analysis.

In the following table, the Counts columns list the number of bonds (or angles) for which Mogul statistics could be retrieved, the number of bonds (or angles) that are observed in the model and the number of bonds (or angles) that are defined in the Chemical Component Dictionary. The Link column lists molecule types, if any, to which the group is linked. The Z score for a bond length (or angle) is the number of standard deviations the observed value is removed from the expected value. A bond length (or angle) with $|Z| > 2$ is considered an outlier worth inspection. RMSZ is the root-mean-square of all Z scores of the bond lengths (or angles).

Mol	Type	Chain	Res	Link	Bond lengths			Bond angles		
					Counts	RMSZ	# Z > 2	Counts	RMSZ	# Z > 2
4	GOL	A	305	-	5,5,5	0.32	0	5,5,5	0.40	0
6	TLA	A	310	-	9,9,9	1.12	0	12,12,12	1.52	4 (33%)
6	TLA	D	101	-	9,9,9	1.03	0	12,12,12	1.22	1 (8%)
7	PGE	B	303	-	9,9,9	0.41	0	8,8,8	0.25	0
4	GOL	A	304	-	5,5,5	0.31	0	5,5,5	0.42	0
4	GOL	A	307	-	5,5,5	0.38	0	5,5,5	0.54	0
6	TLA	A	309	-	9,9,9	0.98	0	12,12,12	1.73	4 (33%)
4	GOL	A	303	-	5,5,5	0.35	0	5,5,5	0.24	0
5	EDO	A	308	-	3,3,3	0.46	0	2,2,2	0.37	0
7	PGE	B	304	-	9,9,9	0.31	0	8,8,8	0.47	0
4	GOL	A	306	-	5,5,5	0.42	0	5,5,5	0.33	0

In the following table, the Chirals column lists the number of chiral outliers, the number of chiral centers analysed, the number of these observed in the model and the number defined in the

Chemical Component Dictionary. Similar counts are reported in the Torsion and Rings columns. '-' means no outliers of that kind were identified.

Mol	Type	Chain	Res	Link	Chirals	Torsions	Rings
4	GOL	A	305	-	-	4/4/4/4	-
6	TLA	A	310	-	-	12/12/12/12	-
6	TLA	D	101	-	-	4/12/12/12	-
7	PGE	B	303	-	-	5/7/7/7	-
4	GOL	A	304	-	-	0/4/4/4	-
4	GOL	A	307	-	-	4/4/4/4	-
6	TLA	A	309	-	-	12/12/12/12	-
4	GOL	A	303	-	-	2/4/4/4	-
5	EDO	A	308	-	-	0/1/1/1	-
7	PGE	B	304	-	-	4/7/7/7	-
4	GOL	A	306	-	-	3/4/4/4	-

There are no bond length outliers.

All (9) bond angle outliers are listed below:

Mol	Chain	Res	Type	Atoms	Z	Observed(°)	Ideal(°)
6	A	309	TLA	O41-C4-C3	3.19	121.89	113.27
6	D	101	TLA	O41-C4-C3	2.72	120.63	113.27
6	A	309	TLA	O41-C4-O4	-2.58	118.22	124.09
6	A	309	TLA	O11-C1-C2	2.56	120.20	113.27
6	A	310	TLA	C2-C3-C4	2.52	115.49	109.87
6	A	309	TLA	C3-C2-C1	-2.43	104.45	109.87
6	A	310	TLA	O11-C1-C2	2.42	119.81	113.27
6	A	310	TLA	O11-C1-O1	-2.10	119.32	124.09
6	A	310	TLA	O41-C4-C3	2.10	118.94	113.27

There are no chirality outliers.

All (50) torsion outliers are listed below:

Mol	Chain	Res	Type	Atoms
4	A	303	GOL	O1-C1-C2-O2
4	A	303	GOL	O1-C1-C2-C3
4	A	305	GOL	C1-C2-C3-O3
4	A	306	GOL	O1-C1-C2-O2
4	A	306	GOL	O1-C1-C2-C3
4	A	307	GOL	O1-C1-C2-C3
6	A	309	TLA	C1-C2-C3-C4

Continued on next page...

Continued from previous page...

Mol	Chain	Res	Type	Atoms
6	A	309	TLA	O2-C2-C3-O3
6	A	310	TLA	C1-C2-C3-C4
6	A	310	TLA	O3-C3-C4-O4
6	A	310	TLA	O3-C3-C4-O41
6	D	101	TLA	O3-C3-C4-O41
6	A	310	TLA	O2-C2-C3-O3
6	A	309	TLA	C1-C2-C3-O3
6	A	309	TLA	O2-C2-C3-C4
6	A	310	TLA	O1-C1-C2-O2
6	A	310	TLA	O11-C1-C2-O2
6	D	101	TLA	O3-C3-C4-O4
6	A	309	TLA	C2-C3-C4-O4
6	A	309	TLA	C2-C3-C4-O41
6	A	310	TLA	C2-C3-C4-O41
6	D	101	TLA	C2-C3-C4-O4
6	D	101	TLA	C2-C3-C4-O41
6	A	310	TLA	C1-C2-C3-O3
6	A	309	TLA	O3-C3-C4-O4
6	A	309	TLA	O3-C3-C4-O41
6	A	310	TLA	C2-C3-C4-O4
7	B	304	PGE	C3-C4-O3-C5
6	A	309	TLA	O1-C1-C2-O2
6	A	310	TLA	O2-C2-C3-C4
4	A	305	GOL	O1-C1-C2-C3
6	A	309	TLA	O11-C1-C2-O2
4	A	305	GOL	O2-C2-C3-O3
4	A	307	GOL	O1-C1-C2-O2
7	B	303	PGE	O2-C3-C4-O3
6	A	310	TLA	O1-C1-C2-C3
6	A	310	TLA	O11-C1-C2-C3
7	B	303	PGE	C6-C5-O3-C4
7	B	304	PGE	C4-C3-O2-C2
4	A	306	GOL	O2-C2-C3-O3
6	A	309	TLA	O1-C1-C2-C3
7	B	303	PGE	O1-C1-C2-O2
7	B	304	PGE	O3-C5-C6-O4
7	B	303	PGE	C4-C3-O2-C2
6	A	309	TLA	O11-C1-C2-C3
4	A	307	GOL	O2-C2-C3-O3
7	B	303	PGE	C1-C2-O2-C3
4	A	307	GOL	C1-C2-C3-O3
4	A	305	GOL	O1-C1-C2-O2

Continued on next page...

Continued from previous page...

Mol	Chain	Res	Type	Atoms
7	B	304	PGE	O2-C3-C4-O3

There are no ring outliers.

6 monomers are involved in 8 short contacts:

Mol	Chain	Res	Type	Clashes	Symm-Clashes
7	B	303	PGE	1	0
4	A	304	GOL	1	0
4	A	307	GOL	1	0
6	A	309	TLA	2	0
4	A	303	GOL	2	0
7	B	304	PGE	1	0

5.7 Other polymers [i](#)

There are no such residues in this entry.

5.8 Polymer linkage issues [i](#)

There are no chain breaks in this entry.

6 Fit of model and data [i](#)

6.1 Protein, DNA and RNA chains [i](#)

In the following table, the column labelled ‘#RSRZ > 2’ contains the number (and percentage) of RSRZ outliers, followed by percent RSRZ outliers for the chain as percentile scores relative to all X-ray entries and entries of similar resolution. The OWAB column contains the minimum, median, 95th percentile and maximum values of the occupancy-weighted average B-factor per residue. The column labelled ‘Q < 0.9’ lists the number of (and percentage) of residues with an average occupancy less than 0.9.

Mol	Chain	Analysed	<RSRZ>	#RSRZ>2	OWAB(Å ²)	Q<0.9
1	A	244/246 (99%)	0.28	9 (3%) 41 48	29, 44, 75, 105	1 (0%)
1	B	246/246 (100%)	0.77	31 (12%) 3 5	32, 54, 94, 107	1 (0%)
2	C	14/23 (60%)	-0.63	0 100 100	46, 55, 80, 83	0
2	D	14/23 (60%)	-0.59	1 (7%) 16 20	46, 59, 86, 111	0
All	All	518/538 (96%)	0.47	41 (7%) 12 16	29, 50, 91, 111	2 (0%)

All (41) RSRZ outliers are listed below:

Mol	Chain	Res	Type	RSRZ
1	B	6	ALA	8.8
1	B	61	VAL	6.5
1	B	164	GLU	5.7
1	B	58	GLY	5.2
1	B	177	GLN	5.2
1	B	175	LEU	4.9
1	B	60	SER	4.9
1	B	178	ALA	4.7
1	B	179	GLY	4.6
1	B	168	LEU	4.4
1	B	7	GLU	3.9
1	B	187	GLY	3.8
1	A	61	VAL	3.3
1	B	174	VAL	3.3
1	A	248	ARG	3.2
1	B	176	LEU	3.2
1	B	159	GLN	3.2
1	B	59	ASP	3.0
1	B	16	LEU	2.9
1	B	188	SER	2.9
1	B	186	ILE	2.8

Continued on next page...

Continued from previous page...

Mol	Chain	Res	Type	RSRZ
1	A	122	VAL	2.7
1	B	167	ALA	2.7
1	A	188	SER	2.7
1	B	169	HIS	2.6
1	B	161	ASP	2.6
1	B	190	GLY	2.6
1	B	181	ASP	2.5
1	A	250	THR	2.5
1	B	148	LEU	2.5
1	B	248	ARG	2.5
1	B	8	ARG	2.4
1	B	122	VAL	2.4
1	B	189	SER	2.4
1	A	214[A]	ARG	2.3
1	A	62	ARG	2.3
1	B	173	ILE	2.3
2	D	9	C	2.2
1	A	159	GLN	2.2
1	A	146	THR	2.1
1	B	62	ARG	2.0

6.2 Non-standard residues in protein, DNA, RNA chains [i](#)

There are no non-standard protein/DNA/RNA residues in this entry.

6.3 Carbohydrates [i](#)

There are no monosaccharides in this entry.

6.4 Ligands [i](#)

In the following table, the Atoms column lists the number of modelled atoms in the group and the number defined in the chemical component dictionary. The B-factors column lists the minimum, median, 95th percentile and maximum values of B factors of atoms in the group. The column labelled 'Q<0.9' lists the number of atoms with occupancy less than 0.9.

Mol	Type	Chain	Res	Atoms	RSCC	RSR	B-factors(Å ²)	Q<0.9
4	GOL	A	306	6/6	0.61	0.36	63,69,72,72	0
4	GOL	A	303	6/6	0.69	0.28	67,68,71,76	0
6	TLA	A	310	10/10	0.75	0.22	60,71,73,75	0

Continued on next page...

Continued from previous page...

Mol	Type	Chain	Res	Atoms	RSCC	RSR	B-factors(\AA^2)	Q<0.9
4	GOL	A	307	6/6	0.80	0.19	61,63,64,67	0
6	TLA	A	309	10/10	0.82	0.35	34,43,46,47	10
6	TLA	D	101	10/10	0.83	0.21	63,69,71,72	0
7	PGE	B	303	10/10	0.83	0.23	63,66,71,72	0
5	EDO	A	308	4/4	0.84	0.27	65,66,67,69	0
4	GOL	A	304	6/6	0.85	0.17	58,62,64,67	0
4	GOL	A	305	6/6	0.86	0.32	56,64,64,65	0
7	PGE	B	304	10/10	0.93	0.15	68,70,73,73	0
3	CA	B	301	1/1	0.95	0.08	52,52,52,52	1
3	CA	B	302	1/1	0.97	0.10	50,50,50,50	1
3	CA	A	302	1/1	0.97	0.06	45,45,45,45	1
3	CA	A	301	1/1	0.97	0.05	58,58,58,58	0

The following is a graphical depiction of the model fit to experimental electron density of all instances of the Ligand of Interest. In addition, ligands with molecular weight > 250 and outliers as shown on the geometry validation Tables will also be included. Each fit is shown from different orientation to approximate a three-dimensional view.

Electron density around CA B 301:

$2mF_o-DF_c$ (at 0.7 rmsd) in gray
 mF_o-DF_c (at 3 rmsd) in purple (negative)
and green (positive)

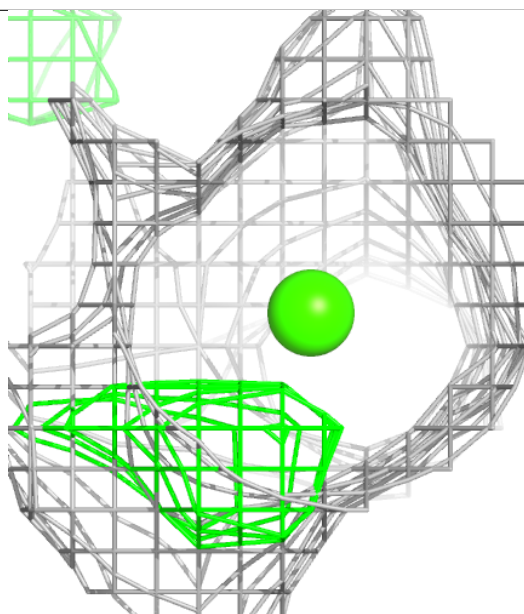
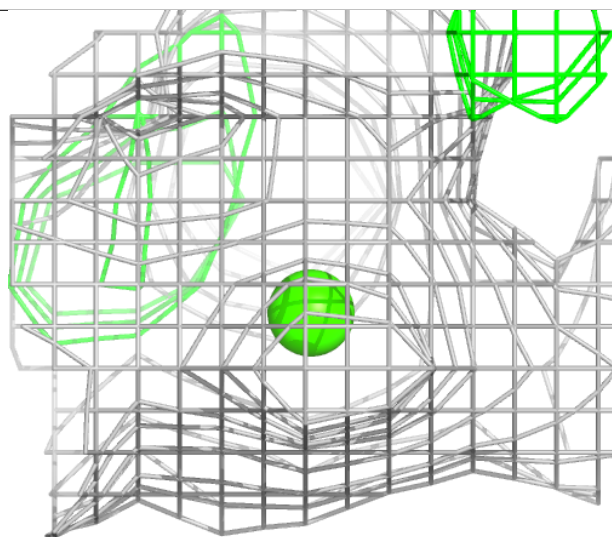
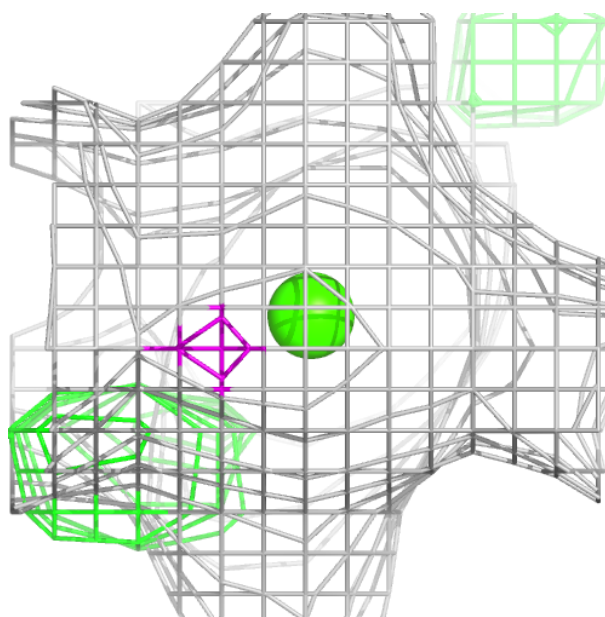

Electron density around CA B 302:

$2mF_o-DF_c$ (at 0.7 rmsd) in gray
 mF_o-DF_c (at 3 rmsd) in purple (negative)
and green (positive)

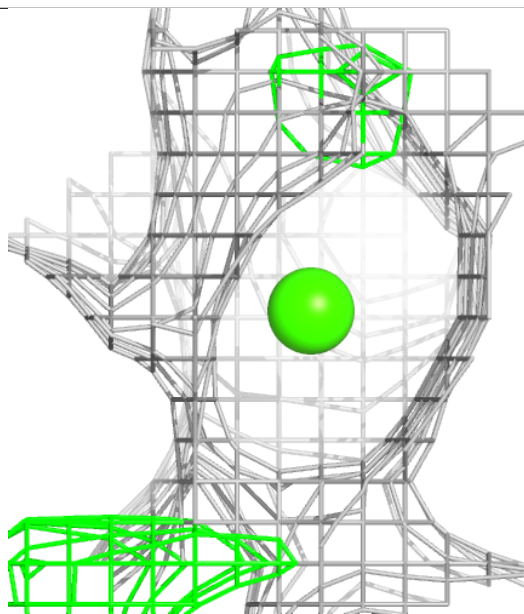
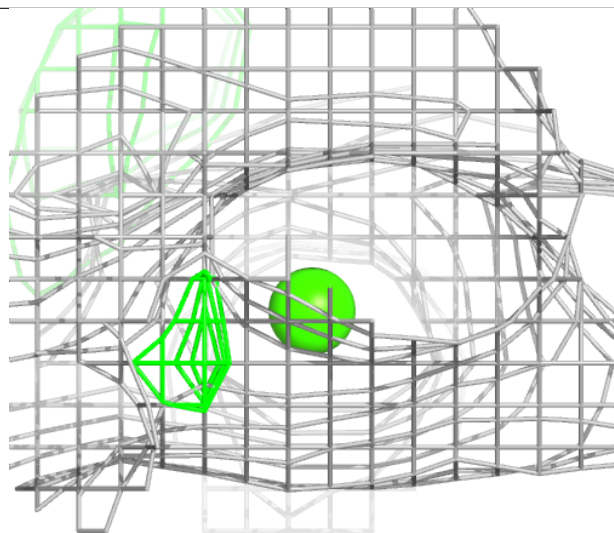
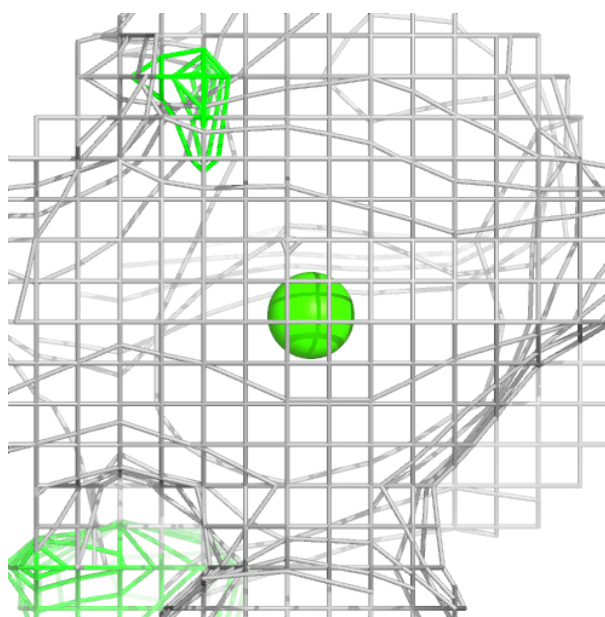

Electron density around CA A 302:

$2mF_o-DF_c$ (at 0.7 rmsd) in gray
 mF_o-DF_c (at 3 rmsd) in purple (negative)
and green (positive)

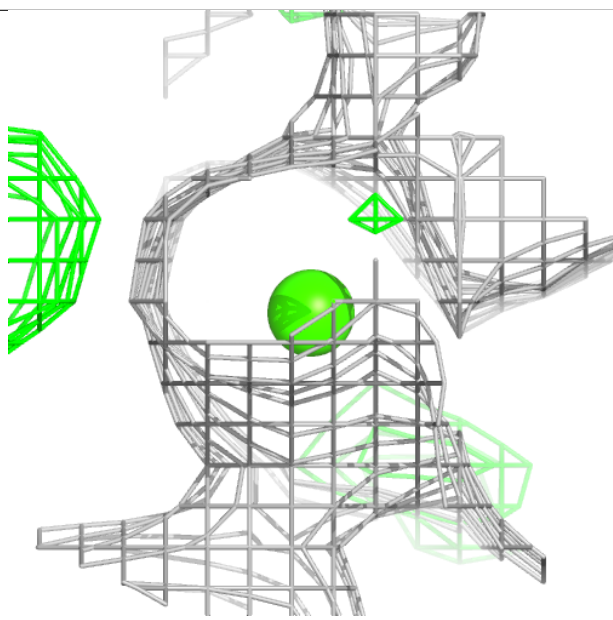
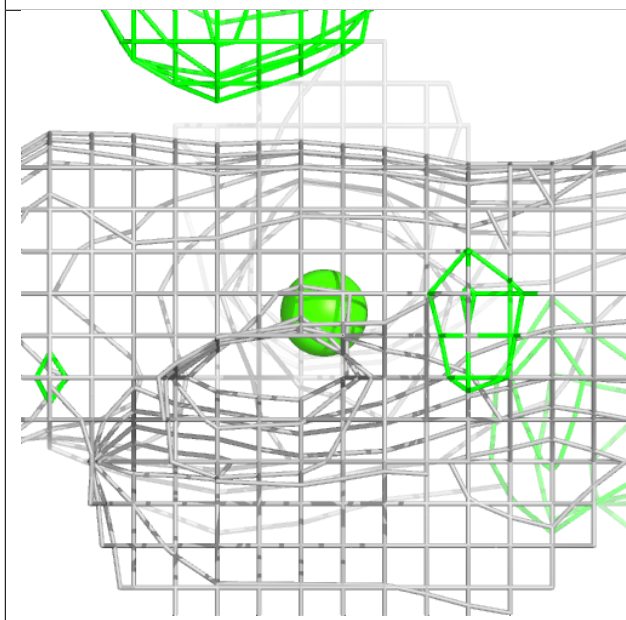
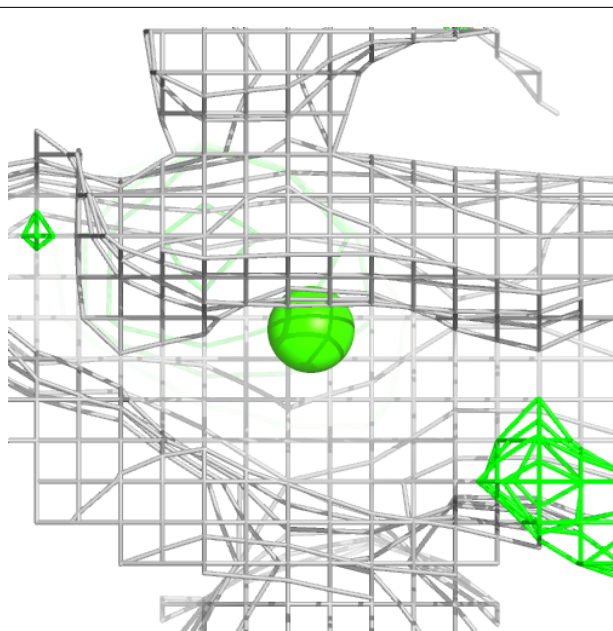

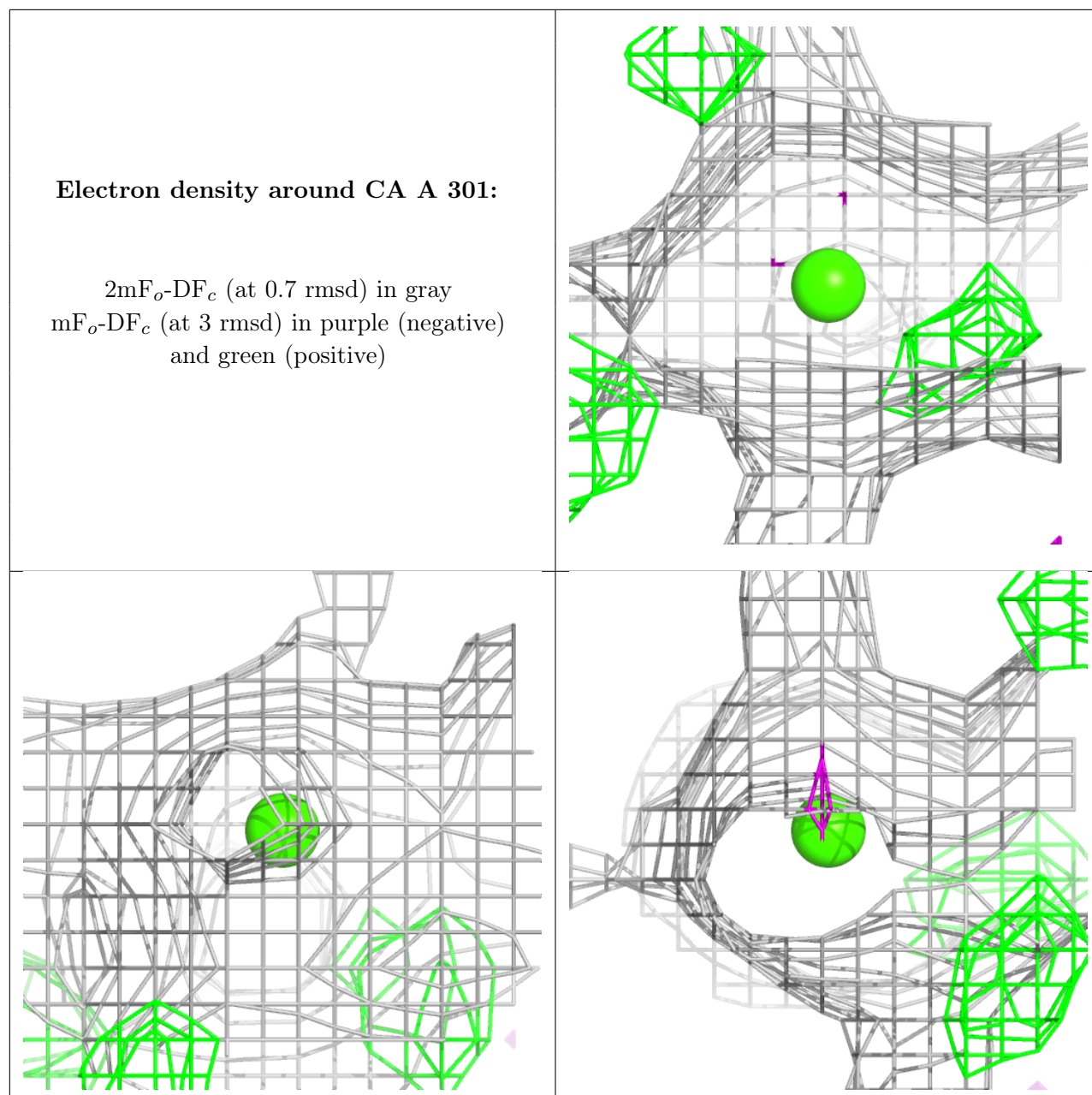

6.5 Other polymers [i](#)

There are no such residues in this entry.