



Full wwPDB X-ray Structure Validation Report ⓘ

Apr 28, 2024 – 01:34 am BST

PDB ID : 4B2Y
Title : Probing the active center of catalase-phenol oxidase from *Scytalidium thermophilum*
Authors : Yuzugullu, Y.; Trinh, C.H.; Pearson, A.R.; Ogel, Z.B.; McPherson, M.J.
Deposited on : 2012-07-19
Resolution : 1.90 Å(reported)

This is a Full wwPDB X-ray Structure Validation Report for a publicly released PDB entry.

We welcome your comments at validation@mail.wwpdb.org

A user guide is available at

<https://www.wwpdb.org/validation/2017/XrayValidationReportHelp>

with specific help available everywhere you see the ⓘ symbol.

The types of validation reports are described at

<http://www.wwpdb.org/validation/2017/FAQs#types>.

The following versions of software and data (see [references ⓘ](#)) were used in the production of this report:

MolProbity : 4.02b-467
Mogul : 1.8.4, CSD as541be (2020)
Xtriage (Phenix) : 1.13
EDS : 2.36.2
buster-report : 1.1.7 (2018)
Percentile statistics : 20191225.v01 (using entries in the PDB archive December 25th 2019)
Refmac : 5.8.0158
CCP4 : 7.0.044 (Gargrove)
Ideal geometry (proteins) : Engh & Huber (2001)
Ideal geometry (DNA, RNA) : Parkinson et al. (1996)
Validation Pipeline (wwPDB-VP) : 2.36.2

1 Overall quality at a glance

The following experimental techniques were used to determine the structure:

X-RAY DIFFRACTION

The reported resolution of this entry is 1.90 Å.

Percentile scores (ranging between 0-100) for global validation metrics of the entry are shown in the following graphic. The table shows the number of entries on which the scores are based.

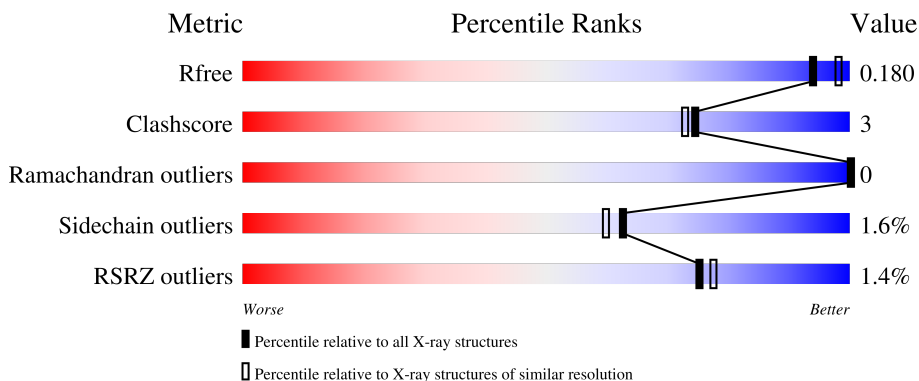

Metric	Whole archive (#Entries)	Similar resolution (#Entries, resolution range(Å))
R_{free}	130704	6207 (1.90-1.90)
Clashscore	141614	6847 (1.90-1.90)
Ramachandran outliers	138981	6760 (1.90-1.90)
Sidechain outliers	138945	6760 (1.90-1.90)
RSRZ outliers	127900	6082 (1.90-1.90)

The table below summarises the geometric issues observed across the polymeric chains and their fit to the electron density. The red, orange, yellow and green segments of the lower bar indicate the fraction of residues that contain outliers for ≥ 3 , 2, 1 and 0 types of geometric quality criteria respectively. A grey segment represents the fraction of residues that are not modelled. The numeric value for each fraction is indicated below the corresponding segment, with a dot representing fractions $\leq 5\%$. The upper red bar (where present) indicates the fraction of residues that have poor fit to the electron density. The numeric value is given above the bar.

Mol	Chain	Length	Quality of chain
1	A	719	 88% 5% 6%
1	B	719	 88% 5% 6%
1	C	719	 87% 6% 7%
1	D	719	 86% 7% 7%

2 Entry composition [i](#)

There are 4 unique types of molecules in this entry. The entry contains 23665 atoms, of which 0 are hydrogens and 0 are deuteriums.

In the tables below, the ZeroOcc column contains the number of atoms modelled with zero occupancy, the AltConf column contains the number of residues with at least one atom in alternate conformation and the Trace column contains the number of residues modelled with at most 2 atoms.

- Molecule 1 is a protein called CATALASE-PHENOL OXIDASE.

Mol	Chain	Residues	Atoms					ZeroOcc	AltConf	Trace
			Total	C	N	O	S			
1	A	675	Total	C	N	O	S	0	31	0
			5452	3451	950	1037	14			
1	B	674	Total	C	N	O	S	0	28	0
			5427	3433	942	1039	13			
1	C	672	Total	C	N	O	S	0	30	0
			5420	3431	941	1033	15			
1	D	672	Total	C	N	O	S	0	23	0
			5384	3407	940	1024	13			

- Molecule 2 is PROTOPORPHYRIN IX CONTAINING FE (three-letter code: HEM) (formula: $C_{34}H_{32}FeN_4O_4$).

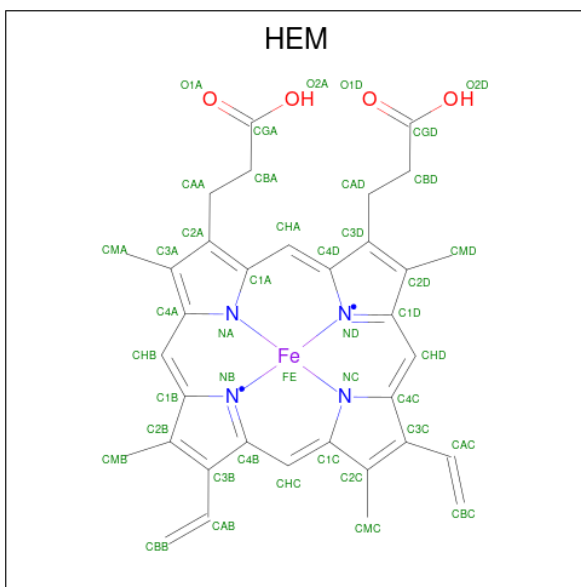

Mol	Chain	Residues	Atoms				ZeroOcc	AltConf	
			Total	C	Fe	N			O
2	A	1	Total	C	Fe	N	O	0	0
			43	34	1	4	4		
2	B	1	Total	C	Fe	N	O	0	0
			43	34	1	4	4		

Continued on next page...

Continued from previous page...

Mol	Chain	Residues	Atoms				ZeroOcc	AltConf	
2	C	1	Total	C	Fe	N	O	0	0
			43	34	1	4	4		
2	D	1	Total	C	Fe	N	O	0	0
			43	34	1	4	4		

- Molecule 3 is CALCIUM ION (three-letter code: CA) (formula: Ca).

Mol	Chain	Residues	Atoms		ZeroOcc	AltConf
3	A	2	Total	Ca	0	0
			2	2		
3	B	1	Total	Ca	0	0
			1	1		
3	C	2	Total	Ca	0	0
			2	2		
3	D	1	Total	Ca	0	0
			1	1		

- Molecule 4 is water.

Mol	Chain	Residues	Atoms		ZeroOcc	AltConf
4	A	585	Total	O	0	0
			585	585		
4	B	515	Total	O	0	0
			515	515		
4	C	370	Total	O	0	0
			370	370		
4	D	334	Total	O	0	0
			334	334		

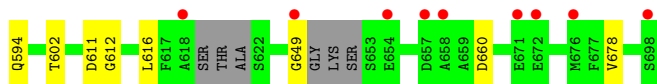

● Molecule 1: CATALASE-PHENOL OXIDASE

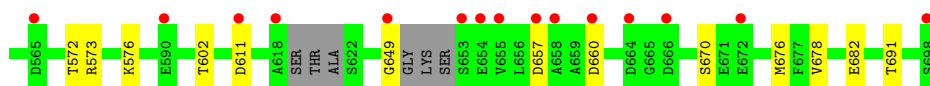
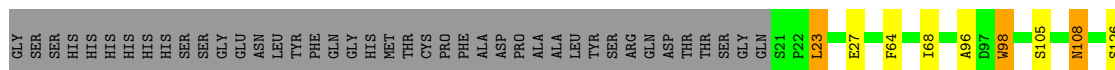
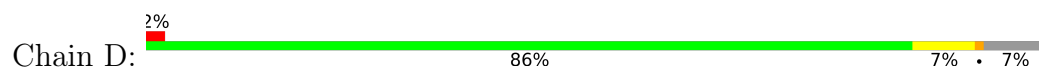

4 Data and refinement statistics

Property	Value	Source
Space group	C 1 2 1	Depositor
Cell constants a, b, c, α , β , γ	201.32Å 121.20Å 124.97Å 90.00° 115.54° 90.00°	Depositor
Resolution (Å)	29.01 – 1.90 29.01 – 1.90	Depositor EDS
% Data completeness (in resolution range)	98.4 (29.01-1.90) 98.4 (29.01-1.90)	Depositor EDS
R_{merge}	0.09	Depositor
R_{sym}	(Not available)	Depositor
$\langle I/\sigma(I) \rangle$ ¹	2.81 (at 1.91Å)	Xtrriage
Refinement program	REFMAC 5.6.0117	Depositor
R, R_{free}	0.150 , 0.181 0.152 , 0.180	Depositor DCC
R_{free} test set	10347 reflections (4.95%)	wwPDB-VP
Wilson B-factor (Å ²)	16.5	Xtrriage
Anisotropy	0.246	Xtrriage
Bulk solvent k_{sol} (e/Å ³), B_{sol} (Å ²)	0.40 , 51.4	EDS
L-test for twinning ²	$\langle L \rangle = 0.48$, $\langle L^2 \rangle = 0.31$	Xtrriage
Estimated twinning fraction	No twinning to report.	Xtrriage
F_o, F_c correlation	0.96	EDS
Total number of atoms	23665	wwPDB-VP
Average B, all atoms (Å ²)	17.0	wwPDB-VP

Xtrriage's analysis on translational NCS is as follows: *The analyses of the Patterson function reveals a significant off-origin peak that is 36.45 % of the origin peak, indicating pseudo-translational symmetry. The chance of finding a peak of this or larger height randomly in a structure without pseudo-translational symmetry is equal to 4.9887e-04. The detected translational NCS is most likely also responsible for the elevated intensity ratio.*

¹Intensities estimated from amplitudes.

²Theoretical values of $\langle |L| \rangle$, $\langle L^2 \rangle$ for acentric reflections are 0.5, 0.333 respectively for untwinned datasets, and 0.375, 0.2 for perfectly twinned datasets.

5 Model quality i

5.1 Standard geometry i

Bond lengths and bond angles in the following residue types are not validated in this section: CA, HEM

The Z score for a bond length (or angle) is the number of standard deviations the observed value is removed from the expected value. A bond length (or angle) with $|Z| > 5$ is considered an outlier worth inspection. RMSZ is the root-mean-square of all Z scores of the bond lengths (or angles).

Mol	Chain	Bond lengths		Bond angles	
		RMSZ	# Z >5	RMSZ	# Z >5
1	A	0.70	2/5670 (0.0%)	0.70	1/7698 (0.0%)
1	B	0.68	4/5636 (0.1%)	0.70	3/7655 (0.0%)
1	C	0.69	4/5637 (0.1%)	0.70	2/7655 (0.0%)
1	D	0.67	1/5583 (0.0%)	0.70	1/7583 (0.0%)
All	All	0.68	11/22526 (0.0%)	0.70	7/30591 (0.0%)

All (11) bond length outliers are listed below:

Mol	Chain	Res	Type	Atoms	Z	Observed(Å)	Ideal(Å)
1	B	245	TRP	CD2-CE2	5.88	1.48	1.41
1	B	623	SER	C-N	5.85	1.45	1.34
1	C	288	TRP	CD2-CE2	5.75	1.48	1.41
1	C	589[A]	ARG	CZ-NH2	5.71	1.40	1.33
1	C	589[B]	ARG	CZ-NH2	5.71	1.40	1.33
1	A	194	TRP	CD2-CE2	5.65	1.48	1.41
1	A	245	TRP	CD2-CE2	5.59	1.48	1.41
1	B	98	TRP	CD2-CE2	5.37	1.47	1.41
1	D	98	TRP	CD2-CE2	5.29	1.47	1.41
1	B	284	ASN	C-N	-5.25	1.23	1.33
1	C	209	TRP	CD2-CE2	5.08	1.47	1.41

All (7) bond angle outliers are listed below:

Mol	Chain	Res	Type	Atoms	Z	Observed(°)	Ideal(°)
1	C	29	ASP	CB-CG-OD1	5.75	123.48	118.30
1	B	589[A]	ARG	NE-CZ-NH2	-5.44	117.58	120.30
1	B	589[B]	ARG	NE-CZ-NH2	-5.44	117.58	120.30
1	B	45	ASP	CB-CG-OD1	5.41	123.17	118.30
1	C	23	LEU	CA-CB-CG	5.26	127.40	115.30
1	A	237	ASP	CB-CG-OD1	5.04	122.84	118.30

Continued on next page...

Continued from previous page...

Mol	Chain	Res	Type	Atoms	Z	Observed(°)	Ideal(°)
1	D	237	ASP	CB-CG-OD1	5.03	122.83	118.30

There are no chirality outliers.

There are no planarity outliers.

5.2 Too-close contacts [i](#)

In the following table, the Non-H and H(model) columns list the number of non-hydrogen atoms and hydrogen atoms in the chain respectively. The H(added) column lists the number of hydrogen atoms added and optimized by MolProbity. The Clashes column lists the number of clashes within the asymmetric unit, whereas Symm-Clashes lists symmetry-related clashes.

Mol	Chain	Non-H	H(model)	H(added)	Clashes	Symm-Clashes
1	A	5452	0	5288	36	0
1	B	5427	0	5238	32	0
1	C	5420	0	5246	37	0
1	D	5384	0	5203	41	0
2	A	43	0	30	1	0
2	B	43	0	30	0	0
2	C	43	0	30	2	0
2	D	43	0	30	0	0
3	A	2	0	0	0	0
3	B	1	0	0	0	0
3	C	2	0	0	0	0
3	D	1	0	0	0	0
4	A	585	0	0	13	0
4	B	515	0	0	7	0
4	C	370	0	0	3	0
4	D	334	0	0	2	0
All	All	23665	0	21095	138	0

The all-atom clashscore is defined as the number of clashes found per 1000 atoms (including hydrogen atoms). The all-atom clashscore for this structure is 3.

All (138) close contacts within the same asymmetric unit are listed below, sorted by their clash magnitude.

Atom-1	Atom-2	Interatomic distance (Å)	Clash overlap (Å)
1:B:127[A]:ARG:NH2	4:B:2142:HOH:O	1.81	0.98
1:D:313:ILE:H	1:D:461:GLN:HE22	1.12	0.95
1:A:373[A]:GLN:HE21	1:A:373[A]:GLN:HA	1.33	0.94

Continued on next page...

Continued from previous page...

Atom-1	Atom-2	Interatomic distance (Å)	Clash overlap (Å)
1:A:313:ILE:H	1:A:461:GLN:HE22	1.22	0.88
1:B:313:ILE:H	1:B:461:GLN:HE22	1.21	0.87
1:A:389[A]:MET:HE3	4:A:2004:HOH:O	1.73	0.86
1:D:373[A]:GLN:HE21	1:D:373[A]:GLN:HA	1.40	0.86
1:C:313:ILE:H	1:C:461:GLN:HE22	1.24	0.85
1:B:264:LEU:HG	1:B:602:THR:HB	1.59	0.85
1:A:389[A]:MET:CE	4:A:2004:HOH:O	2.26	0.81
4:A:2098:HOH:O	1:C:127[B]:ARG:NH2	1.81	0.81
1:B:369:TYR:O	1:B:373[A]:GLN:HG2	1.81	0.80
1:D:369:TYR:O	1:D:373[A]:GLN:HG2	1.80	0.80
1:C:301:GLN:HE22	1:C:454:THR:HG21	1.48	0.79
1:B:569[B]:GLN:HE21	1:B:569[B]:GLN:HA	1.46	0.79
1:C:573[A]:ARG:HG2	1:C:678:VAL:HG21	1.66	0.78
1:B:127[A]:ARG:NH1	4:B:2142:HOH:O	2.12	0.77
1:B:425[A]:ARG:CZ	4:B:2378:HOH:O	2.33	0.77
1:B:373[A]:GLN:HE21	1:B:373[A]:GLN:HA	1.50	0.76
1:D:264:LEU:HG	1:D:602:THR:HB	1.65	0.76
1:C:566:GLN:HE22	1:C:612:GLY:H	1.30	0.75
1:A:264:LEU:HG	1:A:602:THR:HB	1.69	0.74
1:A:425[A]:ARG:CZ	4:A:2433:HOH:O	2.36	0.72
1:B:127[B]:ARG:NH1	4:B:2142:HOH:O	2.22	0.71
4:A:2098:HOH:O	1:C:127[B]:ARG:NH1	2.21	0.71
1:C:373[A]:GLN:HA	1:C:373[A]:GLN:HE21	1.54	0.71
1:C:264:LEU:HG	1:C:602:THR:HB	1.72	0.71
1:A:369:TYR:O	1:A:373[A]:GLN:HG2	1.90	0.70
1:C:369:TYR:O	1:C:373[A]:GLN:HG2	1.92	0.69
1:D:126:SER:H	1:D:185:GLN:HE22	1.39	0.68
4:A:2098:HOH:O	1:C:127[B]:ARG:CZ	2.30	0.67
1:D:126:SER:H	1:D:185:GLN:NE2	1.95	0.64
1:A:425[A]:ARG:NH2	4:A:2433:HOH:O	2.31	0.63
1:A:373[A]:GLN:HE21	1:A:373[A]:GLN:CA	2.02	0.63
1:B:108:ASN:C	1:B:108:ASN:HD22	2.00	0.63
1:A:373[A]:GLN:HA	1:A:373[A]:GLN:NE2	2.12	0.61
1:D:573[A]:ARG:HG2	1:D:678:VAL:HG21	1.81	0.61
1:D:573[A]:ARG:HG2	1:D:678:VAL:HG11	1.83	0.61
1:B:469:LEU:HB3	1:B:473:GLU:HB3	1.83	0.60
1:D:508:VAL:O	1:D:512:VAL:HG13	2.00	0.60
1:A:241:LYS:NZ	1:A:296:ASP:OD1	2.35	0.59
2:C:754:HEM:HMC2	2:C:754:HEM:HBC2	1.83	0.58
1:C:582:THR:HG21	1:C:594:GLN:HE21	1.69	0.58
1:D:313:ILE:N	1:D:461:GLN:HE22	1.94	0.58

Continued on next page...

Continued from previous page...

Atom-1	Atom-2	Interatomic distance (Å)	Clash overlap (Å)
1:C:301:GLN:NE2	1:C:454:THR:HG21	2.16	0.58
1:D:108:ASN:HD22	1:D:108:ASN:C	2.08	0.57
1:B:127[A]:ARG:CZ	4:B:2142:HOH:O	2.26	0.57
1:A:472:VAL:HG11	1:A:691:THR:HB	1.87	0.57
1:A:344:MET:HB3	1:A:373[B]:GLN:HG2	1.86	0.56
1:D:23:LEU:HD23	1:D:23:LEU:N	2.21	0.55
1:B:26:TYR:OH	1:B:389[A]:MET:SD	2.58	0.55
1:C:566:GLN:NE2	1:C:612:GLY:H	2.04	0.55
1:C:469:LEU:HB3	1:C:473:GLU:HB3	1.88	0.54
1:B:558:THR:HG22	1:B:589[A]:ARG:HD2	1.90	0.54
1:C:277[A]:TRP:CZ3	1:C:332:ASN:HB3	2.42	0.54
1:D:611:ASP:HB2	1:D:649:GLY:HA3	1.90	0.53
1:B:569[B]:GLN:HA	1:B:569[B]:GLN:NE2	2.21	0.53
1:B:582:THR:HG21	1:B:594:GLN:HE21	1.74	0.53
1:D:678:VAL:O	1:D:682:GLU:HG3	2.07	0.53
1:D:277[A]:TRP:CZ3	1:D:333:PRO:HD2	2.44	0.53
1:A:108:ASN:C	1:A:108:ASN:HD22	2.13	0.53
1:A:469:LEU:HB3	1:A:473:GLU:HB3	1.91	0.52
1:B:181:ASN:HB3	1:D:277[A]:TRP:CE3	2.45	0.52
1:A:373[A]:GLN:CA	1:A:373[A]:GLN:NE2	2.71	0.52
1:C:313:ILE:N	1:C:461:GLN:HE22	2.02	0.52
1:D:373[A]:GLN:HE21	1:D:373[A]:GLN:CA	2.12	0.51
1:C:373[A]:GLN:HA	1:C:373[A]:GLN:NE2	2.23	0.51
1:A:676[B]:MET:HA	1:A:676[B]:MET:CE	2.41	0.50
4:A:2202:HOH:O	1:B:492[B]:GLU:HG2	2.10	0.50
1:C:301:GLN:HE22	1:C:454:THR:CG2	2.19	0.50
1:A:594[A]:GLN:HG3	1:A:598:THR:OG1	2.13	0.49
1:D:373[A]:GLN:HA	1:D:373[A]:GLN:NE2	2.18	0.49
1:D:525:ASP:HA	1:D:528:TYR:CD2	2.48	0.49
1:A:492[B]:GLU:HG2	4:A:2486:HOH:O	2.13	0.49
1:A:277[A]:TRP:CZ3	1:A:333:PRO:HD2	2.48	0.49
1:C:108:ASN:C	1:C:108:ASN:HD22	2.15	0.49
1:A:425[B]:ARG:HD2	4:A:2438:HOH:O	2.12	0.48
1:A:181:ASN:HB3	1:C:277[A]:TRP:CE3	2.47	0.48
1:B:373[A]:GLN:HA	1:B:373[A]:GLN:NE2	2.25	0.48
1:A:26:TYR:OH	1:A:389[B]:MET:SD	2.70	0.48
1:D:472:VAL:HG11	1:D:691:THR:HB	1.96	0.47
1:B:246[A]:HIS:CD2	1:B:248:LYS:HG2	2.50	0.47
1:A:331:ARG:HD3	4:A:2339:HOH:O	2.15	0.46
1:B:373[A]:GLN:HE21	1:B:373[A]:GLN:CA	2.15	0.46
1:D:105:SER:CB	1:D:147[A]:GLU:HG3	2.46	0.46

Continued on next page...

Continued from previous page...

Atom-1	Atom-2	Interatomic distance (Å)	Clash overlap (Å)
1:A:389[A]:MET:HE2	4:A:2004:HOH:O	2.04	0.46
1:D:244:LYS:HB2	1:D:246[B]:HIS:HE1	1.80	0.46
1:B:253:LYS:HG2	4:B:2222:HOH:O	2.15	0.46
1:A:181:ASN:HB3	1:C:277[A]:TRP:CZ3	2.51	0.46
1:B:132:THR:HG21	1:B:264:LEU:HD13	1.98	0.46
1:D:132:THR:HG21	1:D:264:LEU:HD13	1.97	0.46
1:D:373[A]:GLN:CA	1:D:373[A]:GLN:NE2	2.79	0.46
1:C:344:MET:HG2	1:C:373[A]:GLN:NE2	2.31	0.46
1:A:301[A]:GLN:NE2	1:A:454:THR:HG21	2.31	0.45
1:A:277[A]:TRP:CZ3	1:C:181:ASN:HB3	2.52	0.45
1:B:577:ASP:OD2	1:B:682:GLU:OE2	2.33	0.45
1:C:372:THR:HG21	2:C:754:HEM:HBD1	1.99	0.45
1:D:346:GLN:HE21	1:D:373[B]:GLN:HE22	1.64	0.45
1:D:573[A]:ARG:CG	1:D:678:VAL:HG11	2.45	0.45
1:B:492[A]:GLU:HG2	4:B:2427:HOH:O	2.17	0.44
1:C:611:ASP:HB2	1:C:649:GLY:HA3	2.00	0.44
1:D:277[A]:TRP:CZ3	1:D:332:ASN:HB3	2.53	0.44
1:B:116:VAL:HG21	1:B:327:LEU:HD11	1.99	0.44
1:C:224:ASP:OD2	1:C:246[A]:HIS:HE1	2.01	0.43
1:B:108:ASN:C	1:B:108:ASN:ND2	2.67	0.43
1:B:472:VAL:HG11	1:B:691:THR:HB	2.01	0.43
1:C:243:ILE:HA	1:C:293:GLN:O	2.18	0.43
1:D:313:ILE:H	1:D:461:GLN:NE2	1.96	0.43
1:D:64:PHE:CZ	1:D:68:ILE:HG13	2.54	0.43
1:D:376:ARG:NH1	4:D:2202:HOH:O	2.37	0.43
1:A:155:ASN:CG	2:A:754:HEM:HMB2	2.38	0.43
1:A:277[A]:TRP:CE3	1:C:181:ASN:HB3	2.53	0.43
1:C:23:LEU:N	1:C:23:LEU:HD23	2.33	0.43
1:C:425[A]:ARG:HD2	4:C:2265:HOH:O	2.19	0.43
1:C:572:THR:HG23	4:C:2332:HOH:O	2.19	0.43
1:C:419:LEU:HD11	1:D:191:ASP:HB3	2.00	0.43
1:D:277[A]:TRP:CH2	1:D:332:ASN:HB3	2.53	0.43
1:D:373[B]:GLN:NE2	4:D:2203:HOH:O	2.51	0.43
1:A:277[A]:TRP:CZ3	1:A:332:ASN:HB3	2.53	0.43
1:D:108:ASN:C	1:D:108:ASN:ND2	2.72	0.43
1:D:469:LEU:HB3	1:D:473:GLU:HB3	2.00	0.43
1:A:409[B]:ARG:HE	1:D:27:GLU:HB3	1.84	0.43
1:B:277[A]:TRP:CE3	1:D:181:ASN:HB3	2.54	0.43
1:B:277[A]:TRP:CZ3	1:B:332:ASN:HB3	2.54	0.43
1:C:572:THR:O	1:C:576:LYS:HG2	2.18	0.43
1:C:246[A]:HIS:CE1	1:C:248:LYS:HG2	2.54	0.42

Continued on next page...

Continued from previous page...

Atom-1	Atom-2	Interatomic distance (Å)	Clash overlap (Å)
1:B:246[B]:HIS:CE1	1:B:293:GLN:OE1	2.73	0.42
1:A:565[B]:ASP:OD2	1:A:569:GLN:NE2	2.53	0.42
1:C:492[B]:GLU:CG	4:C:2306:HOH:O	2.68	0.42
1:B:181:ASN:HB3	1:D:277[A]:TRP:CD2	2.56	0.41
1:A:277[A]:TRP:CH2	1:A:332:ASN:HB3	2.55	0.41
1:D:129:SER:HB3	1:D:185:GLN:HE21	1.86	0.41
1:D:246[B]:HIS:CE1	1:D:293:GLN:OE1	2.73	0.41
1:C:525:ASP:HA	1:C:528:TYR:CD2	2.56	0.41
1:A:376:ARG:NH1	4:A:2348:HOH:O	2.41	0.40
1:D:96:ALA:HB3	1:D:98:TRP:CE2	2.56	0.40

There are no symmetry-related clashes.

5.3 Torsion angles [i](#)

5.3.1 Protein backbone [i](#)

In the following table, the Percentiles column shows the percent Ramachandran outliers of the chain as a percentile score with respect to all X-ray entries followed by that with respect to entries of similar resolution.

The Analysed column shows the number of residues for which the backbone conformation was analysed, and the total number of residues.

Mol	Chain	Analysed	Favoured	Allowed	Outliers	Percentiles	
1	A	702/719 (98%)	689 (98%)	13 (2%)	0	100	100
1	B	698/719 (97%)	682 (98%)	16 (2%)	0	100	100
1	C	696/719 (97%)	681 (98%)	15 (2%)	0	100	100
1	D	689/719 (96%)	674 (98%)	15 (2%)	0	100	100
All	All	2785/2876 (97%)	2726 (98%)	59 (2%)	0	100	100

There are no Ramachandran outliers to report.

5.3.2 Protein sidechains [i](#)

In the following table, the Percentiles column shows the percent sidechain outliers of the chain as a percentile score with respect to all X-ray entries followed by that with respect to entries of similar resolution.

The Analysed column shows the number of residues for which the sidechain conformation was analysed, and the total number of residues.

Mol	Chain	Analysed	Rotameric	Outliers	Percentiles	
1	A	590/596 (99%)	583 (99%)	7 (1%)	71	70
1	B	586/596 (98%)	578 (99%)	8 (1%)	67	65
1	C	587/596 (98%)	577 (98%)	10 (2%)	60	57
1	D	580/596 (97%)	565 (97%)	15 (3%)	46	39
All	All	2343/2384 (98%)	2303 (98%)	40 (2%)	62	57

All (40) residues with a non-rotameric sidechain are listed below:

Mol	Chain	Res	Type
1	A	108	ASN
1	A	139	PHE
1	A	191	ASP
1	A	275	ASP
1	A	373[A]	GLN
1	A	373[B]	GLN
1	A	660	ASP
1	B	108	ASN
1	B	139	PHE
1	B	145	THR
1	B	191	ASP
1	B	264	LEU
1	B	373[A]	GLN
1	B	373[B]	GLN
1	B	660	ASP
1	C	23	LEU
1	C	70	HIS
1	C	108	ASN
1	C	139	PHE
1	C	191	ASP
1	C	246[A]	HIS
1	C	246[B]	HIS
1	C	373[A]	GLN
1	C	373[B]	GLN
1	C	660	ASP
1	D	23	LEU
1	D	108	ASN
1	D	139	PHE
1	D	191	ASP
1	D	275	ASP

Continued on next page...

Continued from previous page...

Mol	Chain	Res	Type
1	D	373[A]	GLN
1	D	373[B]	GLN
1	D	521	PRO
1	D	561	SER
1	D	572	THR
1	D	576	LYS
1	D	657	ASP
1	D	660	ASP
1	D	670	SER
1	D	676	MET

Sometimes sidechains can be flipped to improve hydrogen bonding and reduce clashes. All (22) such sidechains are listed below:

Mol	Chain	Res	Type
1	A	82	HIS
1	A	108	ASN
1	A	167	GLN
1	A	461	GLN
1	B	82	HIS
1	B	108	ASN
1	B	301	GLN
1	B	461	GLN
1	B	594	GLN
1	C	82	HIS
1	C	108	ASN
1	C	167	GLN
1	C	301	GLN
1	C	461	GLN
1	C	566	GLN
1	C	594	GLN
1	D	82	HIS
1	D	108	ASN
1	D	167	GLN
1	D	185	GLN
1	D	301	GLN
1	D	461	GLN

5.3.3 RNA

There are no RNA molecules in this entry.

5.4 Non-standard residues in protein, DNA, RNA chains [i](#)

There are no non-standard protein/DNA/RNA residues in this entry.

5.5 Carbohydrates [i](#)

There are no monosaccharides in this entry.

5.6 Ligand geometry [i](#)

Of 10 ligands modelled in this entry, 6 are monoatomic - leaving 4 for Mogul analysis.

In the following table, the Counts columns list the number of bonds (or angles) for which Mogul statistics could be retrieved, the number of bonds (or angles) that are observed in the model and the number of bonds (or angles) that are defined in the Chemical Component Dictionary. The Link column lists molecule types, if any, to which the group is linked. The Z score for a bond length (or angle) is the number of standard deviations the observed value is removed from the expected value. A bond length (or angle) with $|Z| > 2$ is considered an outlier worth inspection. RMSZ is the root-mean-square of all Z scores of the bond lengths (or angles).

Mol	Type	Chain	Res	Link	Bond lengths			Bond angles		
					Counts	RMSZ	# Z > 2	Counts	RMSZ	# Z > 2
2	HEM	D	754	1	41,50,50	2.38	15 (36%)	45,82,82	2.86	20 (44%)
2	HEM	C	754	1,4	41,50,50	2.40	15 (36%)	45,82,82	2.95	19 (42%)
2	HEM	B	754	1,4	41,50,50	2.31	14 (34%)	45,82,82	2.98	20 (44%)
2	HEM	A	754	1	41,50,50	2.32	15 (36%)	45,82,82	2.97	18 (40%)

In the following table, the Chirals column lists the number of chiral outliers, the number of chiral centers analysed, the number of these observed in the model and the number defined in the Chemical Component Dictionary. Similar counts are reported in the Torsion and Rings columns. '-' means no outliers of that kind were identified.

Mol	Type	Chain	Res	Link	Chirals	Torsions	Rings
2	HEM	D	754	1	-	4/12/54/54	-
2	HEM	C	754	1,4	-	4/12/54/54	-
2	HEM	B	754	1,4	-	2/12/54/54	-
2	HEM	A	754	1	-	2/12/54/54	-

All (59) bond length outliers are listed below:

Mol	Chain	Res	Type	Atoms	Z	Observed(Å)	Ideal(Å)
2	C	754	HEM	C3C-C2C	5.51	1.48	1.40

Continued on next page...

Continued from previous page...

Mol	Chain	Res	Type	Atoms	Z	Observed(Å)	Ideal(Å)
2	A	754	HEM	C3D-C2D	4.99	1.47	1.36
2	D	754	HEM	C3C-C2C	4.98	1.47	1.40
2	D	754	HEM	C1A-NA	4.79	1.46	1.36
2	A	754	HEM	C3C-C2C	4.75	1.47	1.40
2	B	754	HEM	C3D-C2D	4.70	1.46	1.36
2	C	754	HEM	C3D-C2D	4.64	1.46	1.36
2	B	754	HEM	C3B-C2B	4.53	1.46	1.37
2	D	754	HEM	C3B-C2B	4.50	1.46	1.37
2	B	754	HEM	C3C-C2C	4.49	1.46	1.40
2	C	754	HEM	C3B-C2B	4.49	1.46	1.37
2	B	754	HEM	CHA-C4D	4.44	1.46	1.35
2	C	754	HEM	C4A-NA	4.40	1.45	1.36
2	D	754	HEM	CHB-C1B	4.38	1.46	1.35
2	D	754	HEM	C4A-NA	4.30	1.45	1.36
2	A	754	HEM	CHA-C4D	4.30	1.46	1.35
2	B	754	HEM	C4A-NA	4.21	1.44	1.36
2	A	754	HEM	C1A-NA	4.17	1.44	1.36
2	C	754	HEM	CHA-C4D	4.11	1.45	1.35
2	D	754	HEM	C3D-C2D	4.06	1.45	1.36
2	D	754	HEM	CHA-C4D	4.05	1.45	1.35
2	C	754	HEM	CHB-C1B	4.01	1.45	1.35
2	A	754	HEM	C3B-C2B	3.96	1.45	1.37
2	B	754	HEM	C1A-NA	3.96	1.44	1.36
2	A	754	HEM	CHB-C1B	3.93	1.45	1.35
2	C	754	HEM	C1A-NA	3.80	1.44	1.36
2	B	754	HEM	CHB-C1B	3.77	1.44	1.35
2	C	754	HEM	C4D-ND	-3.75	1.33	1.40
2	A	754	HEM	C4A-NA	3.75	1.43	1.36
2	C	754	HEM	C2A-C3A	3.71	1.48	1.37
2	B	754	HEM	C4D-ND	-3.69	1.33	1.40
2	C	754	HEM	C2C-C1C	3.62	1.50	1.42
2	D	754	HEM	C4D-ND	-3.44	1.34	1.40
2	B	754	HEM	C2A-C3A	3.32	1.47	1.37
2	D	754	HEM	C2C-C1C	3.29	1.50	1.42
2	A	754	HEM	C4D-ND	-3.27	1.34	1.40
2	A	754	HEM	C1B-NB	-3.26	1.34	1.40
2	D	754	HEM	C2A-C3A	3.07	1.46	1.37
2	A	754	HEM	C2C-C1C	3.01	1.49	1.42
2	A	754	HEM	C2A-C3A	3.00	1.46	1.37
2	A	754	HEM	FE-NB	2.96	2.11	1.96
2	B	754	HEM	C1B-NB	-2.86	1.35	1.40
2	D	754	HEM	FE-NB	2.84	2.10	1.96

Continued on next page...

Continued from previous page...

Mol	Chain	Res	Type	Atoms	Z	Observed(Å)	Ideal(Å)
2	D	754	HEM	C1B-NB	-2.76	1.35	1.40
2	C	754	HEM	FE-NB	2.75	2.10	1.96
2	D	754	HEM	FE-ND	2.72	2.10	1.96
2	B	754	HEM	FE-NB	2.64	2.09	1.96
2	B	754	HEM	FE-ND	2.55	2.09	1.96
2	A	754	HEM	FE-ND	2.53	2.09	1.96
2	B	754	HEM	C1D-C2D	2.52	1.49	1.44
2	C	754	HEM	FE-ND	2.52	2.09	1.96
2	B	754	HEM	C2C-C1C	2.49	1.48	1.42
2	C	754	HEM	C1B-NB	-2.26	1.36	1.40
2	C	754	HEM	C1A-CHA	2.22	1.47	1.41
2	D	754	HEM	CHD-C1D	2.13	1.47	1.41
2	A	754	HEM	C1B-C2B	2.13	1.48	1.44
2	A	754	HEM	C4A-CHB	2.12	1.46	1.41
2	C	754	HEM	C1D-C2D	2.07	1.48	1.44
2	D	754	HEM	CHC-C4B	2.07	1.47	1.41

All (77) bond angle outliers are listed below:

Mol	Chain	Res	Type	Atoms	Z	Observed(°)	Ideal(°)
2	A	754	HEM	C3B-C2B-C1B	-9.45	99.47	106.49
2	C	754	HEM	C3B-C2B-C1B	-9.44	99.48	106.49
2	D	754	HEM	C3B-C2B-C1B	-9.16	99.69	106.49
2	B	754	HEM	C3B-C2B-C1B	-9.10	99.73	106.49
2	C	754	HEM	C2B-C1B-NB	7.17	118.34	109.84
2	B	754	HEM	C2B-C1B-NB	7.02	118.16	109.84
2	A	754	HEM	C2B-C1B-NB	6.98	118.11	109.84
2	D	754	HEM	CBD-CAD-C3D	-6.65	94.15	112.63
2	D	754	HEM	C2B-C1B-NB	6.37	117.39	109.84
2	A	754	HEM	CBD-CAD-C3D	-6.35	94.98	112.63
2	A	754	HEM	C2D-C1D-ND	6.02	117.09	109.88
2	B	754	HEM	CBD-CAD-C3D	-6.01	95.93	112.63
2	C	754	HEM	CBD-CAD-C3D	-5.75	96.65	112.63
2	C	754	HEM	C2D-C1D-ND	5.62	116.61	109.88
2	C	754	HEM	C1D-C2D-C3D	-5.45	101.22	106.96
2	A	754	HEM	C1D-C2D-C3D	-5.32	101.36	106.96
2	B	754	HEM	C1D-C2D-C3D	-5.31	101.38	106.96
2	B	754	HEM	C3D-C4D-ND	5.30	116.07	110.17
2	C	754	HEM	C3D-C4D-ND	5.28	116.05	110.17
2	D	754	HEM	C2D-C1D-ND	5.19	116.10	109.88
2	B	754	HEM	C2D-C1D-ND	5.08	115.96	109.88
2	A	754	HEM	C3D-C4D-ND	4.99	115.72	110.17

Continued on next page...

Continued from previous page...

Mol	Chain	Res	Type	Atoms	Z	Observed(°)	Ideal(°)
2	B	754	HEM	C4A-C3A-C2A	-4.73	103.70	107.00
2	D	754	HEM	C3D-C4D-ND	4.60	115.29	110.17
2	D	754	HEM	C1D-C2D-C3D	-4.25	102.49	106.96
2	D	754	HEM	CAA-CBA-CGA	-4.18	102.04	113.76
2	A	754	HEM	CHD-C1D-C2D	-4.14	118.52	124.98
2	D	754	HEM	CHD-C1D-C2D	-3.78	119.08	124.98
2	C	754	HEM	CMD-C2D-C1D	3.70	130.67	125.04
2	B	754	HEM	CMD-C2D-C1D	3.30	130.07	125.04
2	C	754	HEM	C1B-NB-C4B	-3.25	101.72	105.07
2	B	754	HEM	CAA-CBA-CGA	-3.21	104.77	113.76
2	B	754	HEM	CHA-C4D-C3D	-3.17	119.38	125.33
2	B	754	HEM	CHD-C1D-C2D	-3.15	120.06	124.98
2	A	754	HEM	C1B-NB-C4B	-3.10	101.87	105.07
2	C	754	HEM	CHD-C1D-C2D	-3.07	120.18	124.98
2	C	754	HEM	CHA-C4D-C3D	-3.07	119.56	125.33
2	B	754	HEM	CHC-C4B-C3B	-3.07	119.87	124.57
2	C	754	HEM	C4A-C3A-C2A	-3.03	104.89	107.00
2	A	754	HEM	CAA-CBA-CGA	-2.97	105.43	113.76
2	C	754	HEM	CAA-CBA-CGA	-2.97	105.44	113.76
2	A	754	HEM	CMC-C2C-C3C	2.89	130.09	124.68
2	C	754	HEM	CHB-C1B-C2B	-2.87	118.77	126.72
2	A	754	HEM	CMB-C2B-C1B	2.84	129.36	125.04
2	D	754	HEM	CMC-C2C-C3C	2.81	129.93	124.68
2	D	754	HEM	CHC-C4B-C3B	-2.74	120.38	124.57
2	A	754	HEM	CHC-C4B-C3B	-2.73	120.38	124.57
2	B	754	HEM	CMC-C2C-C3C	2.73	129.78	124.68
2	C	754	HEM	CHC-C4B-C3B	-2.71	120.42	124.57
2	B	754	HEM	C1B-NB-C4B	-2.68	102.30	105.07
2	D	754	HEM	CHA-C4D-C3D	-2.59	120.47	125.33
2	D	754	HEM	C4D-C3D-C2D	-2.58	103.14	106.90
2	B	754	HEM	CHB-C1B-C2B	-2.57	119.61	126.72
2	A	754	HEM	C4D-C3D-C2D	-2.55	103.18	106.90
2	D	754	HEM	CMD-C2D-C1D	2.50	128.85	125.04
2	A	754	HEM	C4D-ND-C1D	-2.48	102.51	105.07
2	C	754	HEM	C4D-ND-C1D	-2.48	102.51	105.07
2	C	754	HEM	CBB-CAB-C3B	-2.45	115.42	127.62
2	D	754	HEM	C4A-C3A-C2A	-2.44	105.30	107.00
2	D	754	HEM	C4D-ND-C1D	-2.40	102.59	105.07
2	D	754	HEM	CHB-C1B-C2B	-2.38	120.13	126.72
2	A	754	HEM	CHA-C4D-C3D	-2.37	120.87	125.33
2	C	754	HEM	C4D-C3D-C2D	-2.36	103.46	106.90
2	A	754	HEM	CHB-C1B-NB	-2.34	121.49	124.38

Continued on next page...

Continued from previous page...

Mol	Chain	Res	Type	Atoms	Z	Observed(°)	Ideal(°)
2	A	754	HEM	CHB-C1B-C2B	-2.33	120.28	126.72
2	B	754	HEM	C4D-C3D-C2D	-2.33	103.51	106.90
2	C	754	HEM	CMB-C2B-C1B	2.28	128.52	125.04
2	C	754	HEM	CMC-C2C-C3C	2.27	128.92	124.68
2	A	754	HEM	C4A-C3A-C2A	-2.24	105.44	107.00
2	D	754	HEM	O1D-CGD-CBD	-2.21	115.99	123.08
2	B	754	HEM	O1A-CGA-CBA	-2.18	116.07	123.08
2	D	754	HEM	CAD-CBD-CGD	-2.12	109.05	113.60
2	D	754	HEM	C1B-NB-C4B	-2.08	102.92	105.07
2	B	754	HEM	C4D-ND-C1D	-2.06	102.94	105.07
2	B	754	HEM	CBB-CAB-C3B	-2.05	117.43	127.62
2	D	754	HEM	CBB-CAB-C3B	-2.04	117.47	127.62
2	B	754	HEM	CMB-C2B-C1B	2.01	128.11	125.04

There are no chirality outliers.

All (12) torsion outliers are listed below:

Mol	Chain	Res	Type	Atoms
2	C	754	HEM	C2B-C3B-CAB-CBB
2	D	754	HEM	C2B-C3B-CAB-CBB
2	C	754	HEM	CAA-CBA-CGA-O2A
2	D	754	HEM	CAA-CBA-CGA-O2A
2	B	754	HEM	CAA-CBA-CGA-O1A
2	A	754	HEM	CAA-CBA-CGA-O2A
2	B	754	HEM	CAA-CBA-CGA-O2A
2	C	754	HEM	CAA-CBA-CGA-O1A
2	A	754	HEM	CAA-CBA-CGA-O1A
2	D	754	HEM	CAA-CBA-CGA-O1A
2	C	754	HEM	C4B-C3B-CAB-CBB
2	D	754	HEM	C4B-C3B-CAB-CBB

There are no ring outliers.

2 monomers are involved in 3 short contacts:

Mol	Chain	Res	Type	Clashes	Symm-Clashes
2	C	754	HEM	2	0
2	A	754	HEM	1	0

The following is a two-dimensional graphical depiction of Mogul quality analysis of bond lengths, bond angles, torsion angles, and ring geometry for all instances of the Ligand of Interest. In addition, ligands with molecular weight > 250 and outliers as shown on the validation Tables will

also be included. For torsion angles, if less than 5% of the Mogul distribution of torsion angles is within 10 degrees of the torsion angle in question, then that torsion angle is considered an outlier. Any bond that is central to one or more torsion angles identified as an outlier by Mogul will be highlighted in the graph. For rings, the root-mean-square deviation (RMSD) between the ring in question and similar rings identified by Mogul is calculated over all ring torsion angles. If the average RMSD is greater than 60 degrees and the minimal RMSD between the ring in question and any Mogul-identified rings is also greater than 60 degrees, then that ring is considered an outlier. The outliers are highlighted in purple. The color gray indicates Mogul did not find sufficient equivalents in the CSD to analyse the geometry.

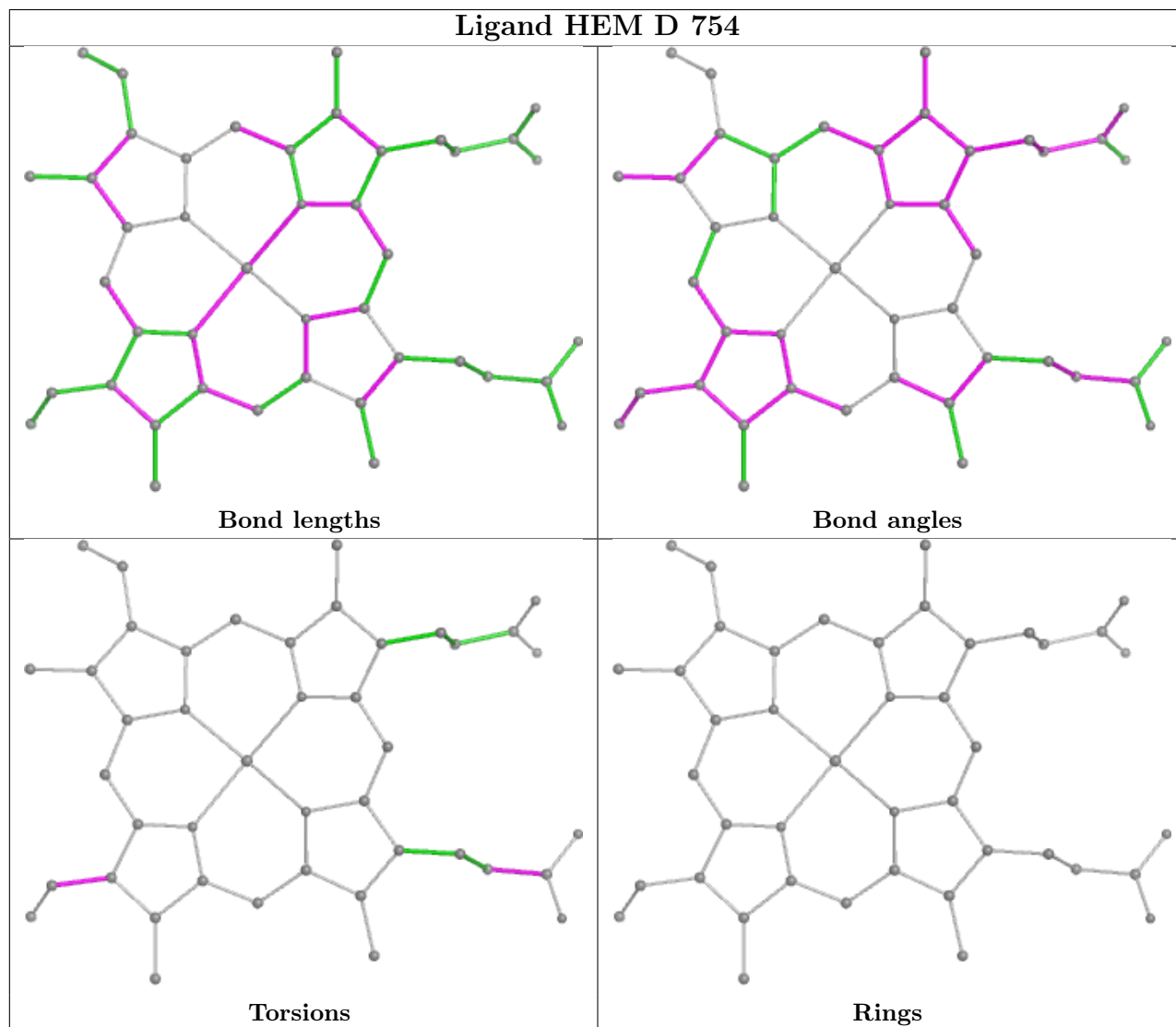

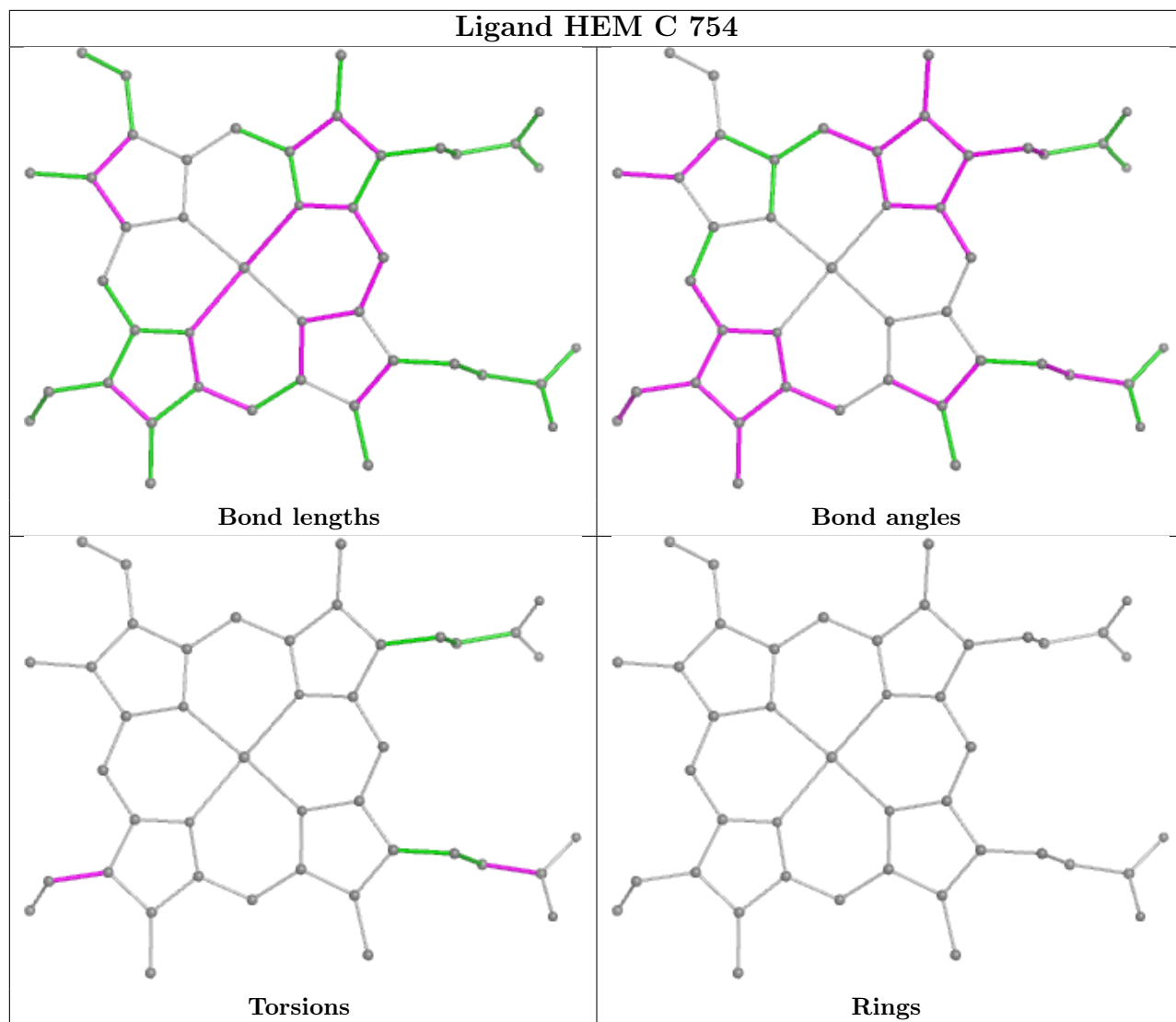

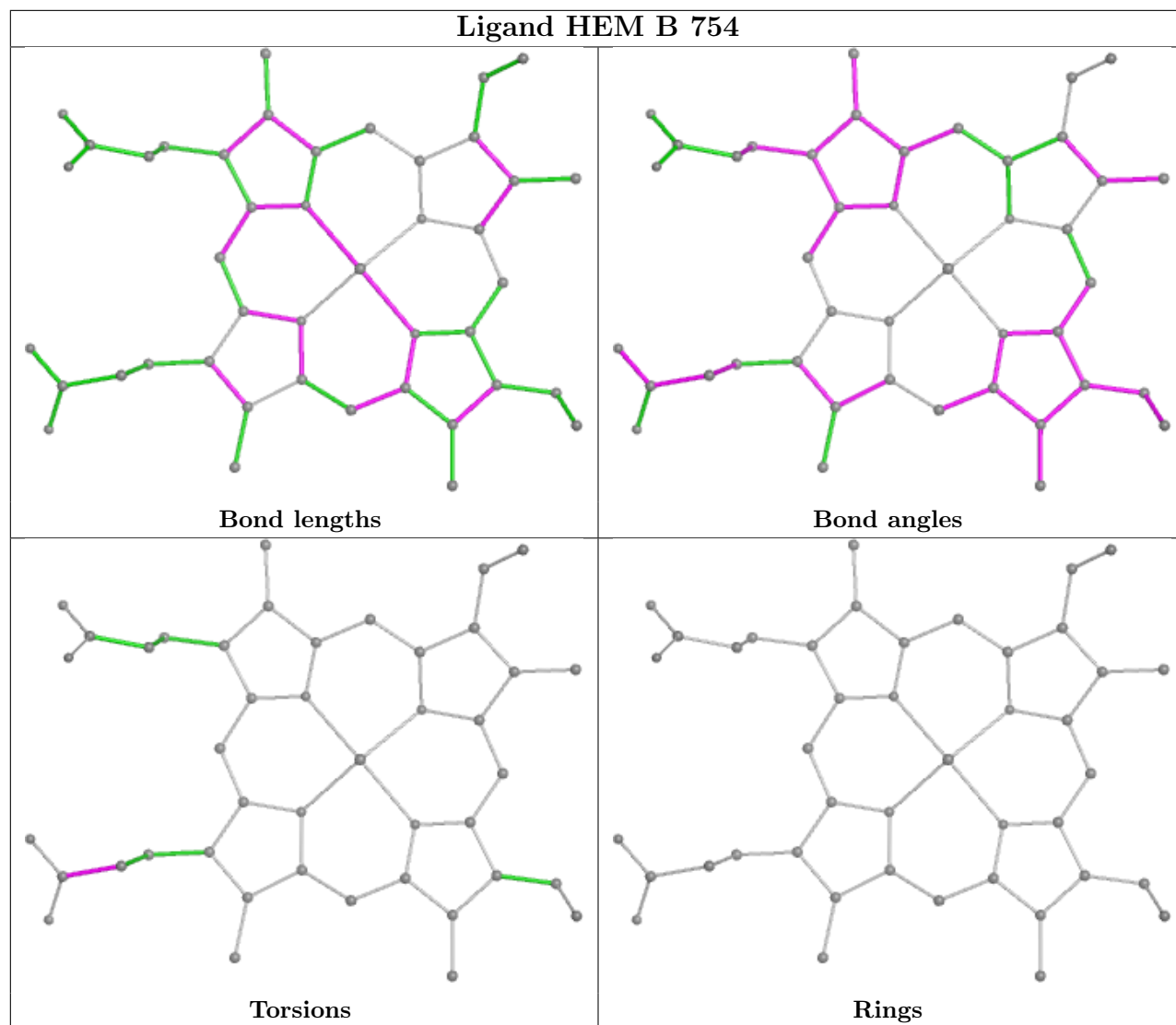

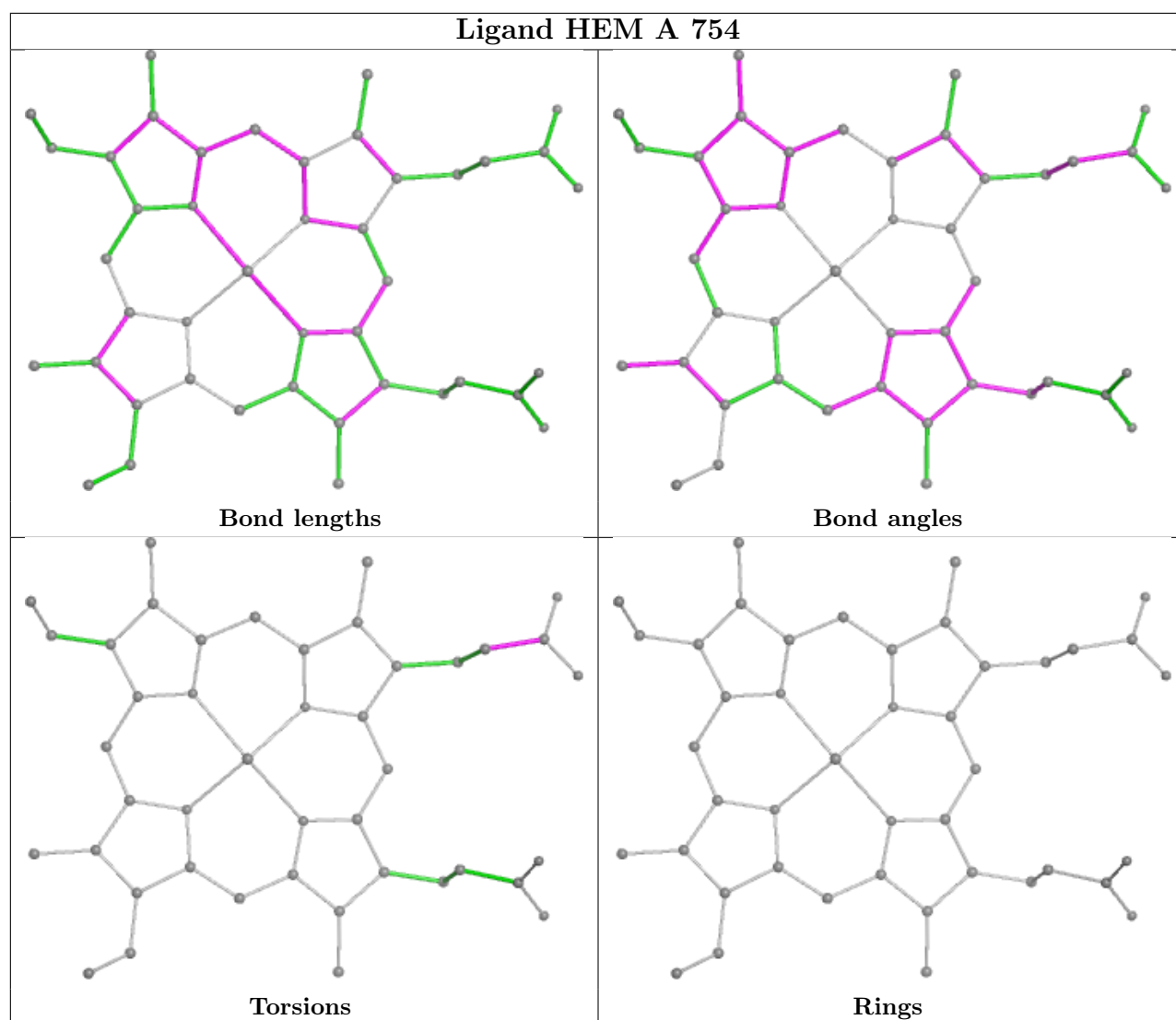

5.7 Other polymers [i](#)

There are no such residues in this entry.

5.8 Polymer linkage issues [i](#)

There are no chain breaks in this entry.

6 Fit of model and data [i](#)

6.1 Protein, DNA and RNA chains [i](#)

In the following table, the column labelled ‘#RSRZ > 2’ contains the number (and percentage) of RSRZ outliers, followed by percent RSRZ outliers for the chain as percentile scores relative to all X-ray entries and entries of similar resolution. The OWAB column contains the minimum, median, 95th percentile and maximum values of the occupancy-weighted average B-factor per residue. The column labelled ‘Q < 0.9’ lists the number of (and percentage) of residues with an average occupancy less than 0.9.

Mol	Chain	Analysed	<RSRZ>	#RSRZ>2	OWAB(Å ²)	Q<0.9
1	A	675/719 (93%)	-0.53	5 (0%) 87 88	9, 15, 26, 41	0
1	B	674/719 (93%)	-0.48	8 (1%) 79 81	9, 16, 28, 45	0
1	C	672/719 (93%)	-0.50	10 (1%) 73 76	9, 15, 33, 60	0
1	D	672/719 (93%)	-0.43	16 (2%) 59 62	9, 16, 37, 66	0
All	All	2693/2876 (93%)	-0.48	39 (1%) 75 77	9, 15, 32, 66	0

All (39) RSRZ outliers are listed below:

Mol	Chain	Res	Type	RSRZ
1	A	618	ALA	5.0
1	B	618	ALA	4.8
1	C	698	SER	4.3
1	C	618	ALA	4.3
1	C	654	GLU	4.0
1	D	672	GLU	3.9
1	D	590	GLU	3.8
1	D	654	GLU	3.7
1	C	649	GLY	3.4
1	D	657	ASP	3.4
1	B	657	ASP	3.1
1	D	660	ASP	2.9
1	A	698	SER	2.9
1	C	672	GLU	2.8
1	D	561	SER	2.8
1	B	517	GLY	2.8
1	D	649	GLY	2.7
1	A	664	ASP	2.6
1	D	698	SER	2.6
1	B	565[A]	ASP	2.6
1	D	653	SER	2.6

Continued on next page...

Continued from previous page...

Mol	Chain	Res	Type	RSRZ
1	D	664	ASP	2.5
1	D	618	ALA	2.5
1	D	611	ASP	2.5
1	C	671	GLU	2.4
1	C	590	GLU	2.4
1	B	576	LYS	2.3
1	A	622	SER	2.3
1	B	698	SER	2.3
1	C	658	ALA	2.3
1	B	664	ASP	2.2
1	D	658	ALA	2.2
1	D	565	ASP	2.1
1	A	565[A]	ASP	2.1
1	D	655	VAL	2.1
1	C	676[A]	MET	2.1
1	C	657	ASP	2.1
1	B	660	ASP	2.0
1	D	666[A]	ASP	2.0

6.2 Non-standard residues in protein, DNA, RNA chains [i](#)

There are no non-standard protein/DNA/RNA residues in this entry.

6.3 Carbohydrates [i](#)

There are no monosaccharides in this entry.

6.4 Ligands [i](#)

In the following table, the Atoms column lists the number of modelled atoms in the group and the number defined in the chemical component dictionary. The B-factors column lists the minimum, median, 95th percentile and maximum values of B factors of atoms in the group. The column labelled 'Q< 0.9' lists the number of atoms with occupancy less than 0.9.

Mol	Type	Chain	Res	Atoms	RSCC	RSR	B-factors(\AA^2)	Q<0.9
3	CA	B	1699	1/1	0.76	0.19	9,9,9,9	1
2	HEM	C	754	43/43	0.97	0.09	10,12,16,21	0
2	HEM	B	754	43/43	0.97	0.08	10,13,15,20	0
2	HEM	D	754	43/43	0.98	0.09	11,12,16,20	0
3	CA	A	1700	1/1	0.98	0.12	22,22,22,22	1

Continued on next page...

Continued from previous page...

Mol	Type	Chain	Res	Atoms	RSCC	RSR	B-factors(\AA^2)	Q<0.9
2	HEM	A	754	43/43	0.98	0.08	10,12,15,20	0
3	CA	C	1699	1/1	0.99	0.04	18,18,18,18	0
3	CA	C	1700	1/1	0.99	0.09	16,16,16,16	1
3	CA	A	1699	1/1	1.00	0.05	21,21,21,21	0
3	CA	D	1699	1/1	1.00	0.10	7,7,7,7	1

The following is a graphical depiction of the model fit to experimental electron density of all instances of the Ligand of Interest. In addition, ligands with molecular weight > 250 and outliers as shown on the geometry validation Tables will also be included. Each fit is shown from different orientation to approximate a three-dimensional view.

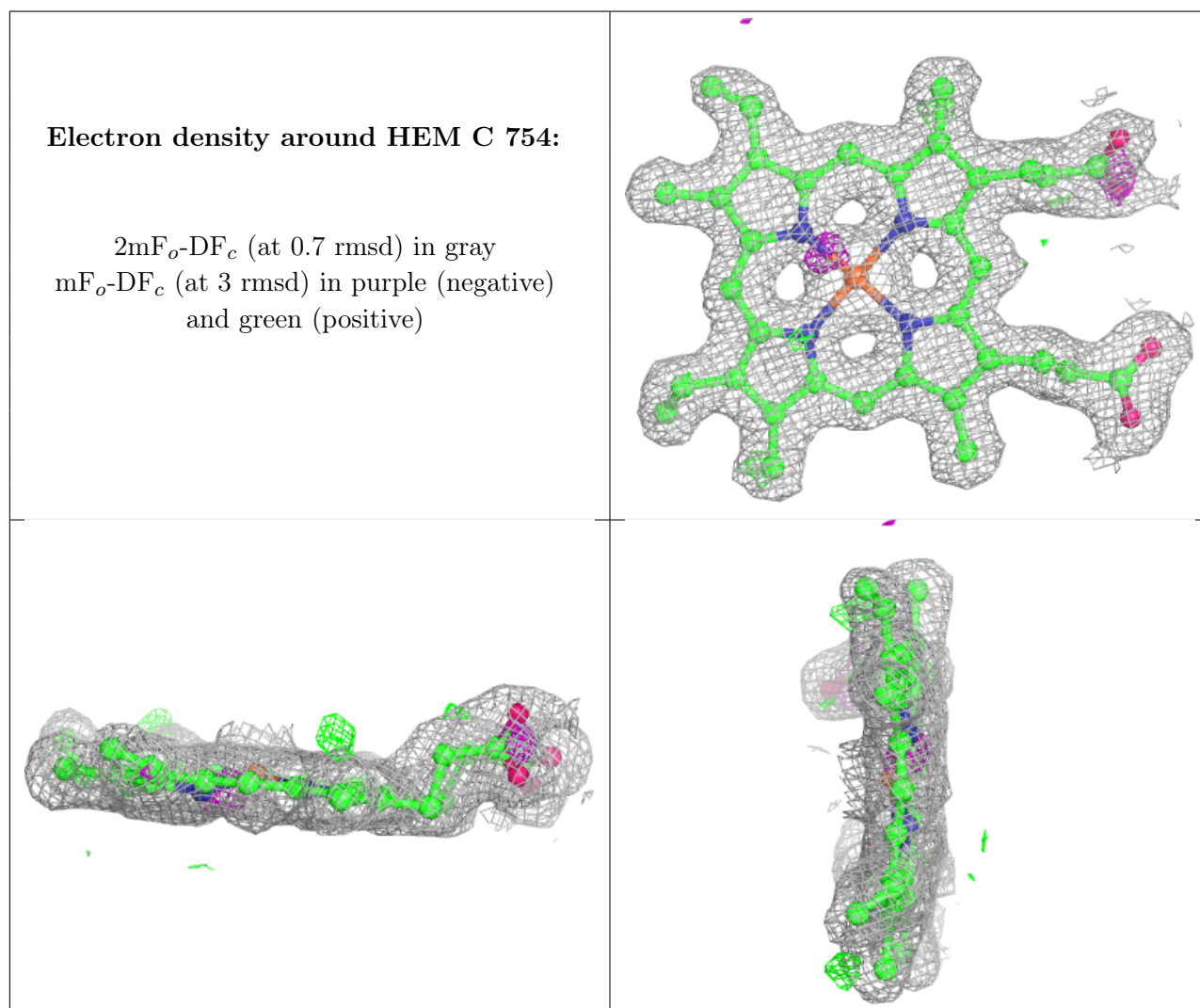

Electron density around HEM B 754:

$2mF_o-DF_c$ (at 0.7 rmsd) in gray
 mF_o-DF_c (at 3 rmsd) in purple (negative)
and green (positive)

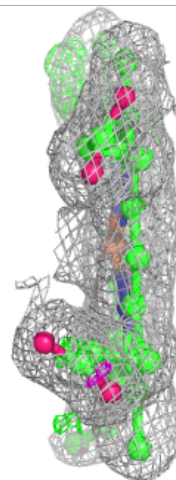
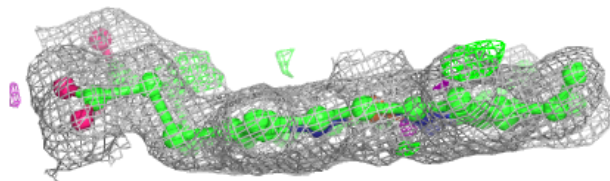
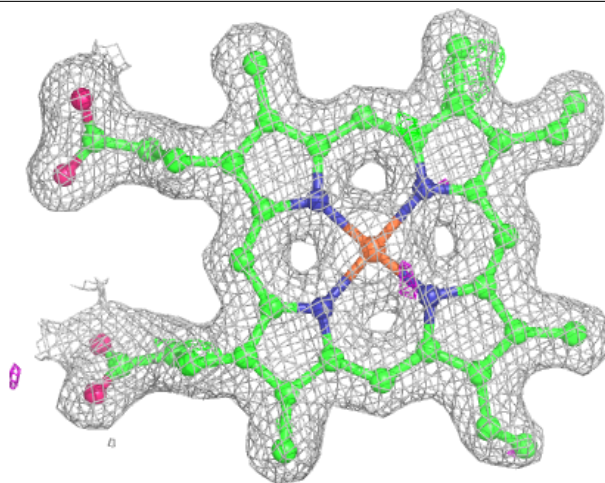

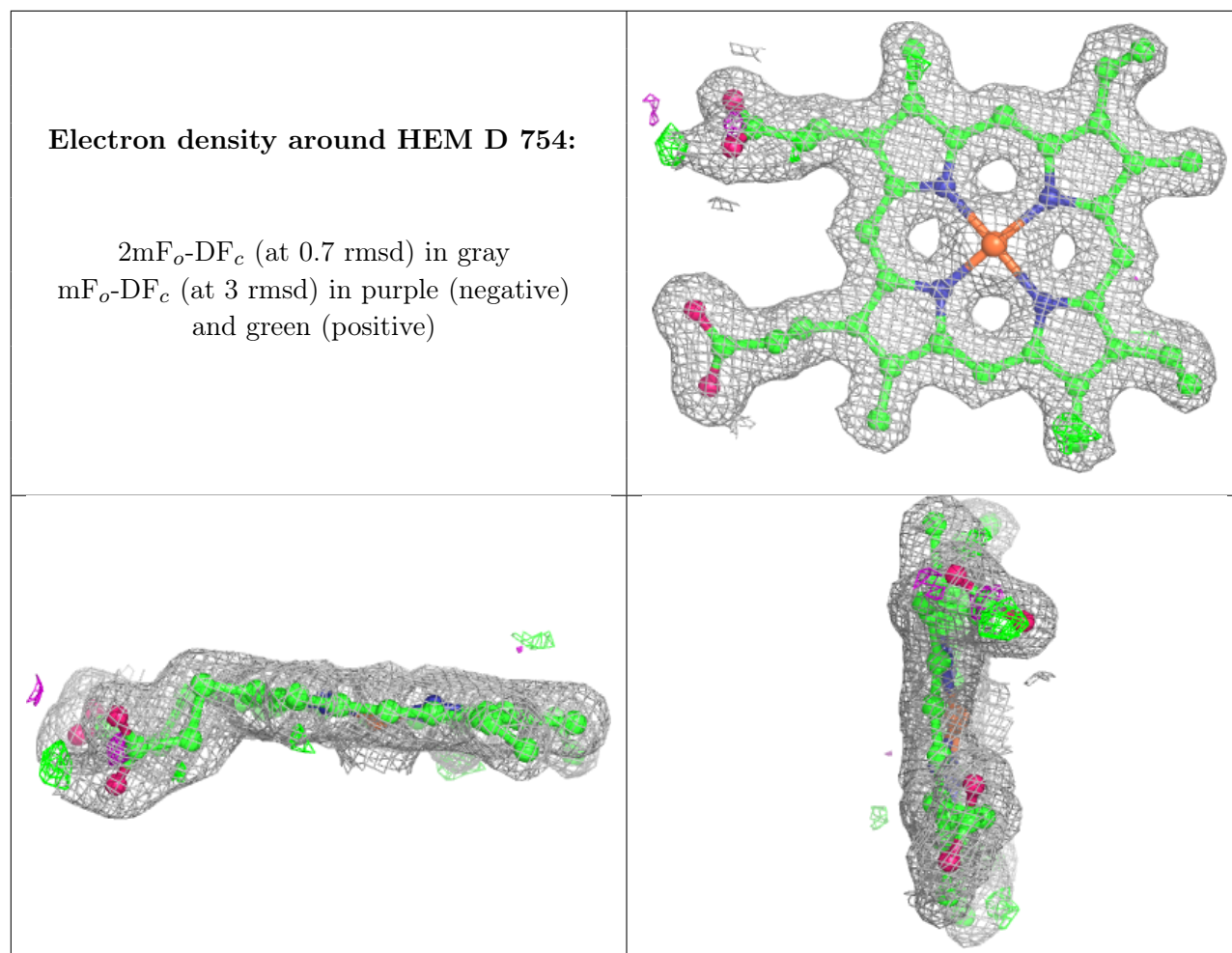

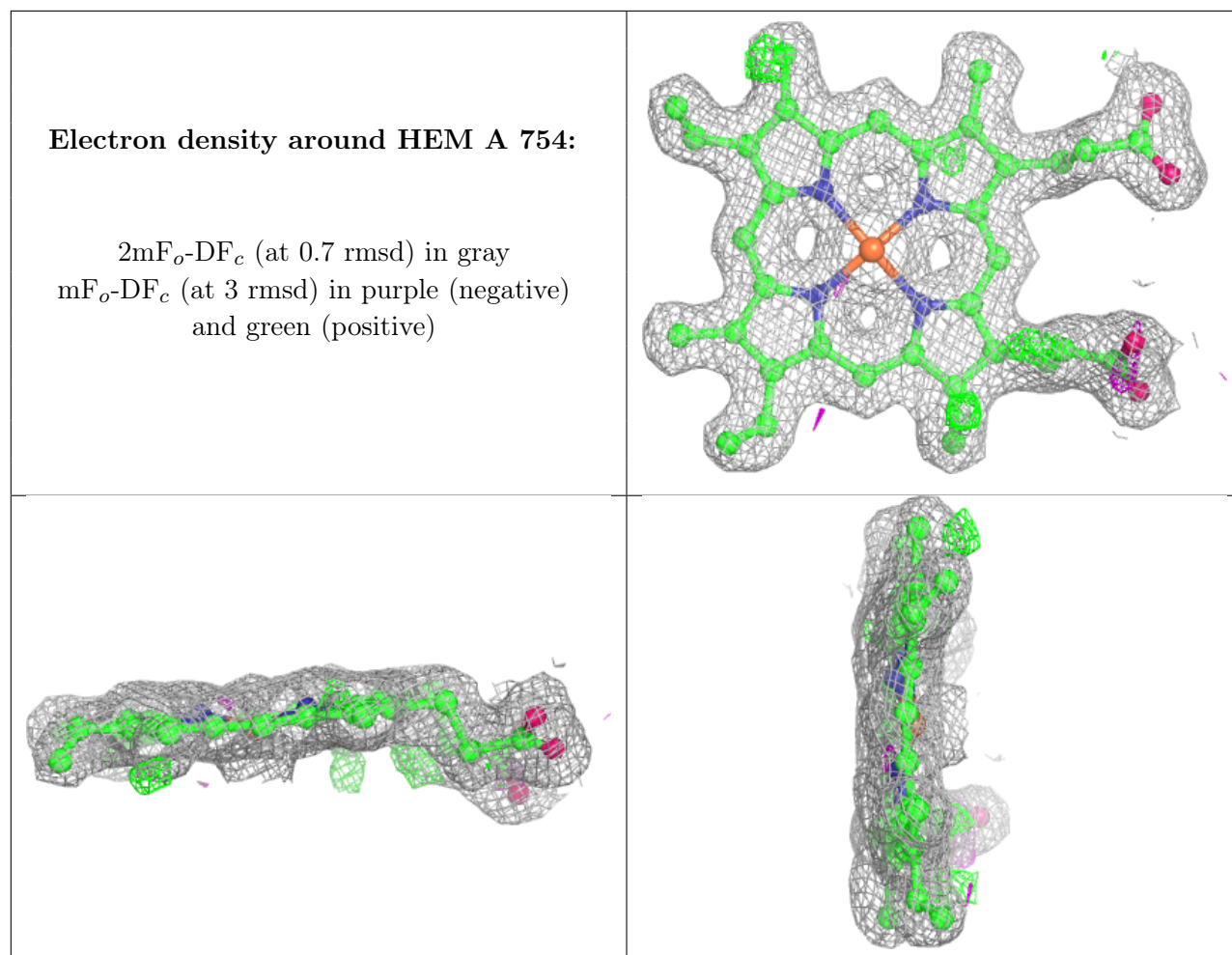

6.5 Other polymers [\(i\)](#)

There are no such residues in this entry.