



Full wwPDB X-ray Structure Validation Report ⓘ

Oct 22, 2024 – 07:30 AM EDT

PDB ID : 3QBH
Title : Structure based design, synthesis and SAR of cyclic hydroxyethylamine (HEA) BACE-1 inhibitors
Authors : Rondeau, J.M.
Deposited on : 2011-01-13
Resolution : 2.24 Å(reported)

This is a Full wwPDB X-ray Structure Validation Report for a publicly released PDB entry.

We welcome your comments at validation@mail.wwpdb.org

A user guide is available at

<https://www.wwpdb.org/validation/2017/XrayValidationReportHelp>

with specific help available everywhere you see the ⓘ symbol.

The types of validation reports are described at

<http://www.wwpdb.org/validation/2017/FAQs#types>.

The following versions of software and data (see [references ⓘ](#)) were used in the production of this report:

MolProbity : 4.02b-467
Mogul : 2022.3.0, CSD as543be (2022)
Xtriage (Phenix) : 1.20.1
EDS : 3.0
buster-report : 1.1.7 (2018)
Percentile statistics : 20231227.v01 (using entries in the PDB archive December 27th 2023)
CCP4 : 9.0.003 (Gargrove)
Density-Fitness : 1.0.11
Ideal geometry (proteins) : Engh & Huber (2001)
Ideal geometry (DNA, RNA) : Parkinson et al. (1996)
Validation Pipeline (wwPDB-VP) : 2.39

1 Overall quality at a glance

The following experimental techniques were used to determine the structure:

X-RAY DIFFRACTION

The reported resolution of this entry is 2.24 Å.

Percentile scores (ranging between 0-100) for global validation metrics of the entry are shown in the following graphic. The table shows the number of entries on which the scores are based.

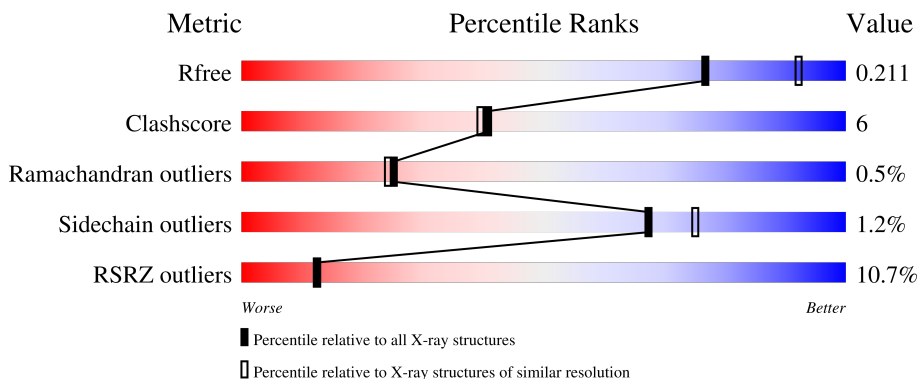

Metric	Whole archive (#Entries)	Similar resolution (#Entries, resolution range(Å))
R_{free}	164625	3139 (2.26-2.22)
Clashscore	180529	3381 (2.26-2.22)
Ramachandran outliers	177936	3334 (2.26-2.22)
Sidechain outliers	177891	3335 (2.26-2.22)
RSRZ outliers	164620	3138 (2.26-2.22)

The table below summarises the geometric issues observed across the polymeric chains and their fit to the electron density. The red, orange, yellow and green segments of the lower bar indicate the fraction of residues that contain outliers for ≥ 3 , 2, 1 and 0 types of geometric quality criteria respectively. A grey segment represents the fraction of residues that are not modelled. The numeric value for each fraction is indicated below the corresponding segment, with a dot representing fractions $\leq 5\%$. The upper red bar (where present) indicates the fraction of residues that have poor fit to the electron density. The numeric value is given above the bar.

Mol	Chain	Length	Quality of chain
1	A	402	 9% 80% 13% 7%
1	B	402	 12% 77% 16% 6%
1	C	402	 9% 76% 17% 7%

2 Entry composition

There are 3 unique types of molecules in this entry. The entry contains 9482 atoms, of which 0 are hydrogens and 0 are deuteriums.

In the tables below, the ZeroOcc column contains the number of atoms modelled with zero occupancy, the AltConf column contains the number of residues with at least one atom in alternate conformation and the Trace column contains the number of residues modelled with at most 2 atoms.

- Molecule 1 is a protein called Beta-secretase 1.

Mol	Chain	Residues	Atoms					ZeroOcc	AltConf	Trace
			Total	C	N	O	S			
1	A	375	2953	1890	491	558	14	0	0	0
1	B	376	2961	1895	492	560	14	0	0	0
1	C	375	2953	1890	491	558	14	0	0	0

There are 6 discrepancies between the modelled and reference sequences:

Chain	Residue	Modelled	Actual	Comment	Reference
A	33P	GLY	-	expression tag	UNP P56817
A	34P	PRO	-	expression tag	UNP P56817
B	33P	GLY	-	expression tag	UNP P56817
B	34P	PRO	-	expression tag	UNP P56817
C	33P	GLY	-	expression tag	UNP P56817
C	34P	PRO	-	expression tag	UNP P56817

- Molecule 2 is (4S)-4-(2-hydroxy-5-(((3S,4S,5R)-4-hydroxy-1,1-dioxido-5-([3-(propan-2-yl)benzyl]amino)tetrahydro-2H-thiopyran-3-yl)methyl)benzyl)-3-propyl-1,3-oxazolidin-2-one (three-letter code: QBH) (formula: C₂₉H₄₀N₂O₆S).

3 Residue-property plots [i](#)

These plots are drawn for all protein, RNA, DNA and oligosaccharide chains in the entry. The first graphic for a chain summarises the proportions of the various outlier classes displayed in the second graphic. The second graphic shows the sequence view annotated by issues in geometry and electron density. Residues are color-coded according to the number of geometric quality criteria for which they contain at least one outlier: green = 0, yellow = 1, orange = 2 and red = 3 or more. A red dot above a residue indicates a poor fit to the electron density ($RSRZ > 2$). Stretches of 2 or more consecutive residues without any outlier are shown as a green connector. Residues present in the sample, but not in the model, are shown in grey.

- Molecule 1: Beta-secretase 1

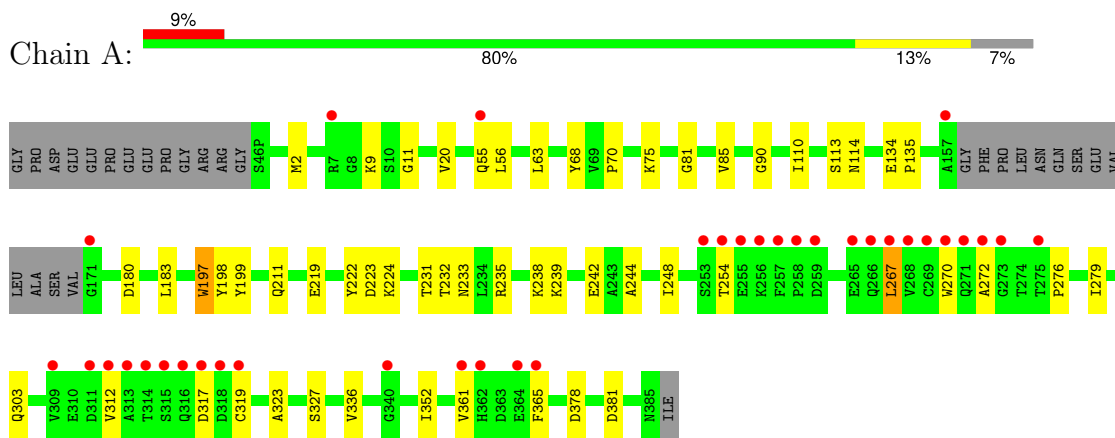

- Molecule 1: Beta-secretase 1

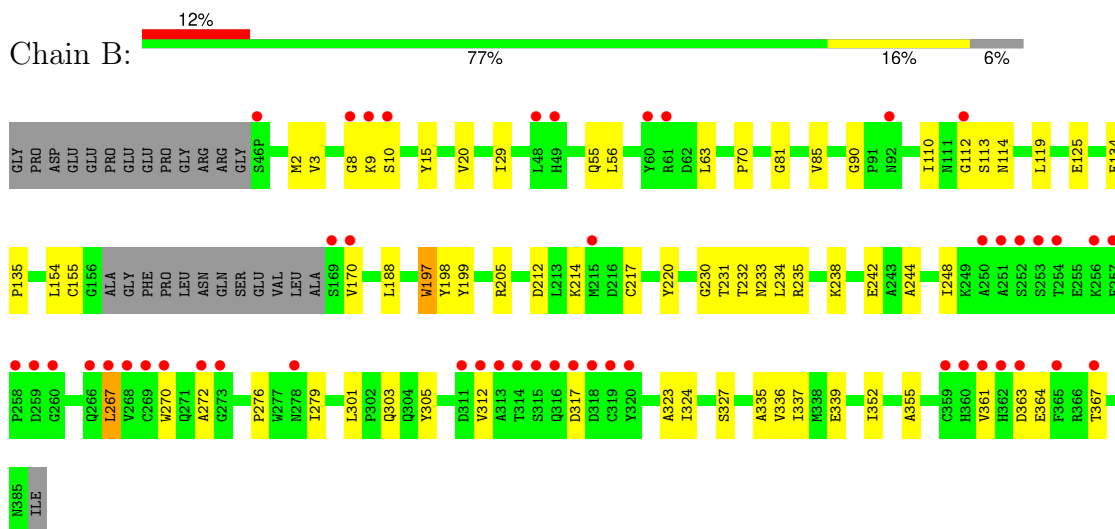

- Molecule 1: Beta-secretase 1

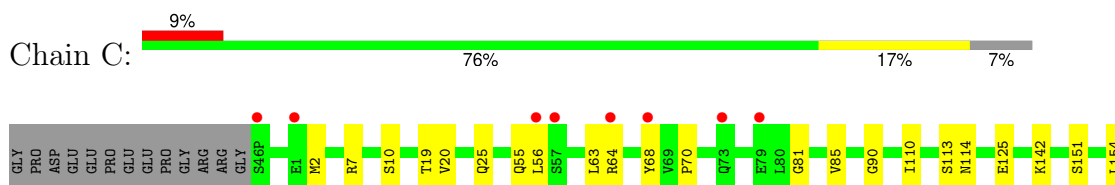

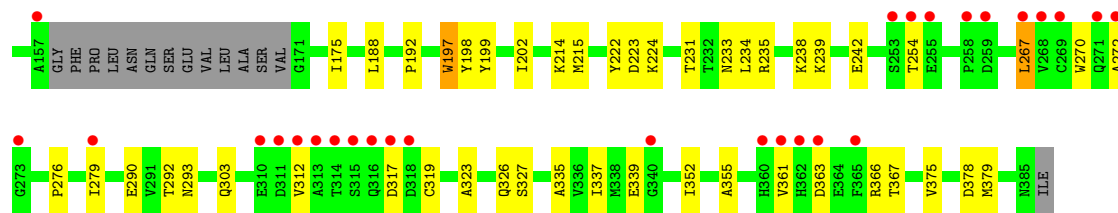

4 Data and refinement statistics

Property	Value	Source
Space group	P 1 21 1	Depositor
Cell constants a, b, c, α , β , γ	82.00Å 103.06Å 100.90Å 90.00° 103.98° 90.00°	Depositor
Resolution (Å)	80.00 – 2.24 80.00 – 2.24	Depositor EDS
% Data completeness (in resolution range)	99.5 (80.00-2.24) 99.6 (80.00-2.24)	Depositor EDS
R_{merge}	0.06	Depositor
R_{sym}	(Not available)	Depositor
$\langle I/\sigma(I) \rangle$ ¹	4.90 (at 2.25Å)	Xtrriage
Refinement program	CNS, CNX	Depositor
R, R_{free}	0.197 , 0.219 0.191 , 0.211	Depositor DCC
R_{free} test set	7814 reflections (10.01%)	wwPDB-VP
Wilson B-factor (Å ²)	42.9	Xtrriage
Anisotropy	0.303	Xtrriage
Bulk solvent k_{sol} (e/Å ³), B_{sol} (Å ²)	0.37 , 41.1	EDS
L-test for twinning ²	$\langle L \rangle = 0.48$, $\langle L^2 \rangle = 0.30$	Xtrriage
Estimated twinning fraction	No twinning to report.	Xtrriage
F_o, F_c correlation	0.95	EDS
Total number of atoms	9482	wwPDB-VP
Average B, all atoms (Å ²)	48.0	wwPDB-VP

Xtrriage's analysis on translational NCS is as follows: *The largest off-origin peak in the Patterson function is 3.59% of the height of the origin peak. No significant pseudotranslation is detected.*

¹Intensities estimated from amplitudes.

²Theoretical values of $\langle |L| \rangle$, $\langle L^2 \rangle$ for acentric reflections are 0.5, 0.333 respectively for untwinned datasets, and 0.375, 0.2 for perfectly twinned datasets.

5 Model quality [i](#)

5.1 Standard geometry [i](#)

Bond lengths and bond angles in the following residue types are not validated in this section: QBH

The Z score for a bond length (or angle) is the number of standard deviations the observed value is removed from the expected value. A bond length (or angle) with $|Z| > 5$ is considered an outlier worth inspection. RMSZ is the root-mean-square of all Z scores of the bond lengths (or angles).

Mol	Chain	Bond lengths		Bond angles	
		RMSZ	# Z >5	RMSZ	# Z >5
1	A	0.33	0/3028	0.61	0/4115
1	B	0.32	0/3036	0.60	0/4126
1	C	0.33	0/3028	0.61	0/4115
All	All	0.33	0/9092	0.61	0/12356

There are no bond length outliers.

There are no bond angle outliers.

There are no chirality outliers.

There are no planarity outliers.

5.2 Too-close contacts [i](#)

In the following table, the Non-H and H(model) columns list the number of non-hydrogen atoms and hydrogen atoms in the chain respectively. The H(added) column lists the number of hydrogen atoms added and optimized by MolProbity. The Clashes column lists the number of clashes within the asymmetric unit, whereas Symm-Clashes lists symmetry-related clashes.

Mol	Chain	Non-H	H(model)	H(added)	Clashes	Symm-Clashes
1	A	2953	0	2861	31	0
1	B	2961	0	2870	40	0
1	C	2953	0	2861	45	0
2	A	38	0	40	1	0
2	B	38	0	40	2	0
2	C	38	0	40	1	0
3	A	176	0	0	1	0
3	B	159	0	0	1	0
3	C	166	0	0	3	0
All	All	9482	0	8712	114	0

The all-atom clashscore is defined as the number of clashes found per 1000 atoms (including hydrogen atoms). The all-atom clashscore for this structure is 6.

All (114) close contacts within the same asymmetric unit are listed below, sorted by their clash magnitude.

Atom-1	Atom-2	Interatomic distance (Å)	Clash overlap (Å)
1:B:301:LEU:HD11	1:B:367:THR:HA	1.70	0.74
1:A:233:ASN:HB3	1:A:323:ALA:O	1.91	0.70
1:B:233:ASN:HB3	1:B:323:ALA:O	1.98	0.63
1:A:276:PRO:O	1:A:279:ILE:HG12	1.97	0.63
1:B:276:PRO:O	1:B:279:ILE:HG12	1.99	0.63
1:C:363:ASP:HB3	1:C:366:ARG:O	1.99	0.62
1:C:367:THR:HG22	3:C:495:HOH:O	1.98	0.62
1:A:303:GLN:HB2	1:A:361:VAL:HG11	1.83	0.61
1:A:365:PHE:HB2	3:A:466:HOH:O	2.03	0.58
1:C:125:GLU:HG2	1:C:197:TRP:HB3	1.85	0.58
1:C:202:ILE:CD1	1:C:379:MET:HG3	2.34	0.58
1:B:335:ALA:O	1:B:339:GLU:HG3	2.03	0.57
1:C:276:PRO:O	1:C:279:ILE:HG12	2.04	0.57
1:B:10:SER:HB2	3:B:465:HOH:O	2.05	0.56
1:A:267:LEU:H	1:A:267:LEU:HD23	1.71	0.56
1:A:238:LYS:O	1:A:242:GLU:HG3	2.05	0.56
1:B:323:ALA:HB1	1:B:336:VAL:HG11	1.87	0.56
1:A:2:MET:HG2	1:A:90:GLY:HA2	1.87	0.56
1:C:233:ASN:HB3	1:C:323:ALA:O	2.06	0.56
1:B:125:GLU:HG2	1:B:197:TRP:HB3	1.87	0.56
1:B:205:ARG:NH2	1:B:212:ASP:HB2	2.20	0.55
1:C:238:LYS:O	1:C:242:GLU:HG3	2.07	0.54
1:B:9:LYS:HD2	1:B:112:GLY:O	2.08	0.53
1:C:2:MET:HG2	1:C:90:GLY:HA2	1.90	0.53
1:B:20:VAL:HG12	1:B:85:VAL:HG22	1.91	0.53
1:A:267:LEU:HD11	1:A:312:VAL:HG13	1.91	0.52
1:C:215:MET:CE	1:C:239:LYS:HG3	2.40	0.52
1:B:238:LYS:O	1:B:242:GLU:HG3	2.10	0.52
1:C:267:LEU:HD11	1:C:312:VAL:HG13	1.92	0.52
1:B:63:LEU:HG	1:B:81:GLY:HA2	1.93	0.51
1:B:267:LEU:HD11	1:B:312:VAL:HG13	1.92	0.51
1:B:267:LEU:H	1:B:267:LEU:HD23	1.76	0.51
1:C:267:LEU:HD23	1:C:267:LEU:H	1.75	0.51
1:A:219:GLU:OE1	1:A:239:LYS:HD2	2.11	0.50
1:C:235:ARG:HB3	1:C:327:SER:HB2	1.94	0.50
1:C:215:MET:HE1	1:C:239:LYS:HG3	1.94	0.50
1:C:303:GLN:HB2	1:C:361:VAL:HG11	1.92	0.49

Continued on next page...

Continued from previous page...

Atom-1	Atom-2	Interatomic distance (Å)	Clash overlap (Å)
1:C:270:TRP:O	1:C:317:ASP:HB3	2.12	0.49
1:C:68:TYR:OH	1:C:70:PRO:HB3	2.12	0.49
1:A:63:LEU:HG	1:A:81:GLY:HA2	1.95	0.48
1:B:8:GLY:O	1:B:170:VAL:HG22	2.14	0.48
1:C:335:ALA:O	1:C:339:GLU:HG3	2.14	0.48
1:A:110:ILE:HB	1:A:113:SER:HB3	1.96	0.47
1:A:232:THR:O	1:A:336:VAL:HG13	2.13	0.47
1:A:20:VAL:HG12	1:A:85:VAL:HG22	1.97	0.47
1:B:2:MET:HG2	1:B:90:GLY:HA2	1.95	0.47
1:B:231:THR:OG1	2:B:387:QBH:H2A	2.15	0.47
1:C:63:LEU:HG	1:C:81:GLY:HA2	1.97	0.47
1:B:235:ARG:HB3	1:B:327:SER:HB2	1.96	0.47
1:A:378:ASP:HB3	1:A:381:ASP:OD2	2.14	0.46
1:B:155:CYS:O	1:B:170:VAL:HB	2.15	0.46
1:B:270:TRP:O	1:B:317:ASP:HB3	2.15	0.46
1:C:110:ILE:HB	1:C:113:SER:HB3	1.98	0.46
1:C:378:ASP:HB2	3:C:466:HOH:O	2.16	0.46
1:C:10:SER:HB3	1:C:339:GLU:OE1	2.16	0.46
1:B:244:ALA:O	1:B:248:ILE:HG13	2.16	0.46
1:A:68:TYR:CD1	1:B:3:VAL:HG11	2.52	0.45
1:A:270:TRP:O	1:A:317:ASP:HB3	2.17	0.45
1:C:64:ARG:HG2	1:C:64:ARG:HH11	1.81	0.45
1:B:8:GLY:HA2	1:B:15:TYR:CE2	2.52	0.45
1:B:217:CYS:HA	1:B:220:TYR:CD1	2.52	0.45
1:C:199:TYR:HB3	1:C:352:ILE:HD11	1.97	0.45
1:A:235:ARG:HB3	1:A:327:SER:HB2	1.99	0.45
1:B:188:LEU:HD23	1:B:355:ALA:HB2	1.98	0.45
1:C:198:TYR:CE2	1:C:224:LYS:HE3	2.52	0.45
1:C:231:THR:OG1	2:C:387:QBH:H2A	2.16	0.45
1:B:232:THR:O	1:B:336:VAL:HG13	2.17	0.45
1:A:197:TRP:CG	1:A:198:TYR:N	2.85	0.45
1:A:199:TYR:HB3	1:A:352:ILE:HD11	1.98	0.44
1:C:19:THR:HA	1:C:25:GLN:O	2.17	0.44
1:B:230:GLY:O	2:B:387:QBH:H11	2.18	0.44
1:A:198:TYR:CE2	1:A:224:LYS:HE3	2.52	0.44
1:C:293:ASN:HA	1:C:375:VAL:HA	2.00	0.44
1:A:9:LYS:NZ	1:A:11:GLY:HA3	2.33	0.44
1:C:20:VAL:HG12	1:C:85:VAL:HG22	2.00	0.44
1:A:180:ASP:OD2	1:A:183:LEU:HG	2.18	0.43
1:A:254:THR:HG21	1:C:254:THR:HG21	2.00	0.43
1:B:110:ILE:HB	1:B:113:SER:HB3	2.00	0.43

Continued on next page...

Continued from previous page...

Atom-1	Atom-2	Interatomic distance (Å)	Clash overlap (Å)
1:B:212:ASP:C	1:B:214:LYS:H	2.21	0.43
1:A:134:GLU:HA	1:A:135:PRO:HD3	1.88	0.43
1:A:222:TYR:HA	1:A:223:ASP:HA	1.63	0.43
1:B:303:GLN:HB3	1:B:361:VAL:HG11	2.00	0.43
1:A:267:LEU:HD12	1:A:319:CYS:HB3	2.01	0.43
1:C:197:TRP:CG	1:C:198:TYR:N	2.86	0.43
1:A:267:LEU:HD23	1:A:267:LEU:N	2.32	0.43
1:B:55:GLN:HG2	1:B:56:LEU:N	2.34	0.43
1:B:154:LEU:O	1:B:339:GLU:HA	2.18	0.43
1:C:292:THR:HG21	1:C:378:ASP:HB3	2.01	0.43
1:C:151:SER:OG	1:C:175:ILE:HB	2.19	0.43
1:C:142:LYS:HG3	3:C:483:HOH:O	2.19	0.42
1:B:199:TYR:HB3	1:B:352:ILE:HD11	2.00	0.42
1:C:188:LEU:HD23	1:C:355:ALA:HB2	2.01	0.42
1:B:134:GLU:HA	1:B:135:PRO:HD3	1.89	0.42
1:C:238:LYS:HA	1:C:326:GLN:HG3	2.01	0.42
1:C:55:GLN:HG2	1:C:56:LEU:N	2.35	0.42
1:C:202:ILE:HD11	1:C:379:MET:HG3	2.00	0.42
1:C:214:LYS:HB3	1:C:214:LYS:NZ	2.35	0.42
1:B:125:GLU:HB3	1:B:197:TRP:HA	2.01	0.42
1:B:305:TYR:HB2	1:B:324:ILE:HG13	2.02	0.41
1:B:29:ILE:HG21	1:B:119:LEU:HB2	2.02	0.41
1:B:197:TRP:CG	1:B:198:TYR:N	2.87	0.41
1:C:192:PRO:HG3	1:C:290:GLU:HA	2.02	0.41
1:C:154:LEU:O	1:C:339:GLU:HA	2.20	0.41
1:C:267:LEU:HD12	1:C:319:CYS:HB3	2.03	0.41
1:A:55:GLN:HG2	1:A:56:LEU:N	2.36	0.41
1:A:231:THR:OG1	2:A:387:QBH:H2A	2.21	0.41
1:A:197:TRP:CD1	1:A:197:TRP:N	2.88	0.40
1:C:197:TRP:N	1:C:197:TRP:CD1	2.89	0.40
1:B:197:TRP:CD1	1:B:197:TRP:N	2.90	0.40
1:C:222:TYR:HA	1:C:223:ASP:HA	1.59	0.40
1:A:244:ALA:O	1:A:248:ILE:HG13	2.22	0.40
1:C:7:ARG:HD3	1:C:7:ARG:HA	1.84	0.40
1:C:234:LEU:HB2	1:C:337:ILE:HD11	2.03	0.40
1:B:234:LEU:HB2	1:B:337:ILE:HD11	2.04	0.40

There are no symmetry-related clashes.

5.3 Torsion angles [i](#)

5.3.1 Protein backbone [i](#)

In the following table, the Percentiles column shows the percent Ramachandran outliers of the chain as a percentile score with respect to all X-ray entries followed by that with respect to entries of similar resolution.

The Analysed column shows the number of residues for which the backbone conformation was analysed, and the total number of residues.

Mol	Chain	Analysed	Favoured	Allowed	Outliers	Percentiles	
1	A	371/402 (92%)	349 (94%)	20 (5%)	2 (0%)	25	24
1	B	372/402 (92%)	346 (93%)	23 (6%)	3 (1%)	16	13
1	C	371/402 (92%)	352 (95%)	18 (5%)	1 (0%)	37	39
All	All	1114/1206 (92%)	1047 (94%)	61 (6%)	6 (0%)	25	24

All (6) Ramachandran outliers are listed below:

Mol	Chain	Res	Type
1	A	272	ALA
1	B	272	ALA
1	B	364	GLU
1	C	272	ALA
1	A	70	PRO
1	B	70	PRO

5.3.2 Protein sidechains [i](#)

In the following table, the Percentiles column shows the percent sidechain outliers of the chain as a percentile score with respect to all X-ray entries followed by that with respect to entries of similar resolution.

The Analysed column shows the number of residues for which the sidechain conformation was analysed, and the total number of residues.

Mol	Chain	Analysed	Rotameric	Outliers	Percentiles	
1	A	320/342 (94%)	315 (98%)	5 (2%)	58	66
1	B	322/342 (94%)	318 (99%)	4 (1%)	67	75
1	C	320/342 (94%)	317 (99%)	3 (1%)	75	82
All	All	962/1026 (94%)	950 (99%)	12 (1%)	67	75

All (12) residues with a non-rotameric sidechain are listed below:

Mol	Chain	Res	Type
1	A	75	LYS
1	A	114	ASN
1	A	197	TRP
1	A	211	GLN
1	A	267	LEU
1	B	114	ASN
1	B	197	TRP
1	B	267	LEU
1	B	363	ASP
1	C	114	ASN
1	C	197	TRP
1	C	267	LEU

Sometimes sidechains can be flipped to improve hydrogen bonding and reduce clashes. All (8) such sidechains are listed below:

Mol	Chain	Res	Type
1	A	73	GLN
1	A	114	ASN
1	A	278	ASN
1	B	114	ASN
1	B	293	ASN
1	B	326	GLN
1	C	73	GLN
1	C	114	ASN

5.3.3 RNA [i](#)

There are no RNA molecules in this entry.

5.4 Non-standard residues in protein, DNA, RNA chains [i](#)

There are no non-standard protein/DNA/RNA residues in this entry.

5.5 Carbohydrates [i](#)

There are no oligosaccharides in this entry.

5.6 Ligand geometry

3 ligands are modelled in this entry.

In the following table, the Counts columns list the number of bonds (or angles) for which Mogul statistics could be retrieved, the number of bonds (or angles) that are observed in the model and the number of bonds (or angles) that are defined in the Chemical Component Dictionary. The Link column lists molecule types, if any, to which the group is linked. The Z score for a bond length (or angle) is the number of standard deviations the observed value is removed from the expected value. A bond length (or angle) with $|Z| > 2$ is considered an outlier worth inspection. RMSZ is the root-mean-square of all Z scores of the bond lengths (or angles).

Mol	Type	Chain	Res	Link	Bond lengths			Bond angles		
					Counts	RMSZ	# Z > 2	Counts	RMSZ	# Z > 2
2	QBH	A	387	-	39,41,41	1.59	6 (15%)	47,59,59	0.93	3 (6%)
2	QBH	C	387	-	39,41,41	1.61	8 (20%)	47,59,59	0.92	3 (6%)
2	QBH	B	387	-	39,41,41	1.67	7 (17%)	47,59,59	1.00	3 (6%)

In the following table, the Chirals column lists the number of chiral outliers, the number of chiral centers analysed, the number of these observed in the model and the number defined in the Chemical Component Dictionary. Similar counts are reported in the Torsion and Rings columns. '-' means no outliers of that kind were identified.

Mol	Type	Chain	Res	Link	Chirals	Torsions	Rings
2	QBH	A	387	-	-	0/20/51/51	0/4/4/4
2	QBH	C	387	-	-	1/20/51/51	0/4/4/4
2	QBH	B	387	-	-	1/20/51/51	0/4/4/4

All (21) bond length outliers are listed below:

Mol	Chain	Res	Type	Atoms	Z	Observed(Å)	Ideal(Å)
2	B	387	QBH	C2-S1	3.57	1.80	1.77
2	A	387	QBH	C2-S1	3.48	1.80	1.77
2	B	387	QBH	C14-C9	3.29	1.57	1.53
2	A	387	QBH	C14-C9	3.20	1.57	1.53
2	C	387	QBH	C14-C9	2.87	1.57	1.53
2	C	387	QBH	C2-S1	2.72	1.79	1.77
2	C	387	QBH	C11-S1	2.58	1.79	1.77
2	B	387	QBH	C58-C60	2.51	1.42	1.39
2	C	387	QBH	C58-C60	2.49	1.42	1.39
2	B	387	QBH	C28-C20	2.39	1.55	1.51
2	A	387	QBH	C58-C60	2.32	1.42	1.39
2	C	387	QBH	C28-C20	2.32	1.55	1.51
2	C	387	QBH	C21-C20	2.28	1.43	1.40
2	B	387	QBH	C11-S1	2.18	1.79	1.77

Continued on next page...

Continued from previous page...

Mol	Chain	Res	Type	Atoms	Z	Observed(Å)	Ideal(Å)
2	A	387	QBH	C28-C20	2.17	1.55	1.51
2	C	387	QBH	C7-C5	2.10	1.56	1.52
2	C	387	QBH	C61-C60	2.09	1.42	1.39
2	A	387	QBH	C21-C20	2.08	1.42	1.40
2	A	387	QBH	C7-C5	2.04	1.56	1.52
2	B	387	QBH	C21-C20	2.03	1.42	1.40
2	B	387	QBH	C28-C31	2.00	1.56	1.53

All (9) bond angle outliers are listed below:

Mol	Chain	Res	Type	Atoms	Z	Observed(°)	Ideal(°)
2	B	387	QBH	C20-C28-C31	2.71	116.41	113.05
2	B	387	QBH	C54-N52-C5	2.57	120.16	114.84
2	C	387	QBH	C54-N52-C5	2.41	119.83	114.84
2	A	387	QBH	C54-N52-C5	2.39	119.80	114.84
2	A	387	QBH	C28-C31-C36	2.36	116.57	114.07
2	C	387	QBH	C20-C28-C31	2.24	115.83	113.05
2	A	387	QBH	C20-C28-C31	2.18	115.76	113.05
2	C	387	QBH	C28-C31-C36	2.12	116.32	114.07
2	B	387	QBH	C28-C31-C36	2.10	116.29	114.07

There are no chirality outliers.

All (2) torsion outliers are listed below:

Mol	Chain	Res	Type	Atoms
2	B	387	QBH	C17-C14-C9-C11
2	C	387	QBH	C17-C14-C9-C11

There are no ring outliers.

3 monomers are involved in 4 short contacts:

Mol	Chain	Res	Type	Clashes	Symm-Clashes
2	A	387	QBH	1	0
2	C	387	QBH	1	0
2	B	387	QBH	2	0

The following is a two-dimensional graphical depiction of Mogul quality analysis of bond lengths, bond angles, torsion angles, and ring geometry for all instances of the Ligand of Interest. In addition, ligands with molecular weight > 250 and outliers as shown on the validation Tables will also be included. For torsion angles, if less than 5% of the Mogul distribution of torsion angles is within 10 degrees of the torsion angle in question, then that torsion angle is considered an outlier.

Any bond that is central to one or more torsion angles identified as an outlier by Mogul will be highlighted in the graph. For rings, the root-mean-square deviation (RMSD) between the ring in question and similar rings identified by Mogul is calculated over all ring torsion angles. If the average RMSD is greater than 60 degrees and the minimal RMSD between the ring in question and any Mogul-identified rings is also greater than 60 degrees, then that ring is considered an outlier. The outliers are highlighted in purple. The color gray indicates Mogul did not find sufficient equivalents in the CSD to analyse the geometry.

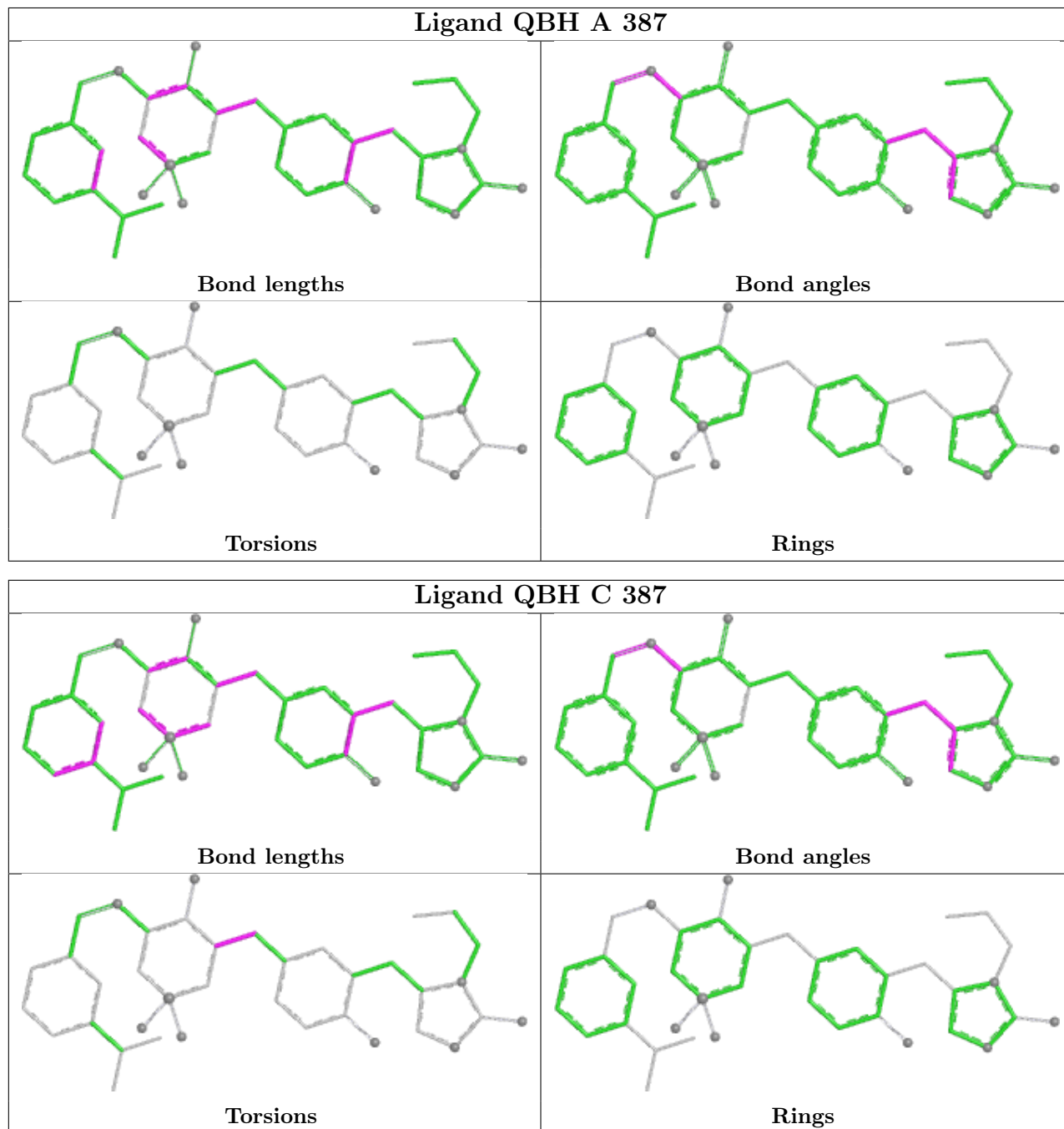

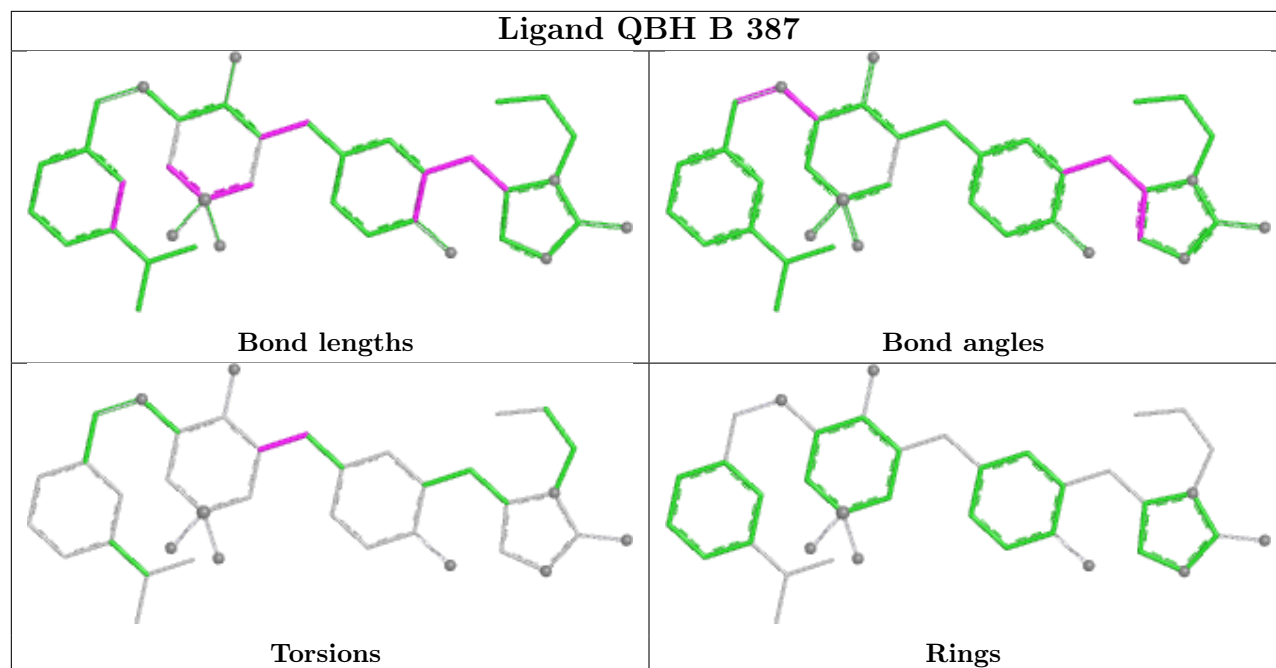

5.7 Other polymers [i](#)

There are no such residues in this entry.

5.8 Polymer linkage issues [i](#)

There are no chain breaks in this entry.

6 Fit of model and data [i](#)

6.1 Protein, DNA and RNA chains [i](#)

In the following table, the column labelled ‘#RSRZ > 2’ contains the number (and percentage) of RSRZ outliers, followed by percent RSRZ outliers for the chain as percentile scores relative to all X-ray entries and entries of similar resolution. The OWAB column contains the minimum, median, 95th percentile and maximum values of the occupancy-weighted average B-factor per residue. The column labelled ‘Q < 0.9’ lists the number of (and percentage) of residues with an average occupancy less than 0.9.

Mol	Chain	Analysed	<RSRZ>	#RSRZ>2	OWAB(Å ²)	Q<0.9
1	A	375/402 (93%)	0.45	36 (9%) 15 15	27, 45, 80, 116	0
1	B	376/402 (93%)	0.58	48 (12%) 9 8	26, 47, 83, 116	0
1	C	375/402 (93%)	0.44	36 (9%) 15 15	29, 45, 80, 116	0
All	All	1126/1206 (93%)	0.49	120 (10%) 12 12	26, 45, 81, 116	0

All (120) RSRZ outliers are listed below:

Mol	Chain	Res	Type	RSRZ
1	B	314	THR	7.0
1	B	361	VAL	7.0
1	B	312	VAL	6.3
1	A	312	VAL	6.3
1	C	312	VAL	6.1
1	A	313	ALA	6.1
1	C	314	THR	5.9
1	A	317	ASP	5.7
1	B	267	LEU	5.5
1	B	313	ALA	5.3
1	A	314	THR	5.2
1	B	315	SER	5.0
1	C	313	ALA	5.0
1	A	272	ALA	4.8
1	C	317	ASP	4.5
1	A	311	ASP	4.5
1	B	10	SER	4.5
1	B	258	PRO	4.4
1	C	68	TYR	4.4
1	C	254	THR	4.3
1	A	365	PHE	4.3
1	B	362	HIS	4.2
1	C	362	HIS	4.1

Continued on next page...

Continued from previous page...

Mol	Chain	Res	Type	RSRZ
1	A	258	PRO	4.1
1	A	315	SER	4.1
1	A	361	VAL	4.1
1	B	317	ASP	3.9
1	C	259	ASP	3.9
1	C	315	SER	3.9
1	C	267	LEU	3.8
1	B	254	THR	3.8
1	C	311	ASP	3.7
1	A	309	VAL	3.7
1	A	318	ASP	3.6
1	A	55	GLN	3.6
1	B	360	HIS	3.6
1	A	257	PHE	3.5
1	A	157	ALA	3.4
1	C	365	PHE	3.4
1	B	316	GLN	3.4
1	A	267	LEU	3.4
1	B	256	LYS	3.4
1	C	361	VAL	3.4
1	B	363	ASP	3.4
1	A	254	THR	3.3
1	B	365	PHE	3.3
1	C	46(P)	SER	3.3
1	A	273	GLY	3.3
1	B	8	GLY	3.3
1	A	253	SER	3.2
1	A	256	LYS	3.1
1	B	259	ASP	3.1
1	C	258	PRO	3.1
1	A	259	ASP	3.1
1	C	316	GLN	3.0
1	B	250	ALA	3.0
1	B	170	VAL	3.0
1	C	157	ALA	3.0
1	C	269	CYS	2.9
1	B	278	ASN	2.8
1	B	257	PHE	2.8
1	B	320	TYR	2.8
1	B	268	VAL	2.8
1	C	272	ALA	2.8
1	C	79	GLU	2.7

Continued on next page...

Continued from previous page...

Mol	Chain	Res	Type	RSRZ
1	B	272	ALA	2.7
1	B	260	GLY	2.7
1	B	269	CYS	2.7
1	B	9	LYS	2.7
1	C	310	GLU	2.7
1	B	359	CYS	2.7
1	B	61	ARG	2.7
1	C	279	ILE	2.6
1	A	266	GLN	2.6
1	C	255	GLU	2.6
1	C	273	GLY	2.6
1	A	269	CYS	2.6
1	B	252	SER	2.6
1	A	268	VAL	2.5
1	B	273	GLY	2.5
1	C	271	GLN	2.5
1	A	319	CYS	2.5
1	B	367	THR	2.5
1	A	271	GLN	2.5
1	B	49	HIS	2.5
1	B	46(P)	SER	2.4
1	B	311	ASP	2.4
1	A	340	GLY	2.4
1	B	319	CYS	2.4
1	C	318	ASP	2.4
1	A	171	GLY	2.4
1	B	266	GLN	2.4
1	A	362	HIS	2.4
1	C	268	VAL	2.3
1	A	316	GLN	2.3
1	A	255	GLU	2.3
1	A	364	GLU	2.3
1	C	340	GLY	2.3
1	B	215	MET	2.2
1	C	363	ASP	2.2
1	A	265	GLU	2.2
1	C	57	SER	2.2
1	B	251	ALA	2.2
1	C	1	GLU	2.2
1	A	270	TRP	2.2
1	B	270	TRP	2.2
1	A	7	ARG	2.2

Continued on next page...

Continued from previous page...

Mol	Chain	Res	Type	RSRZ
1	C	64	ARG	2.2
1	A	275	THR	2.1
1	B	60	TYR	2.1
1	B	318	ASP	2.1
1	B	169	SER	2.1
1	B	253	SER	2.1
1	C	253	SER	2.1
1	C	360	HIS	2.1
1	C	73	GLN	2.1
1	B	48	LEU	2.0
1	C	56	LEU	2.0
1	B	112	GLY	2.0
1	B	92	ASN	2.0

6.2 Non-standard residues in protein, DNA, RNA chains [i](#)

There are no non-standard protein/DNA/RNA residues in this entry.

6.3 Carbohydrates [i](#)

There are no monosaccharides in this entry.

6.4 Ligands [i](#)

In the following table, the Atoms column lists the number of modelled atoms in the group and the number defined in the chemical component dictionary. The B-factors column lists the minimum, median, 95th percentile and maximum values of B factors of atoms in the group. The column labelled 'Q< 0.9' lists the number of atoms with occupancy less than 0.9.

Mol	Type	Chain	Res	Atoms	RSCC	RSR	B-factors(Å ²)	Q<0.9
2	QBH	B	387	38/38	0.96	0.11	35,42,53,55	0
2	QBH	A	387	38/38	0.97	0.09	30,40,46,48	0
2	QBH	C	387	38/38	0.97	0.09	32,40,51,52	0

The following is a graphical depiction of the model fit to experimental electron density of all instances of the Ligand of Interest. In addition, ligands with molecular weight > 250 and outliers as shown on the geometry validation Tables will also be included. Each fit is shown from different orientation to approximate a three-dimensional view.

Electron density around QBH B 387:

$2mF_o-DF_c$ (at 0.7 rmsd) in gray
 mF_o-DF_c (at 3 rmsd) in purple (negative)
and green (positive)

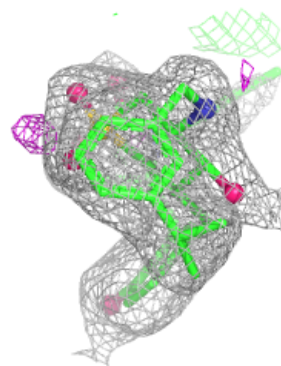
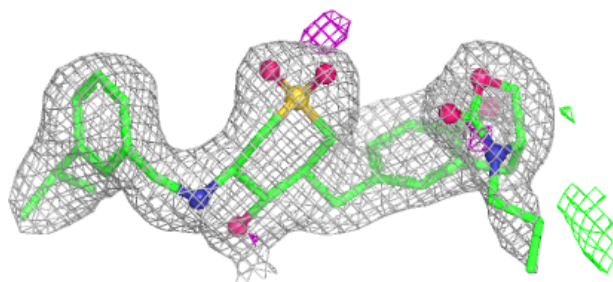
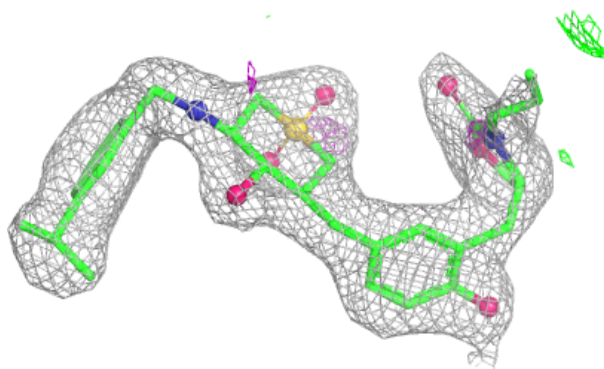
**Electron density around QBH A 387:**

$2mF_o-DF_c$ (at 0.7 rmsd) in gray
 mF_o-DF_c (at 3 rmsd) in purple (negative)
and green (positive)

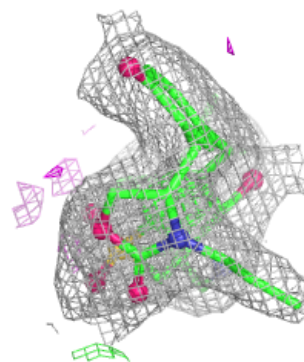
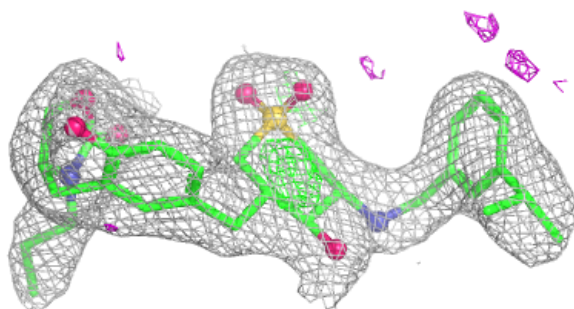
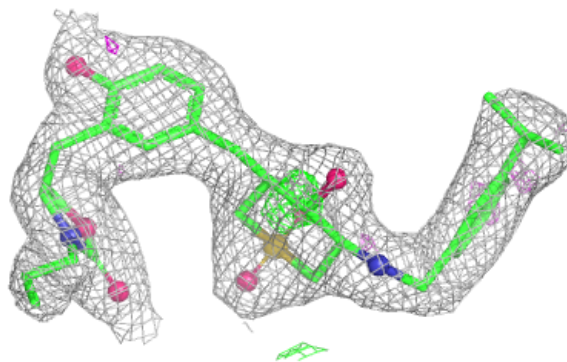

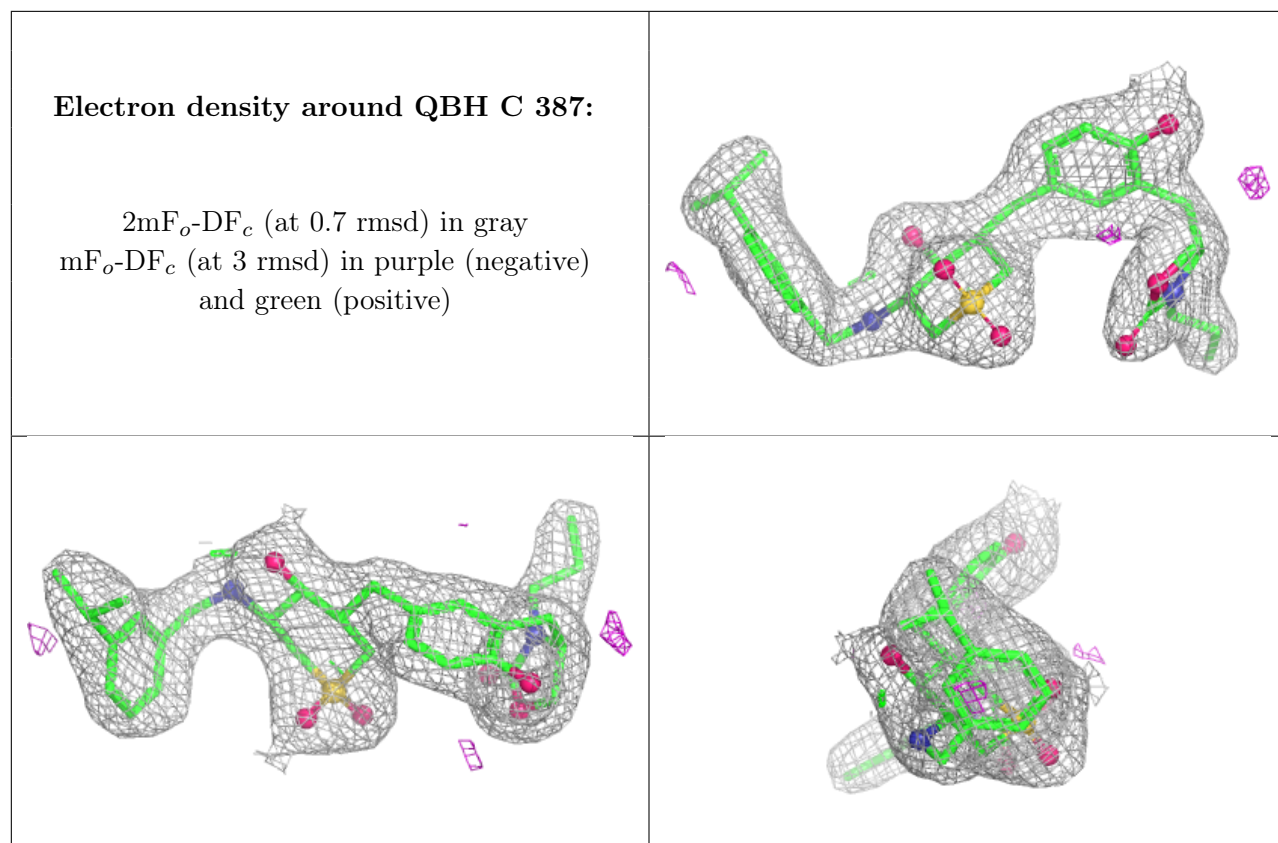

6.5 Other polymers [i](#)

There are no such residues in this entry.