



# Full wwPDB X-ray Structure Validation Report ⓘ

Apr 4, 2023 – 10:32 am BST

PDB ID : 7ZZL  
Title : Crystal structure of CYP106A1  
Authors : Carius, Y.; Kiss, F.; Hutter, M.; Bernhardt, R.; Lancaster, C.R.D.  
Deposited on : 2022-05-25  
Resolution : 1.70 Å(reported)

This is a Full wwPDB X-ray Structure Validation Report for a publicly released PDB entry.

We welcome your comments at [validation@mail.wwpdb.org](mailto:validation@mail.wwpdb.org)

A user guide is available at

<https://www.wwpdb.org/validation/2017/XrayValidationReportHelp>

with specific help available everywhere you see the ⓘ symbol.

The types of validation reports are described at

<http://www.wwpdb.org/validation/2017/FAQs#types>.

---

The following versions of software and data (see [references ⓘ](#)) were used in the production of this report:

MolProbity : 4.02b-467  
Mogul : 1.8.4, CSD as541be (2020)  
Xtriage (Phenix) : 1.13  
EDS : 2.32.2  
buster-report : 1.1.7 (2018)  
Percentile statistics : 20191225.v01 (using entries in the PDB archive December 25th 2019)  
Refmac : 5.8.0158  
CCP4 : 7.0.044 (Gargrove)  
Ideal geometry (proteins) : Engh & Huber (2001)  
Ideal geometry (DNA, RNA) : Parkinson et al. (1996)  
Validation Pipeline (wwPDB-VP) : 2.32.2

# 1 Overall quality at a glance

The following experimental techniques were used to determine the structure:

*X-RAY DIFFRACTION*



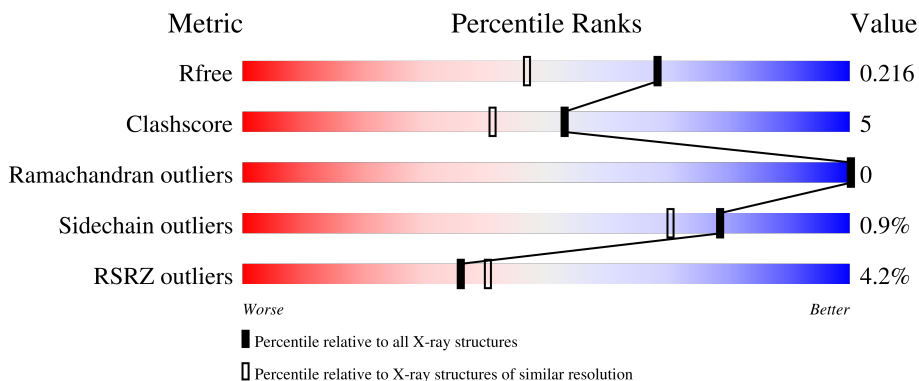

The reported resolution of this entry is 1.70 Å.

Percentile scores (ranging between 0-100) for global validation metrics of the entry are shown in the following graphic. The table shows the number of entries on which the scores are based.

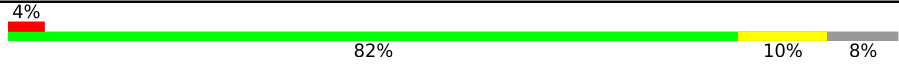

Metric	Whole archive (#Entries)	Similar resolution (#Entries, resolution range(Å))
$R_{free}$	130704	4298 (1.70-1.70)
Clashscore	141614	4695 (1.70-1.70)
Ramachandran outliers	138981	4610 (1.70-1.70)
Sidechain outliers	138945	4610 (1.70-1.70)
RSRZ outliers	127900	4222 (1.70-1.70)

The table below summarises the geometric issues observed across the polymeric chains and their fit to the electron density. The red, orange, yellow and green segments of the lower bar indicate the fraction of residues that contain outliers for  $\geq 3$ , 2, 1 and 0 types of geometric quality criteria respectively. A grey segment represents the fraction of residues that are not modelled. The numeric value for each fraction is indicated below the corresponding segment, with a dot representing fractions  $\leq 5\%$ . The upper red bar (where present) indicates the fraction of residues that have poor fit to the electron density. The numeric value is given above the bar.

Mol	Chain	Length	Quality of chain
1	A	416	 4% 82% 10% 8%
1	B	416	 2% 84% 8% 8%
1	C	416	 6% 82% 13% 5%
1	D	416	 4% 85% 10% 5%

The following table lists non-polymeric compounds, carbohydrate monomers and non-standard

residues in protein, DNA, RNA chains that are outliers for geometric or electron-density-fit criteria:

<b>Mol</b>	<b>Type</b>	<b>Chain</b>	<b>Res</b>	<b>Chirality</b>	<b>Geometry</b>	<b>Clashes</b>	<b>Electron density</b>
3	SO4	A	502	-	-	X	-
4	DMS	B	504	-	-	X	-

## 2 Entry composition i

There are 9 unique types of molecules in this entry. The entry contains 14013 atoms, of which 0 are hydrogens and 0 are deuteriums.

In the tables below, the ZeroOcc column contains the number of atoms modelled with zero occupancy, the AltConf column contains the number of residues with at least one atom in alternate conformation and the Trace column contains the number of residues modelled with at most 2 atoms.

- Molecule 1 is a protein called Cytochrome P450.

Mol	Chain	Residues	Atoms					ZeroOcc	AltConf	Trace
			Total	C	N	O	S			
1	A	381	3086	1981	513	581	11	0	8	0
1	B	383	3111	1998	517	584	12	0	9	0
1	C	397	3246	2087	541	606	12	0	4	0
1	D	397	3263	2096	547	609	11	0	4	0

There are 24 discrepancies between the modelled and reference sequences:

Chain	Residue	Modelled	Actual	Comment	Reference
A	411	HIS	-	expression tag	UNP D5DF35
A	412	HIS	-	expression tag	UNP D5DF35
A	413	HIS	-	expression tag	UNP D5DF35
A	414	HIS	-	expression tag	UNP D5DF35
A	415	HIS	-	expression tag	UNP D5DF35
A	416	HIS	-	expression tag	UNP D5DF35
B	411	HIS	-	expression tag	UNP D5DF35
B	412	HIS	-	expression tag	UNP D5DF35
B	413	HIS	-	expression tag	UNP D5DF35
B	414	HIS	-	expression tag	UNP D5DF35
B	415	HIS	-	expression tag	UNP D5DF35
B	416	HIS	-	expression tag	UNP D5DF35
C	411	HIS	-	expression tag	UNP D5DF35
C	412	HIS	-	expression tag	UNP D5DF35
C	413	HIS	-	expression tag	UNP D5DF35
C	414	HIS	-	expression tag	UNP D5DF35
C	415	HIS	-	expression tag	UNP D5DF35
C	416	HIS	-	expression tag	UNP D5DF35
D	411	HIS	-	expression tag	UNP D5DF35
D	412	HIS	-	expression tag	UNP D5DF35
D	413	HIS	-	expression tag	UNP D5DF35

*Continued on next page...*





Mol	Chain	Residues	Atoms			ZeroOcc	AltConf
3	A	1	Total	O	S	0	0
			5	4	1		
3	A	1	Total	O	S	0	0
			5	4	1		
3	A	1	Total	O	S	0	0
			5	4	1		
3	A	1	Total	O	S	0	0
			5	4	1		
3	A	1	Total	O	S	0	0
			5	4	1		
3	B	1	Total	O	S	0	0
			5	4	1		
3	B	1	Total	O	S	0	0
			5	4	1		
3	B	1	Total	O	S	0	0
			5	4	1		
3	B	1	Total	O	S	0	0
			5	4	1		
3	C	1	Total	O	S	0	0
			5	4	1		
3	C	1	Total	O	S	0	0
			5	4	1		
3	C	1	Total	O	S	0	0
			5	4	1		

*Continued on next page...*

Continued from previous page...

Mol	Chain	Residues	Atoms			ZeroOcc	AltConf
3	C	1	Total	O	S	0	0
			5	4	1		
3	D	1	Total	O	S	0	0
			5	4	1		
3	D	1	Total	O	S	0	0
			5	4	1		

- Molecule 4 is DIMETHYL SULFOXIDE (three-letter code: DMS) (formula: C<sub>2</sub>H<sub>6</sub>OS).

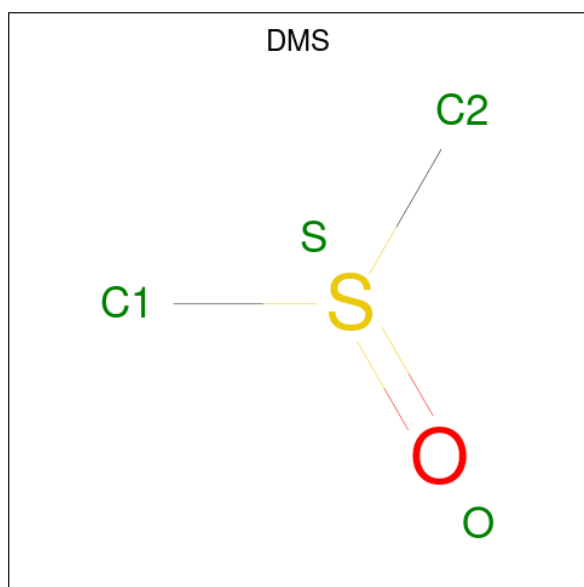

Mol	Chain	Residues	Atoms				ZeroOcc	AltConf
4	B	1	Total	C	O	S	0	0
			4	2	1	1		

- Molecule 5 is DI(HYDROXYETHYL)ETHER (three-letter code: PEG) (formula: C<sub>4</sub>H<sub>10</sub>O<sub>3</sub>).



Mol	Chain	Residues	Atoms	ZeroOcc	AltConf
5	B	1	Total C O 7 4 3	0	0
5	C	1	Total C O 7 4 3	0	0

- Molecule 6 is COBALT (II) ION (three-letter code: CO) (formula: Co).

Mol	Chain	Residues	Atoms	ZeroOcc	AltConf
6	B	2	Total Co 2 2	0	0
6	D	1	Total Co 1 1	0	0

- Molecule 7 is IMIDAZOLE (three-letter code: IMD) (formula: C<sub>3</sub>H<sub>5</sub>N<sub>2</sub>).



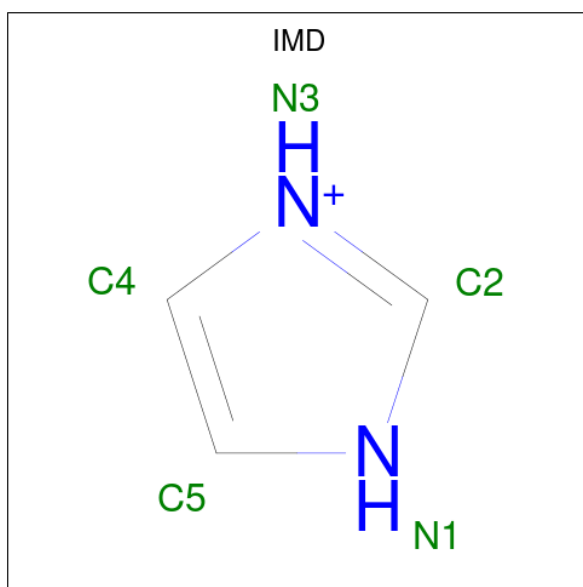

Mol	Chain	Residues	Atoms	ZeroOcc	AltConf
7	C	1	Total C N 5 3 2	0	0

- Molecule 8 is OXYGEN MOLECULE (three-letter code: OXY) (formula: O<sub>2</sub>).

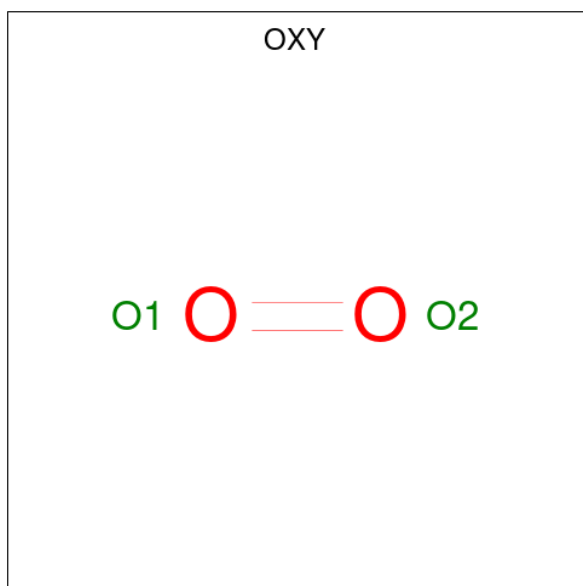

Mol	Chain	Residues	Atoms	ZeroOcc	AltConf
8	C	1	Total O 2 2	0	0

- Molecule 9 is water.

Mol	Chain	Residues	Atoms		ZeroOcc	AltConf
9	A	274	Total 274	O 274	0	0
9	B	275	Total 275	O 275	0	0
9	C	266	Total 266	O 266	0	0
9	D	207	Total 207	O 207	0	0

### 3 Residue-property plots [i](#)

These plots are drawn for all protein, RNA, DNA and oligosaccharide chains in the entry. The first graphic for a chain summarises the proportions of the various outlier classes displayed in the second graphic. The second graphic shows the sequence view annotated by issues in geometry and electron density. Residues are color-coded according to the number of geometric quality criteria for which they contain at least one outlier: green = 0, yellow = 1, orange = 2 and red = 3 or more. A red dot above a residue indicates a poor fit to the electron density ( $RSRZ > 2$ ). Stretches of 2 or more consecutive residues without any outlier are shown as a green connector. Residues present in the sample, but not in the model, are shown in grey.

- Molecule 1: Cytochrome P450

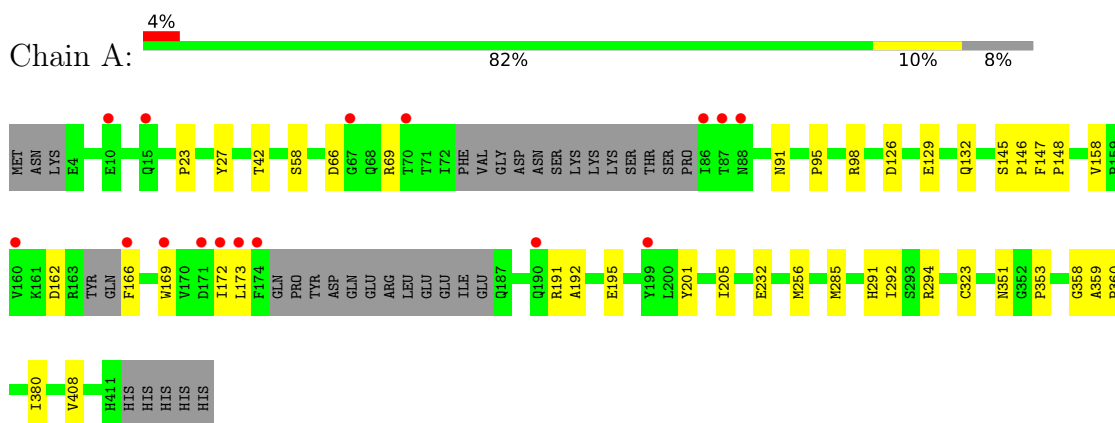

- Molecule 1: Cytochrome P450

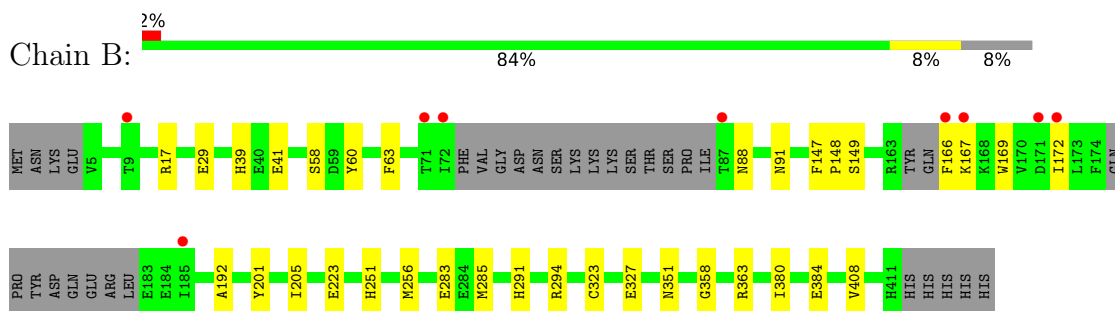

- Molecule 1: Cytochrome P450

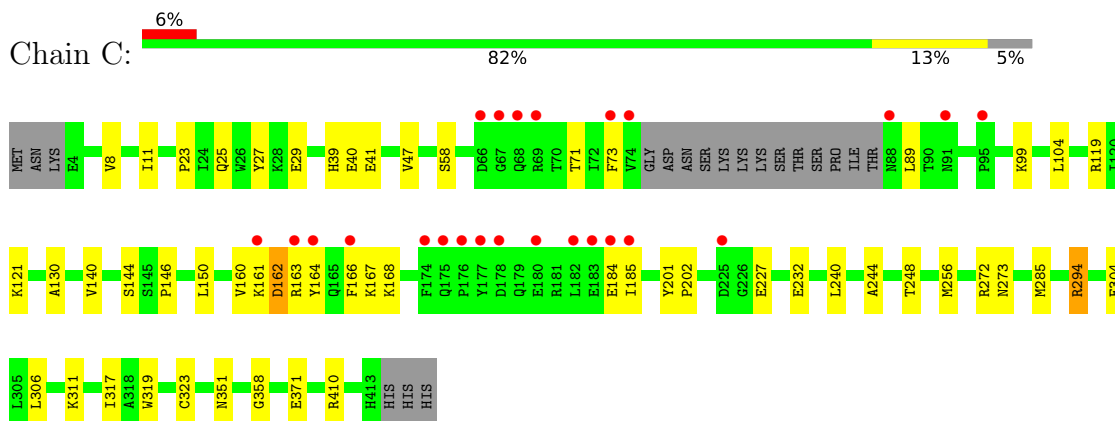

- Molecule 1: Cytochrome P450

Chain D:  4% 85% 10% 5%

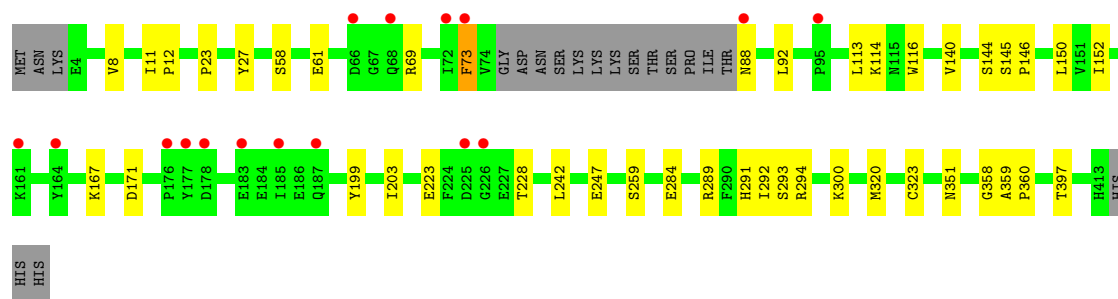

## 4 Data and refinement statistics i

Property	Value	Source
Space group	P 1	Depositor
Cell constants a, b, c, $\alpha$ , $\beta$ , $\gamma$	63.69Å 82.87Å 84.86Å 95.36° 90.00° 90.00°	Depositor
Resolution (Å)	25.82 – 1.70 25.81 – 1.70	Depositor EDS
% Data completeness (in resolution range)	88.9 (25.82-1.70) 88.9 (25.81-1.70)	Depositor EDS
$R_{merge}$	0.07	Depositor
$R_{sym}$	(Not available)	Depositor
$\langle I/\sigma(I) \rangle$ <sup>1</sup>	2.50 (at 1.70Å)	Xtrriage
Refinement program	REFMAC 5.8.0258	Depositor
R, $R_{free}$	0.169 , 0.206 0.180 , 0.216	Depositor DCC
$R_{free}$ test set	8441 reflections (5.00%)	wwPDB-VP
Wilson B-factor (Å <sup>2</sup> )	18.3	Xtrriage
Anisotropy	0.024	Xtrriage
Bulk solvent $k_{sol}$ (e/Å <sup>3</sup> ), $B_{sol}$ (Å <sup>2</sup> )	0.36 , 27.0	EDS
L-test for twinning <sup>2</sup>	$\langle  L  \rangle = 0.49$ , $\langle L^2 \rangle = 0.32$	Xtrriage
Estimated twinning fraction	0.389 for h,-k,-l 0.013 for -h,l,k 0.013 for -h,-l,-k	Xtrriage
$F_o, F_c$ correlation	0.96	EDS
Total number of atoms	14013	wwPDB-VP
Average B, all atoms (Å <sup>2</sup> )	24.0	wwPDB-VP

Xtrriage's analysis on translational NCS is as follows: *The largest off-origin peak in the Patterson function is 5.15% of the height of the origin peak. No significant pseudotranslation is detected.*

<sup>1</sup>Intensities estimated from amplitudes.

<sup>2</sup>Theoretical values of  $\langle |L| \rangle$ ,  $\langle L^2 \rangle$  for acentric reflections are 0.5, 0.333 respectively for untwinned datasets, and 0.375, 0.2 for perfectly twinned datasets.

## 5 Model quality [i](#)

### 5.1 Standard geometry [i](#)

Bond lengths and bond angles in the following residue types are not validated in this section: IMD, SO4, HEM, DMS, CO, PEG, OXY

The Z score for a bond length (or angle) is the number of standard deviations the observed value is removed from the expected value. A bond length (or angle) with  $|Z| > 5$  is considered an outlier worth inspection. RMSZ is the root-mean-square of all Z scores of the bond lengths (or angles).

Mol	Chain	Bond lengths		Bond angles	
		RMSZ	# Z  >5	RMSZ	# Z  >5
1	A	0.74	0/3186	0.83	0/4324
1	B	0.75	0/3214	0.83	0/4359
1	C	0.76	1/3343 (0.0%)	0.85	0/4537
1	D	0.75	0/3360	0.85	0/4559
All	All	0.75	1/13103 (0.0%)	0.84	0/17779

All (1) bond length outliers are listed below:

Mol	Chain	Res	Type	Atoms	Z	Observed(Å)	Ideal(Å)
1	C	40	GLU	CD-OE2	5.24	1.31	1.25

There are no bond angle outliers.

There are no chirality outliers.

There are no planarity outliers.

### 5.2 Too-close contacts [i](#)

In the following table, the Non-H and H(model) columns list the number of non-hydrogen atoms and hydrogen atoms in the chain respectively. The H(added) column lists the number of hydrogen atoms added and optimized by MolProbity. The Clashes column lists the number of clashes within the asymmetric unit, whereas Symm-Clashes lists symmetry-related clashes.

Mol	Chain	Non-H	H(model)	H(added)	Clashes	Symm-Clashes
1	A	3086	0	2970	23	1
1	B	3111	0	2998	26	0
1	C	3246	0	3129	51	1
1	D	3263	0	3160	32	0
2	A	43	0	30	1	0
2	B	43	0	30	1	0

*Continued on next page...*

Continued from previous page...

Mol	Chain	Non-H	H(model)	H(added)	Clashes	Symm-Clashes
2	C	43	0	30	3	0
2	D	43	0	30	2	0
3	A	30	0	0	3	0
3	B	25	0	0	1	0
3	C	20	0	0	1	0
3	D	10	0	0	0	0
4	B	4	0	6	4	0
5	B	7	0	10	0	0
5	C	7	0	10	1	0
6	B	2	0	0	0	0
6	D	1	0	0	0	0
7	C	5	0	5	0	0
8	C	2	0	0	0	0
9	A	274	0	0	2	0
9	B	275	0	0	4	0
9	C	266	0	0	9	0
9	D	207	0	0	3	0
All	All	14013	0	12408	136	1

The all-atom clashscore is defined as the number of clashes found per 1000 atoms (including hydrogen atoms). The all-atom clashscore for this structure is 5.

All (136) close contacts within the same asymmetric unit are listed below, sorted by their clash magnitude.

Atom-1	Atom-2	Interatomic distance (Å)	Clash overlap (Å)
1:C:163:ARG:O	1:C:167:LYS:N	2.08	0.85
1:B:39:HIS:CE1	1:B:41:GLU:HG2	2.18	0.79
1:C:163:ARG:O	1:C:167:LYS:CB	2.30	0.79
4:B:504:DMS:H13	9:B:764:HOH:O	1.84	0.78
1:A:66:ASP:HB3	1:A:91:ASN:O	1.86	0.76
1:D:58:SER:HB3	1:D:351:ASN:HD22	1.50	0.74
1:C:371:GLU:OE1	9:C:601:HOH:O	2.06	0.73
1:D:199:TYR:CZ	1:D:203:ILE:HD11	2.23	0.73
1:C:163:ARG:O	1:C:167:LYS:HB3	1.89	0.72
1:B:29:GLU:HG3	9:B:618:HOH:O	1.90	0.70
1:C:121:LYS:HE2	9:C:601:HOH:O	1.91	0.70
1:C:304:GLU:OE1	9:C:602:HOH:O	2.09	0.70
1:C:162:ASP:O	1:C:166:PHE:N	2.28	0.65
1:D:199:TYR:CZ	1:D:203:ILE:CD1	2.79	0.65
1:C:73:PHE:HZ	1:C:319:TRP:CZ3	2.16	0.64
1:A:98:ARG:HD3	3:A:502:SO4:O2	1.98	0.63

Continued on next page...

*Continued from previous page...*

Atom-1	Atom-2	Interatomic distance (Å)	Clash overlap (Å)
1:D:167:LYS:NZ	1:D:171:ASP:OD2	2.30	0.63
1:C:58[B]:SER:HB3	1:C:351:ASN:HD22	1.63	0.63
1:A:95:PRO:HB3	1:B:327[A]:GLU:HG3	1.81	0.63
1:C:244:ALA:HB2	5:C:505:PEG:H32	1.80	0.62
1:C:25:GLN:NE2	9:C:605:HOH:O	2.31	0.62
1:A:172:ILE:HG22	1:A:192:ALA:HB2	1.81	0.61
1:B:251:HIS:HE1	1:B:291:HIS:O	1.82	0.61
1:B:149:SER:CB	1:B:167:LYS:HG2	2.31	0.60
1:B:172:ILE:HG22	1:B:192:ALA:HB1	1.84	0.60
1:C:273:ASN:ND2	3:C:507:SO4:O1	2.34	0.59
1:B:149:SER:HB2	1:B:167:LYS:HG2	1.85	0.58
1:B:58:SER:HB3	1:B:351:ASN:HD22	1.68	0.58
1:C:73:PHE:CZ	1:C:319:TRP:CZ3	2.91	0.58
4:B:504:DMS:C1	9:B:764:HOH:O	2.46	0.57
1:C:160:VAL:HG12	1:C:161:LYS:HG2	1.86	0.57
1:D:150:LEU:HD21	1:D:167:LYS:HD3	1.85	0.57
1:C:73:PHE:CZ	1:C:294:ARG:HG2	2.40	0.56
1:D:69:ARG:NH1	9:D:604:HOH:O	2.37	0.56
1:A:58:SER:HB3	1:A:351:ASN:HD22	1.70	0.56
1:A:380:ILE:HG22	1:A:408:VAL:HG12	1.88	0.55
1:C:8:VAL:HG23	1:C:71:THR:HB	1.88	0.55
1:D:73:PHE:CE2	1:D:397:THR:C	2.80	0.55
1:D:199:TYR:CE2	1:D:203:ILE:CD1	2.90	0.55
1:C:8:VAL:CG2	1:C:71:THR:HB	2.37	0.55
1:C:150:LEU:O	1:C:163:ARG:HD3	2.08	0.54
1:B:256:MET:HG3	1:B:285:MET:HG3	1.90	0.53
1:C:358:GLY:HA3	2:C:501:HEM:C3C	2.43	0.53
1:A:358:GLY:HA3	2:A:501:HEM:C3C	2.44	0.52
2:C:501:HEM:HMC1	2:C:501:HEM:HBC2	1.90	0.52
1:B:17:ARG:NH2	3:B:502:SO4:O4	2.41	0.52
1:C:119:ARG:NH2	9:C:613:HOH:O	2.43	0.52
1:A:126:ASP:OD2	9:A:601:HOH:O	2.18	0.52
1:A:145[A]:SER:OG	1:A:146:PRO:HD3	2.09	0.52
1:C:89:LEU:HD22	1:C:104:LEU:HD12	1.92	0.51
1:D:11:ILE:HB	1:D:12:PRO:HD3	1.92	0.51
1:C:163:ARG:O	1:C:167:LYS:CA	2.58	0.51
1:D:247:GLU:HG2	9:D:750:HOH:O	2.08	0.51
1:C:162:ASP:N	1:C:162:ASP:OD1	2.44	0.51
1:C:184:GLU:HG3	1:C:185:ILE:HG23	1.93	0.51
1:C:23:PRO:HG2	1:C:27:TYR:CZ	2.46	0.50
1:C:99:LYS:HD2	1:C:227:GLU:OE1	2.11	0.50

*Continued on next page...*



*Continued from previous page...*

Atom-1	Atom-2	Interatomic distance (Å)	Clash overlap (Å)
1:C:8:VAL:HG13	1:C:11:ILE:HD12	1.93	0.50
1:A:98:ARG:CD	3:A:502:SO4:O2	2.60	0.50
1:A:166:PHE:HA	1:A:169:TRP:CD1	2.46	0.50
1:B:384:GLU:H	4:B:504:DMS:C2	2.25	0.50
1:B:201:TYR:CE2	1:B:205:ILE:HD11	2.47	0.49
1:D:23:PRO:HG2	1:D:27:TYR:CZ	2.48	0.49
1:B:384:GLU:H	4:B:504:DMS:H22	1.78	0.49
1:A:158:VAL:CG1	1:A:162:ASP:HB2	2.43	0.49
1:D:358:GLY:HA3	2:D:501:HEM:C3C	2.48	0.49
1:B:172:ILE:HG22	1:B:192:ALA:CB	2.43	0.48
1:A:256:MET:HG3	1:A:285:MET:HG3	1.94	0.48
1:B:358:GLY:HA3	2:B:501:HEM:C3C	2.48	0.48
1:D:150:LEU:CD2	1:D:167:LYS:HD3	2.42	0.48
1:C:164:TYR:CD1	1:C:167:LYS:HE2	2.49	0.48
1:B:251:HIS:CE1	1:B:291:HIS:O	2.66	0.48
1:D:8:VAL:CG2	1:D:73:PHE:HB3	2.43	0.47
1:D:359:ALA:HB3	1:D:360:PRO:HD3	1.96	0.47
1:D:259:SER:HB2	1:D:289:ARG:HG3	1.97	0.47
1:C:47:VAL:HG11	1:C:306:LEU:HD13	1.97	0.47
1:D:223:GLU:HG3	1:D:228:THR:HG22	1.96	0.47
1:D:293[A]:SER:OG	1:D:320:MET:CE	2.63	0.47
1:C:164:TYR:O	1:C:168:LYS:HB2	2.14	0.47
1:C:227:GLU:HA	9:C:756:HOH:O	2.15	0.47
1:C:311:LYS:NZ	9:C:619:HOH:O	2.47	0.47
1:D:88:ASN:O	1:D:92:LEU:HG	2.15	0.46
1:B:380:ILE:HG22	1:B:408:VAL:HG12	1.98	0.46
1:B:283:GLU:OE2	1:B:363[B]:ARG:CD	2.64	0.46
1:A:359:ALA:HB3	1:A:360:PRO:HD3	1.98	0.45
1:C:25:GLN:O	1:C:29:GLU:HG3	2.16	0.45
1:D:73:PHE:HE2	1:D:397:THR:O	2.00	0.45
1:C:8:VAL:CG1	1:C:8:VAL:O	2.64	0.45
1:C:184:GLU:HG3	1:C:185:ILE:N	2.31	0.45
1:D:113:LEU:HD22	1:D:116:TRP:CZ3	2.52	0.45
1:B:223:GLU:HG2	9:B:613:HOH:O	2.16	0.45
1:C:39:HIS:CE1	1:C:41:GLU:CG	3.00	0.45
1:B:166:PHE:HA	1:B:169:TRP:CD1	2.53	0.44
1:C:130:ALA:HB3	9:C:682:HOH:O	2.16	0.44
1:A:23:PRO:HG2	1:A:27:TYR:CZ	2.52	0.44
1:A:129:GLU:O	1:A:132:GLN:HG2	2.18	0.44
1:C:146:PRO:HB3	1:C:167:LYS:HZ3	1.83	0.44
1:D:140:VAL:HA	1:D:144:SER:OG	2.18	0.44

*Continued on next page...*

Continued from previous page...

Atom-1	Atom-2	Interatomic distance (Å)	Clash overlap (Å)
1:D:223:GLU:HB3	9:D:657:HOH:O	2.18	0.44
1:D:284:GLU:HA	1:D:284:GLU:OE1	2.17	0.44
1:A:42:THR:O	1:A:69:ARG:NH2	2.50	0.43
2:D:501:HEM:HMC1	2:D:501:HEM:HBC2	2.00	0.43
1:D:61:GLU:O	1:D:300:LYS:HD3	2.18	0.43
1:C:248:THR:HG23	9:C:797:HOH:O	2.18	0.43
1:C:71:THR:HG21	1:C:317:ILE:HD11	2.00	0.43
1:B:283:GLU:OE2	1:B:363[B]:ARG:HD3	2.19	0.43
1:D:152:ILE:HG21	1:D:242:LEU:CD2	2.49	0.43
1:C:73:PHE:CE1	1:C:294:ARG:HD3	2.54	0.43
1:A:191:ARG:O	1:A:195:GLU:HG3	2.19	0.43
1:A:129:GLU:HG3	9:A:809:HOH:O	2.18	0.43
1:A:201:TYR:CE2	1:A:205:ILE:HD11	2.53	0.42
1:B:39:HIS:CE1	1:B:41:GLU:CG	2.96	0.42
1:C:164:TYR:O	1:C:168:LYS:N	2.49	0.42
1:C:272:ARG:HH11	1:C:272:ARG:HG3	1.83	0.42
1:B:201:TYR:CZ	1:B:205:ILE:HD11	2.54	0.42
1:C:58[A]:SER:HB2	1:C:351:ASN:HD22	1.84	0.42
1:C:164:TYR:CE1	1:C:167:LYS:HE2	2.54	0.42
1:D:73:PHE:CE2	1:D:292:ILE:HB	2.54	0.42
1:D:114:LYS:HA	1:D:114:LYS:HD2	1.88	0.42
1:A:147:PHE:HB3	1:A:148:PRO:HD3	2.01	0.42
1:A:291:HIS:HA	1:A:292:ILE:HA	1.86	0.42
1:C:73:PHE:HE1	1:C:319:TRP:CH2	2.38	0.42
1:C:240:LEU:HD23	1:C:240:LEU:C	2.41	0.41
1:B:88:ASN:OD1	1:B:91:ASN:HB2	2.20	0.41
1:C:201:TYR:N	1:C:202:PRO:HD2	2.35	0.41
1:D:291:HIS:HA	1:D:292:ILE:HA	1.88	0.41
1:A:353:PRO:HB3	3:A:502:SO4:O1	2.20	0.41
1:C:146:PRO:HB3	1:C:167:LYS:NZ	2.35	0.41
1:D:145[A]:SER:OG	1:D:146:PRO:HD3	2.19	0.41
1:C:140:VAL:HA	1:C:144:SER:OG	2.21	0.41
1:D:73:PHE:CZ	1:D:397:THR:HA	2.56	0.41
1:C:256:MET:HG3	1:C:285:MET:HG3	2.02	0.40
2:C:501:HEM:HBC2	2:C:501:HEM:CMC	2.51	0.40
1:B:60:TYR:HA	1:B:63:PHE:O	2.21	0.40
1:B:147:PHE:HB3	1:B:148:PRO:HD3	2.02	0.40
1:D:8:VAL:HG22	1:D:73:PHE:HB3	2.03	0.40

All (1) symmetry-related close contacts are listed below. The label for Atom-2 includes the symmetry operator and encoded unit-cell translations to be applied.

Atom-1	Atom-2	Interatomic distance (Å)	Clash overlap (Å)
1:A:232:GLU:OE2	1:C:232:GLU:OE2[1_545]	2.12	0.08

### 5.3 Torsion angles [i](#)

#### 5.3.1 Protein backbone [i](#)

In the following table, the Percentiles column shows the percent Ramachandran outliers of the chain as a percentile score with respect to all X-ray entries followed by that with respect to entries of similar resolution.

The Analysed column shows the number of residues for which the backbone conformation was analysed, and the total number of residues.

Mol	Chain	Analysed	Favoured	Allowed	Outliers	Percentiles	
1	A	381/416 (92%)	369 (97%)	12 (3%)	0	100	100
1	B	384/416 (92%)	371 (97%)	13 (3%)	0	100	100
1	C	397/416 (95%)	382 (96%)	15 (4%)	0	100	100
1	D	397/416 (95%)	383 (96%)	14 (4%)	0	100	100
All	All	1559/1664 (94%)	1505 (96%)	54 (4%)	0	100	100

There are no Ramachandran outliers to report.

#### 5.3.2 Protein sidechains [i](#)

In the following table, the Percentiles column shows the percent sidechain outliers of the chain as a percentile score with respect to all X-ray entries followed by that with respect to entries of similar resolution.

The Analysed column shows the number of residues for which the sidechain conformation was analysed, and the total number of residues.

Mol	Chain	Analysed	Rotameric	Outliers	Percentiles	
1	A	334/377 (89%)	331 (99%)	3 (1%)	78	70
1	B	336/377 (89%)	334 (99%)	2 (1%)	86	80
1	C	352/377 (93%)	348 (99%)	4 (1%)	73	63
1	D	356/377 (94%)	353 (99%)	3 (1%)	81	74
All	All	1378/1508 (91%)	1366 (99%)	12 (1%)	78	70

All (12) residues with a non-rotameric sidechain are listed below:

Mol	Chain	Res	Type
1	A	173	LEU
1	A	294	ARG
1	A	323	CYS
1	B	294	ARG
1	B	323	CYS
1	C	162	ASP
1	C	294	ARG
1	C	323	CYS
1	C	410	ARG
1	D	73	PHE
1	D	294	ARG
1	D	323	CYS

Sometimes sidechains can be flipped to improve hydrogen bonding and reduce clashes. All (19) such sidechains are listed below:

Mol	Chain	Res	Type
1	A	198	GLN
1	A	351	ASN
1	B	132	GLN
1	B	198	GLN
1	B	251	HIS
1	B	351	ASN
1	C	15	GLN
1	C	33	ASN
1	C	55	GLN
1	C	198	GLN
1	C	301	GLN
1	C	351	ASN
1	C	379	HIS
1	D	122	GLN
1	D	175	GLN
1	D	179	GLN
1	D	187	GLN
1	D	198	GLN
1	D	351	ASN

### 5.3.3 RNA [i](#)

There are no RNA molecules in this entry.

## 5.4 Non-standard residues in protein, DNA, RNA chains [i](#)

There are no non-standard protein/DNA/RNA residues in this entry.

## 5.5 Carbohydrates [i](#)

There are no monosaccharides in this entry.

## 5.6 Ligand geometry [i](#)

Of 29 ligands modelled in this entry, 3 are monoatomic - leaving 26 for Mogul analysis.

In the following table, the Counts columns list the number of bonds (or angles) for which Mogul statistics could be retrieved, the number of bonds (or angles) that are observed in the model and the number of bonds (or angles) that are defined in the Chemical Component Dictionary. The Link column lists molecule types, if any, to which the group is linked. The Z score for a bond length (or angle) is the number of standard deviations the observed value is removed from the expected value. A bond length (or angle) with  $|Z| > 2$  is considered an outlier worth inspection. RMSZ is the root-mean-square of all Z scores of the bond lengths (or angles).

Mol	Type	Chain	Res	Link	Bond lengths			Bond angles		
					Counts	RMSZ	# Z  > 2	Counts	RMSZ	# Z  > 2
2	HEM	C	501	9,1	41,50,50	1.51	6 (14%)	45,82,82	1.79	11 (24%)
3	SO4	A	503	-	4,4,4	0.31	0	6,6,6	0.07	0
3	SO4	A	502	-	4,4,4	0.37	0	6,6,6	0.23	0
7	IMD	C	504	-	3,5,5	0.31	0	4,5,5	0.71	0
3	SO4	C	503	-	4,4,4	0.38	0	6,6,6	0.08	0
3	SO4	C	502	-	4,4,4	0.30	0	6,6,6	0.21	0
3	SO4	B	502	-	4,4,4	0.28	0	6,6,6	0.15	0
3	SO4	B	505	-	4,4,4	0.32	0	6,6,6	0.10	0
2	HEM	B	501	9,1	41,50,50	1.44	5 (12%)	45,82,82	1.86	13 (28%)
3	SO4	B	503	-	4,4,4	0.33	0	6,6,6	0.13	0
3	SO4	B	509	-	4,4,4	0.38	0	6,6,6	0.10	0
5	PEG	C	505	-	6,6,6	0.27	0	5,5,5	0.16	0
3	SO4	A	505	-	4,4,4	0.33	0	6,6,6	0.11	0
2	HEM	D	501	9,1	41,50,50	1.50	8 (19%)	45,82,82	1.92	13 (28%)
3	SO4	B	510	-	4,4,4	0.34	0	6,6,6	0.12	0
3	SO4	D	503	-	4,4,4	0.37	0	6,6,6	0.12	0
3	SO4	D	502	-	4,4,4	0.29	0	6,6,6	0.14	0
3	SO4	A	504	-	4,4,4	0.32	0	6,6,6	0.06	0
3	SO4	C	506	-	4,4,4	0.33	0	6,6,6	0.13	0
8	OXY	C	508	-	1,1,1	0.16	0	-		
2	HEM	A	501	9,1	41,50,50	1.42	6 (14%)	45,82,82	1.95	9 (20%)

Mol	Type	Chain	Res	Link	Bond lengths			Bond angles		
					Counts	RMSZ	# Z  > 2	Counts	RMSZ	# Z  > 2
3	SO4	C	507	-	4,4,4	0.25	0	6,6,6	0.32	0
3	SO4	A	507	-	4,4,4	0.33	0	6,6,6	0.07	0
4	DMS	B	504	-	3,3,3	0.20	0	3,3,3	0.33	0
3	SO4	A	506	-	4,4,4	0.35	0	6,6,6	0.15	0
5	PEG	B	506	-	6,6,6	0.18	0	5,5,5	0.13	0

In the following table, the Chirals column lists the number of chiral outliers, the number of chiral centers analysed, the number of these observed in the model and the number defined in the Chemical Component Dictionary. Similar counts are reported in the Torsion and Rings columns. '-' means no outliers of that kind were identified.

Mol	Type	Chain	Res	Link	Chirals	Torsions	Rings
2	HEM	C	501	9,1	-	1/12/54/54	-
2	HEM	B	501	9,1	-	1/12/54/54	-
7	IMD	C	504	-	-	-	0/1/1/1
2	HEM	A	501	9,1	-	2/12/54/54	-
5	PEG	C	505	-	-	3/4/4/4	-
2	HEM	D	501	9,1	-	1/12/54/54	-
5	PEG	B	506	-	-	3/4/4/4	-

All (25) bond length outliers are listed below:

Mol	Chain	Res	Type	Atoms	Z	Observed(Å)	Ideal(Å)
2	C	501	HEM	C4D-ND	-4.23	1.33	1.40
2	B	501	HEM	C1B-NB	-4.10	1.33	1.40
2	A	501	HEM	CAA-C2A	3.76	1.57	1.52
2	B	501	HEM	C4D-ND	-3.75	1.33	1.40
2	A	501	HEM	C4D-ND	-3.53	1.34	1.40
2	D	501	HEM	CHB-C1B	3.47	1.43	1.35
2	D	501	HEM	C4D-ND	-3.45	1.34	1.40
2	C	501	HEM	C4D-C3D	3.19	1.50	1.45
2	B	501	HEM	CAA-C2A	2.99	1.56	1.52
2	B	501	HEM	C3C-C2C	-2.90	1.36	1.40
2	A	501	HEM	C1B-NB	-2.83	1.35	1.40
2	C	501	HEM	CHB-C1B	2.78	1.42	1.35
2	D	501	HEM	C1B-NB	-2.70	1.35	1.40
2	D	501	HEM	C4A-NA	2.67	1.41	1.36
2	B	501	HEM	C4B-NB	-2.57	1.33	1.38
2	A	501	HEM	C3C-CAC	2.43	1.52	1.47
2	C	501	HEM	C1D-C2D	2.37	1.49	1.44
2	D	501	HEM	C3B-C4B	2.30	1.49	1.44
2	A	501	HEM	C4D-C3D	2.25	1.48	1.45

*Continued on next page...*

Continued from previous page...

Mol	Chain	Res	Type	Atoms	Z	Observed(Å)	Ideal(Å)
2	C	501	HEM	CMD-C2D	2.23	1.55	1.50
2	D	501	HEM	CAA-C2A	2.10	1.55	1.52
2	D	501	HEM	C1A-CHA	-2.07	1.35	1.41
2	D	501	HEM	C4B-NB	-2.06	1.34	1.38
2	C	501	HEM	CBA-CGA	2.05	1.55	1.50
2	A	501	HEM	FE-NB	2.00	2.06	1.96

All (46) bond angle outliers are listed below:

Mol	Chain	Res	Type	Atoms	Z	Observed(°)	Ideal(°)
2	A	501	HEM	C1B-NB-C4B	5.54	110.80	105.07
2	A	501	HEM	CHC-C4B-NB	5.40	130.29	124.43
2	C	501	HEM	C1B-NB-C4B	4.71	109.93	105.07
2	B	501	HEM	C1B-NB-C4B	4.57	109.80	105.07
2	D	501	HEM	C1B-NB-C4B	4.30	109.51	105.07
2	A	501	HEM	O2A-CGA-CBA	3.93	126.65	114.03
2	C	501	HEM	O2A-CGA-CBA	3.86	126.43	114.03
2	B	501	HEM	CHB-C1B-NB	3.81	129.09	124.38
2	B	501	HEM	CHD-C1D-ND	3.72	128.47	124.43
2	D	501	HEM	CHA-C4D-ND	3.62	128.85	124.38
2	B	501	HEM	C4B-C3B-C2B	-3.54	104.30	107.11
2	D	501	HEM	CHC-C4B-NB	3.45	128.18	124.43
2	D	501	HEM	O2A-CGA-CBA	3.45	125.11	114.03
2	D	501	HEM	C4B-C3B-C2B	-3.45	104.38	107.11
2	D	501	HEM	CHA-C4D-C3D	-3.44	118.88	125.33
2	C	501	HEM	CHB-C1B-NB	3.42	128.61	124.38
2	B	501	HEM	CHC-C4B-NB	3.37	128.09	124.43
2	B	501	HEM	CHD-C1D-C2D	-3.35	119.74	124.98
2	D	501	HEM	CMD-C2D-C1D	3.34	130.13	125.04
2	A	501	HEM	CHB-C1B-NB	3.31	128.47	124.38
2	A	501	HEM	CHD-C1D-ND	3.20	127.91	124.43
2	C	501	HEM	O1A-CGA-CBA	-3.10	113.12	123.08
2	C	501	HEM	CHC-C4B-NB	2.89	127.58	124.43
2	A	501	HEM	O1D-CGD-CBD	-2.89	113.80	123.08
2	C	501	HEM	CHD-C1D-ND	2.77	127.44	124.43
2	A	501	HEM	C3B-C2B-C1B	2.70	108.49	106.49
2	A	501	HEM	O1A-CGA-CBA	-2.70	114.41	123.08
2	C	501	HEM	C2C-C3C-C4C	2.64	108.74	106.90
2	D	501	HEM	O1A-CGA-CBA	-2.61	114.70	123.08
2	B	501	HEM	O2A-CGA-O1A	-2.53	116.99	123.30
2	C	501	HEM	C3B-C2B-C1B	2.51	108.35	106.49
2	D	501	HEM	C3C-C4C-NC	-2.49	106.25	110.94

Continued on next page...

Continued from previous page...

Mol	Chain	Res	Type	Atoms	Z	Observed(°)	Ideal(°)
2	B	501	HEM	C3B-C2B-C1B	2.48	108.33	106.49
2	D	501	HEM	CMC-C2C-C3C	2.41	129.19	124.68
2	D	501	HEM	CAD-C3D-C4D	2.40	128.85	124.66
2	D	501	HEM	C2C-C3C-C4C	2.35	108.54	106.90
2	D	501	HEM	CMA-C3A-C4A	-2.30	124.93	128.46
2	B	501	HEM	C2C-C3C-C4C	2.25	108.47	106.90
2	C	501	HEM	CHD-C1D-C2D	-2.23	121.50	124.98
2	B	501	HEM	CAD-C3D-C4D	2.18	128.47	124.66
2	A	501	HEM	CHD-C1D-C2D	-2.14	121.64	124.98
2	B	501	HEM	CMC-C2C-C3C	2.08	128.57	124.68
2	B	501	HEM	O1D-CGD-CBD	-2.07	116.44	123.08
2	C	501	HEM	C3C-C4C-NC	-2.05	107.08	110.94
2	C	501	HEM	CHA-C4D-ND	2.01	126.86	124.38
2	B	501	HEM	O2D-CGD-CBD	2.01	120.47	114.03

There are no chirality outliers.

All (11) torsion outliers are listed below:

Mol	Chain	Res	Type	Atoms
5	C	505	PEG	O1-C1-C2-O2
5	B	506	PEG	O2-C3-C4-O4
5	B	506	PEG	C4-C3-O2-C2
5	C	505	PEG	C4-C3-O2-C2
5	C	505	PEG	O2-C3-C4-O4
2	A	501	HEM	CAA-CBA-CGA-O1A
2	A	501	HEM	CAA-CBA-CGA-O2A
2	B	501	HEM	CAD-CBD-CGD-O2D
2	C	501	HEM	CAA-CBA-CGA-O2A
5	B	506	PEG	O1-C1-C2-O2
2	D	501	HEM	CAD-CBD-CGD-O2D

There are no ring outliers.

9 monomers are involved in 17 short contacts:

Mol	Chain	Res	Type	Clashes	Symm-Clashes
2	C	501	HEM	3	0
3	A	502	SO4	3	0
3	B	502	SO4	1	0
2	B	501	HEM	1	0
5	C	505	PEG	1	0
2	D	501	HEM	2	0

Continued on next page...



Continued from previous page...

Mol	Chain	Res	Type	Clashes	Symm-Clashes
2	A	501	HEM	1	0
3	C	507	SO4	1	0
4	B	504	DMS	4	0

The following is a two-dimensional graphical depiction of Mogul quality analysis of bond lengths, bond angles, torsion angles, and ring geometry for all instances of the Ligand of Interest. In addition, ligands with molecular weight > 250 and outliers as shown on the validation Tables will also be included. For torsion angles, if less than 5% of the Mogul distribution of torsion angles is within 10 degrees of the torsion angle in question, then that torsion angle is considered an outlier. Any bond that is central to one or more torsion angles identified as an outlier by Mogul will be highlighted in the graph. For rings, the root-mean-square deviation (RMSD) between the ring in question and similar rings identified by Mogul is calculated over all ring torsion angles. If the average RMSD is greater than 60 degrees and the minimal RMSD between the ring in question and any Mogul-identified rings is also greater than 60 degrees, then that ring is considered an outlier. The outliers are highlighted in purple. The color gray indicates Mogul did not find sufficient equivalents in the CSD to analyse the geometry.

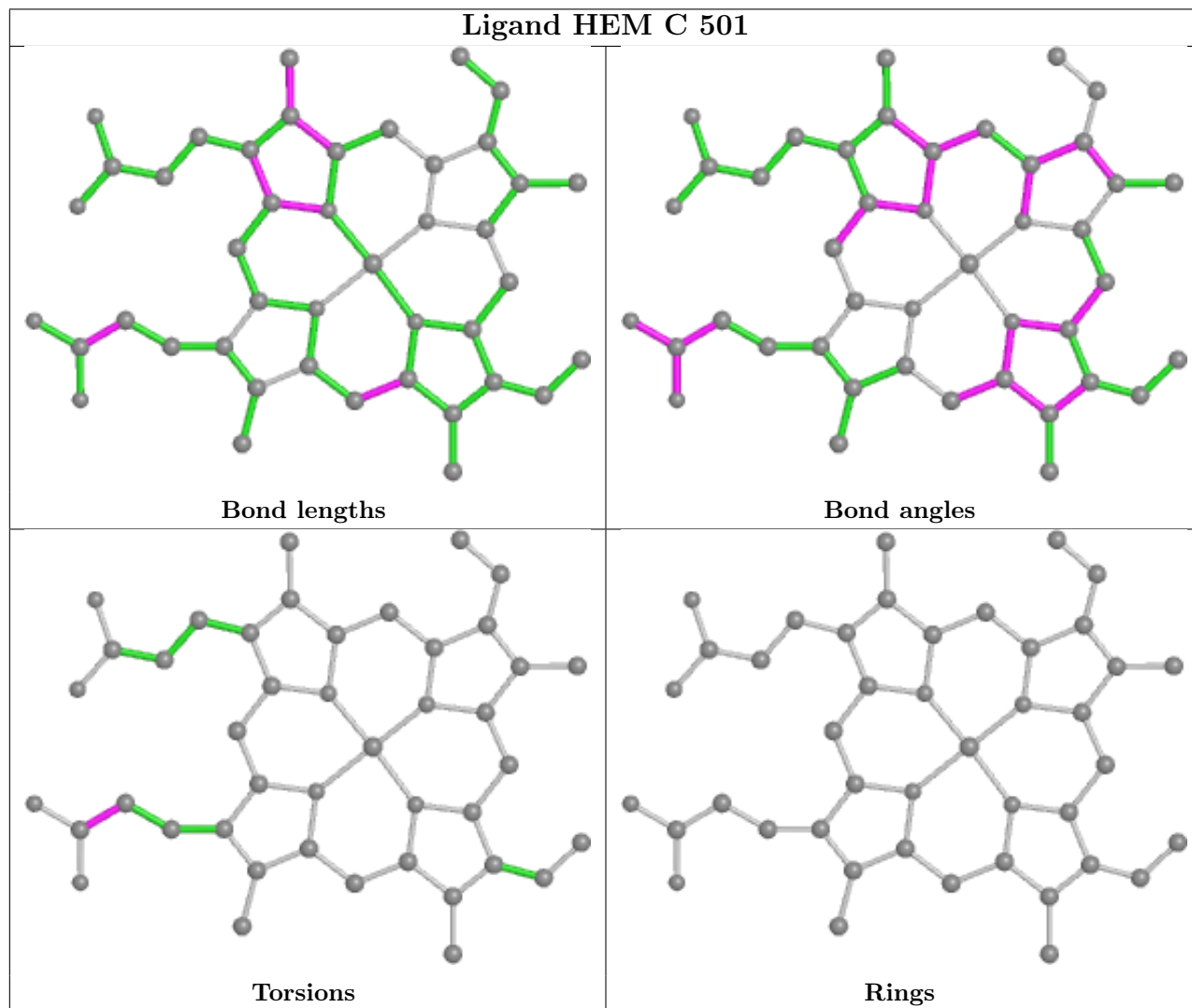

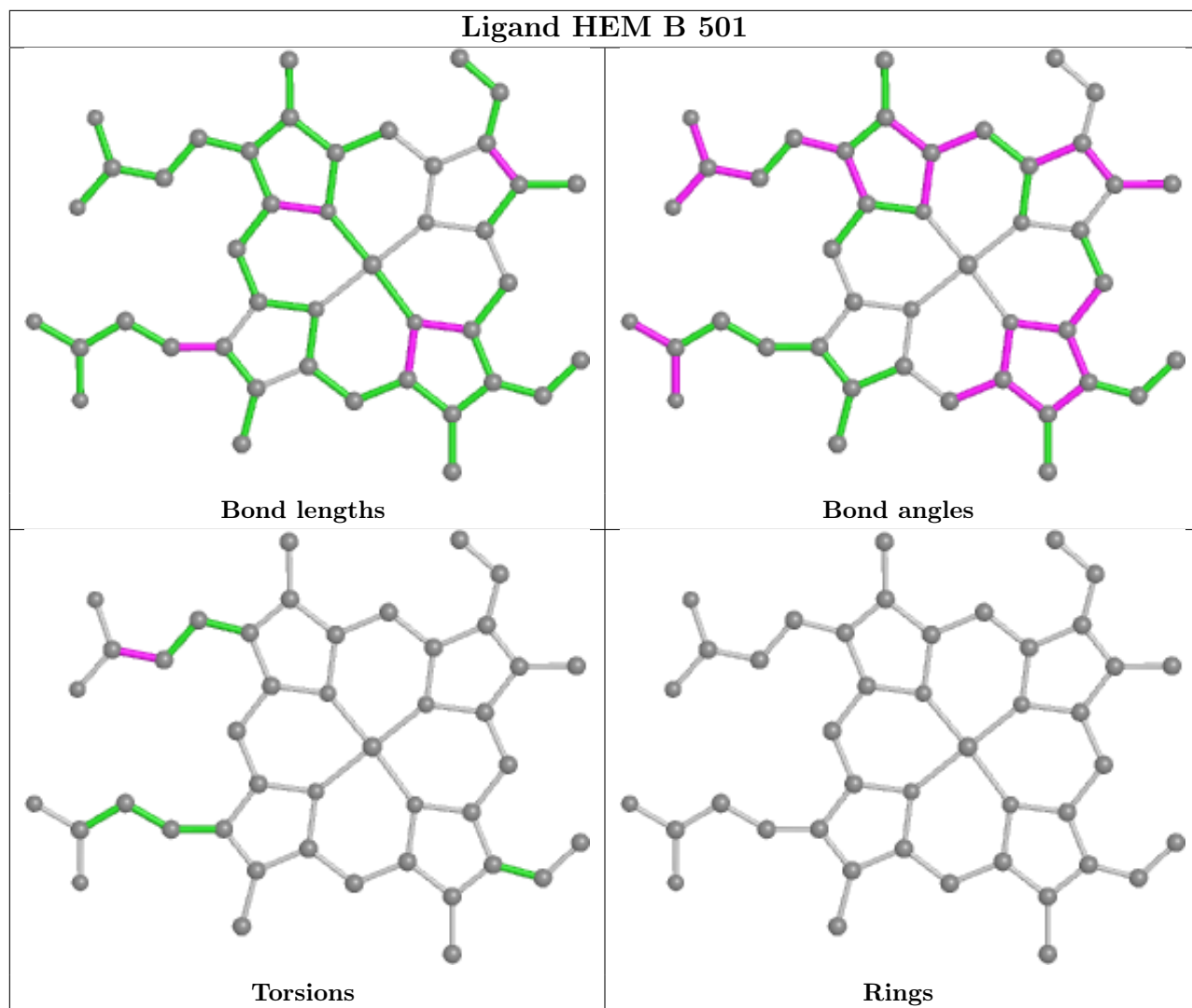

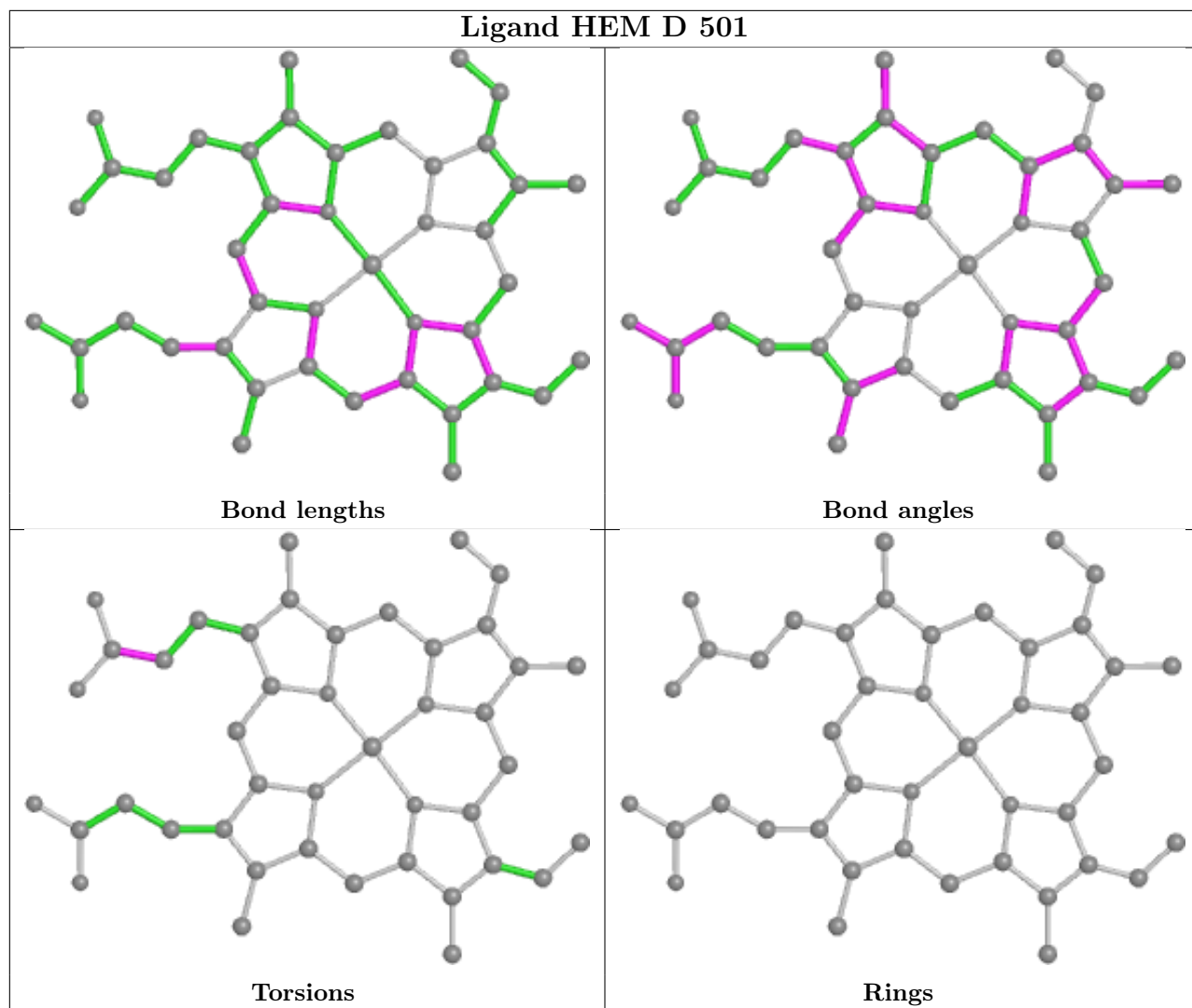

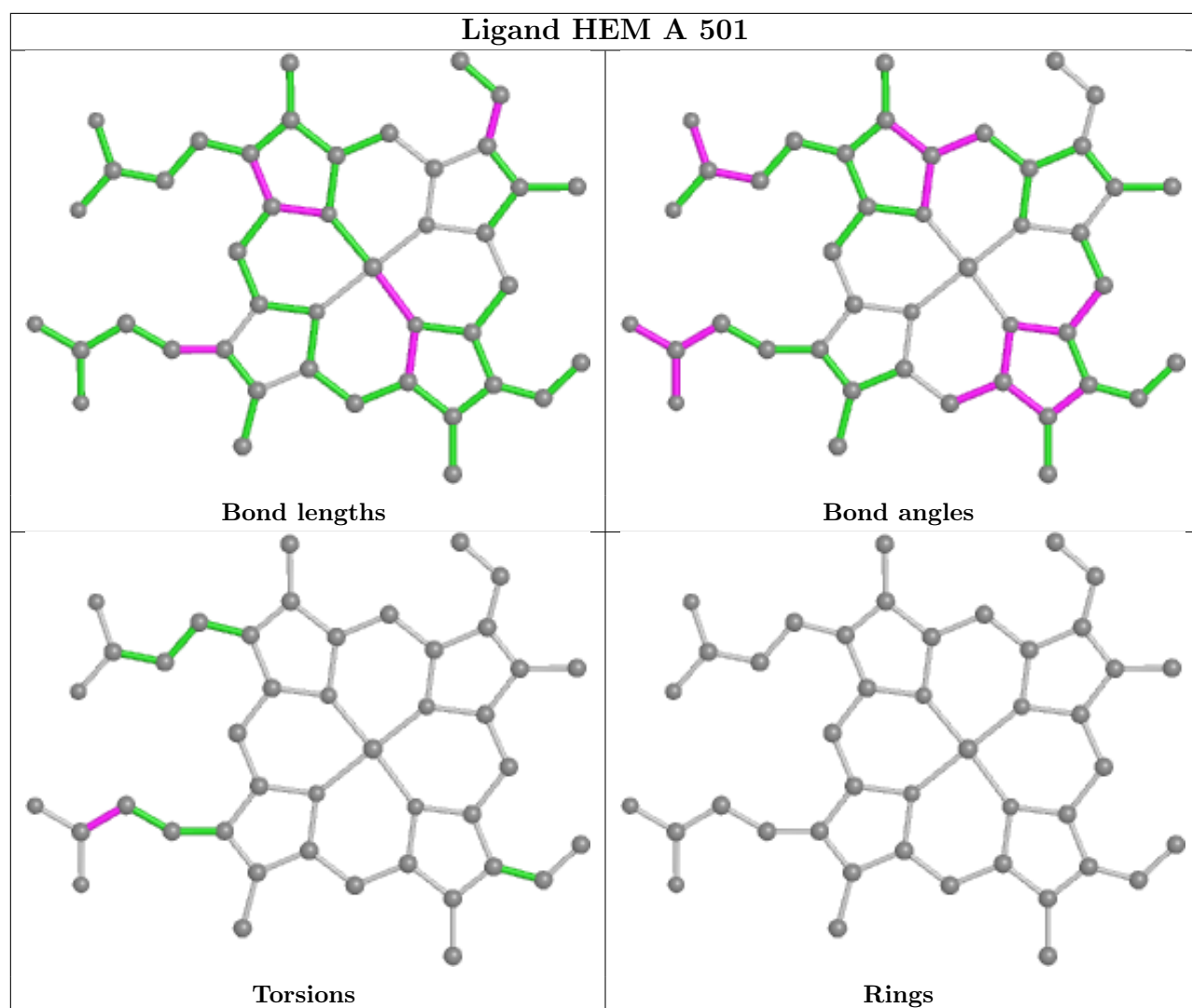

## 5.7 Other polymers [i](#)

There are no such residues in this entry.

## 5.8 Polymer linkage issues [i](#)

There are no chain breaks in this entry.

## 6 Fit of model and data

### 6.1 Protein, DNA and RNA chains

In the following table, the column labelled ‘#RSRZ > 2’ contains the number (and percentage) of RSRZ outliers, followed by percent RSRZ outliers for the chain as percentile scores relative to all X-ray entries and entries of similar resolution. The OWAB column contains the minimum, median, 95<sup>th</sup> percentile and maximum values of the occupancy-weighted average B-factor per residue. The column labelled ‘Q < 0.9’ lists the number of (and percentage) of residues with an average occupancy less than 0.9.

Mol	Chain	Analysed	<RSRZ>	#RSRZ>2	OWAB(Å <sup>2</sup> )	Q<0.9
1	A	381/416 (91%)	-0.05	16 (4%) 36 40	10, 19, 52, 72	0
1	B	383/416 (92%)	-0.13	9 (2%) 60 65	10, 19, 50, 77	0
1	C	397/416 (95%)	0.07	24 (6%) 21 24	12, 20, 52, 86	0
1	D	397/416 (95%)	0.05	16 (4%) 38 42	11, 21, 52, 64	0
All	All	1558/1664 (93%)	-0.01	65 (4%) 36 40	10, 20, 52, 86	0

All (65) RSRZ outliers are listed below:

Mol	Chain	Res	Type	RSRZ
1	C	73	PHE	8.6
1	A	174	PHE	8.3
1	D	73	PHE	5.5
1	A	172	ILE	5.4
1	D	66	ASP	5.1
1	A	166	PHE	4.8
1	A	169	TRP	4.8
1	C	74	VAL	4.7
1	B	185	ILE	4.7
1	D	164	TYR	4.6
1	C	182	LEU	4.3
1	C	185	ILE	4.2
1	C	68	GLN	4.1
1	A	173	LEU	4.0
1	B	72	ILE	3.8
1	C	178	ASP	3.8
1	A	86	ILE	3.6
1	D	161	LYS	3.3
1	D	187	GLN	3.2
1	C	177	TYR	3.2
1	B	172	ILE	3.1

*Continued on next page...*

*Continued from previous page...*

<b>Mol</b>	<b>Chain</b>	<b>Res</b>	<b>Type</b>	<b>RSRZ</b>
1	C	66	ASP	3.0
1	C	164	TYR	2.9
1	B	171	ASP	2.9
1	D	185	ILE	2.9
1	A	70	THR	2.8
1	C	163	ARG	2.7
1	D	226	GLY	2.7
1	A	171	ASP	2.7
1	A	88	ASN	2.7
1	D	225	ASP	2.7
1	C	166	PHE	2.7
1	C	184	GLU	2.7
1	C	69	ARG	2.6
1	D	176	PRO	2.6
1	D	88	ASN	2.6
1	C	95	PRO	2.6
1	C	67	GLY	2.6
1	B	167	LYS	2.5
1	A	87	THR	2.5
1	C	225	ASP	2.5
1	D	177	TYR	2.4
1	D	72	ILE	2.3
1	C	91	ASN	2.3
1	C	161	LYS	2.3
1	A	190	GLN	2.3
1	C	174	PHE	2.3
1	D	183	GLU	2.3
1	A	67	GLY	2.3
1	C	175	GLN	2.2
1	A	199	TYR	2.2
1	B	71	THR	2.2
1	D	95	PRO	2.2
1	B	166	PHE	2.2
1	D	178	ASP	2.2
1	C	176	PRO	2.2
1	C	88	ASN	2.2
1	B	9	THR	2.2
1	A	15	GLN	2.1
1	A	10	GLU	2.1
1	D	68	GLN	2.1
1	C	180	GLU	2.0
1	C	183	GLU	2.0

*Continued on next page...*

*Continued from previous page...*

Mol	Chain	Res	Type	RSRZ
1	A	160	VAL	2.0
1	B	87	THR	2.0

## 6.2 Non-standard residues in protein, DNA, RNA chains [i](#)

There are no non-standard protein/DNA/RNA residues in this entry.

## 6.3 Carbohydrates [i](#)

There are no monosaccharides in this entry.

## 6.4 Ligands [i](#)

In the following table, the Atoms column lists the number of modelled atoms in the group and the number defined in the chemical component dictionary. The B-factors column lists the minimum, median, 95<sup>th</sup> percentile and maximum values of B factors of atoms in the group. The column labelled 'Q<0.9' lists the number of atoms with occupancy less than 0.9.

Mol	Type	Chain	Res	Atoms	RSCC	RSR	B-factors(Å <sup>2</sup> )	Q<0.9
5	PEG	C	505	7/7	0.68	0.16	49,51,52,53	0
4	DMS	B	504	4/4	0.82	0.17	28,38,39,41	0
5	PEG	B	506	7/7	0.83	0.13	50,52,56,58	0
3	SO4	C	506	5/5	0.87	0.22	57,63,64,67	0
8	OXY	C	508	2/2	0.87	0.10	36,36,36,36	0
3	SO4	A	506	5/5	0.88	0.16	55,56,62,66	0
3	SO4	B	510	5/5	0.89	0.14	55,60,67,69	0
7	IMD	C	504	5/5	0.90	0.12	42,43,45,47	0
3	SO4	B	503	5/5	0.91	0.24	32,55,58,60	0
3	SO4	B	509	5/5	0.91	0.15	56,61,63,64	0
3	SO4	A	505	5/5	0.91	0.12	50,56,58,60	0
6	CO	D	504	1/1	0.91	0.06	71,71,71,71	0
3	SO4	C	503	5/5	0.91	0.15	53,57,61,66	0
3	SO4	A	507	5/5	0.91	0.18	65,67,71,72	0
3	SO4	A	502	5/5	0.92	0.15	34,44,47,53	0
3	SO4	C	507	5/5	0.92	0.16	30,41,44,45	0
6	CO	B	508	1/1	0.93	0.05	69,69,69,69	0
3	SO4	A	504	5/5	0.94	0.17	31,50,56,58	0
3	SO4	B	502	5/5	0.95	0.11	43,45,57,58	0
3	SO4	C	502	5/5	0.95	0.08	34,39,40,40	0
3	SO4	A	503	5/5	0.96	0.09	49,54,57,58	0

*Continued on next page...*

Continued from previous page...

Mol	Type	Chain	Res	Atoms	RSCC	RSR	B-factors( $\text{\AA}^2$ )	Q<0.9
3	SO4	B	505	5/5	0.96	0.15	49,50,56,61	0
3	SO4	D	503	5/5	0.96	0.10	43,44,47,52	0
6	CO	B	507	1/1	0.96	0.08	58,58,58,58	0
3	SO4	D	502	5/5	0.97	0.09	37,38,39,41	0
2	HEM	D	501	43/43	0.98	0.08	12,13,16,22	0
2	HEM	C	501	43/43	0.99	0.07	12,14,17,19	0
2	HEM	A	501	43/43	0.99	0.06	10,12,15,21	0
2	HEM	B	501	43/43	0.99	0.07	9,10,14,19	0

The following is a graphical depiction of the model fit to experimental electron density of all instances of the Ligand of Interest. In addition, ligands with molecular weight > 250 and outliers as shown on the geometry validation Tables will also be included. Each fit is shown from different orientation to approximate a three-dimensional view.

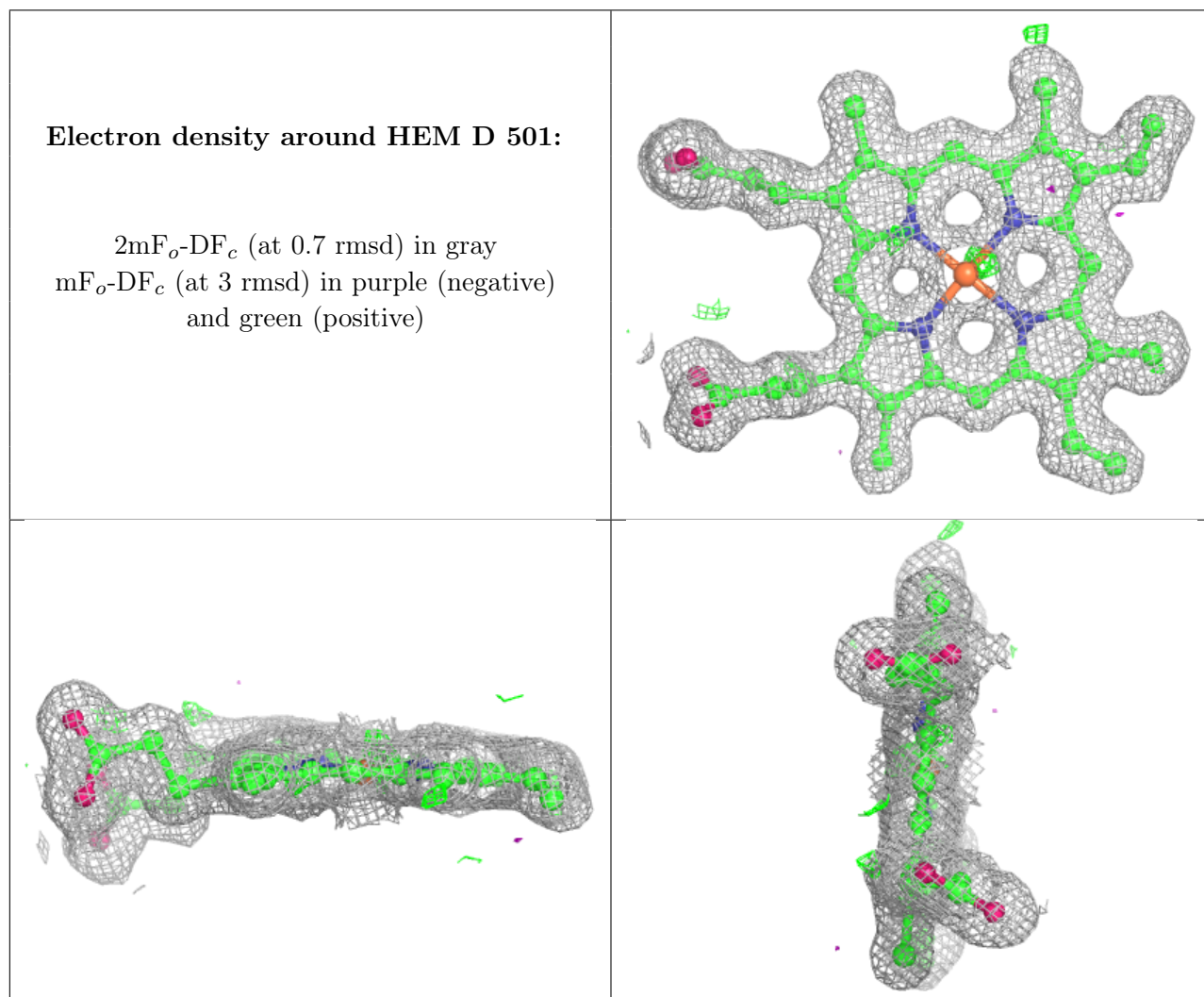



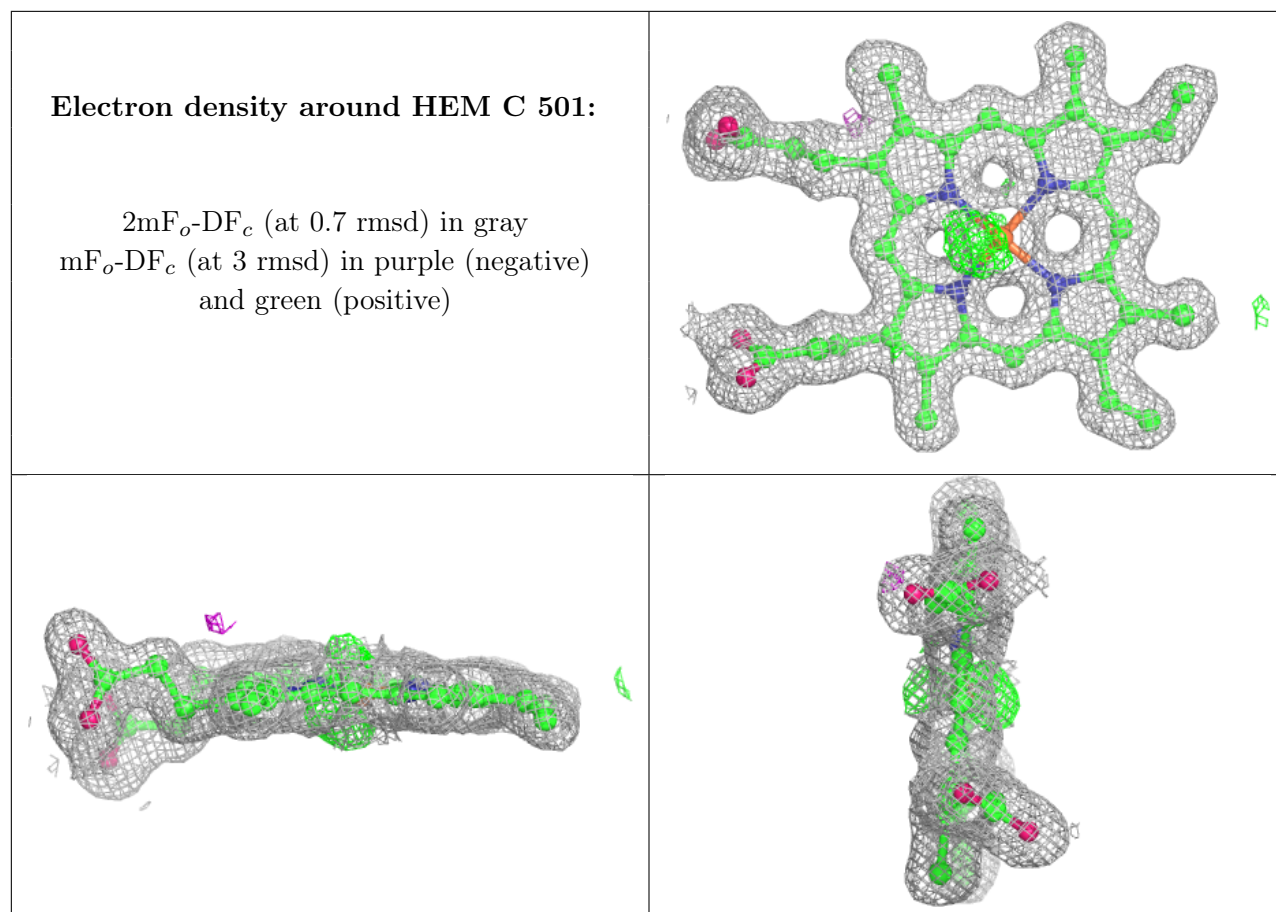

**Electron density around HEM A 501:**

$2mF_o-DF_c$  (at 0.7 rmsd) in gray  
 $mF_o-DF_c$  (at 3 rmsd) in purple (negative)  
and green (positive)

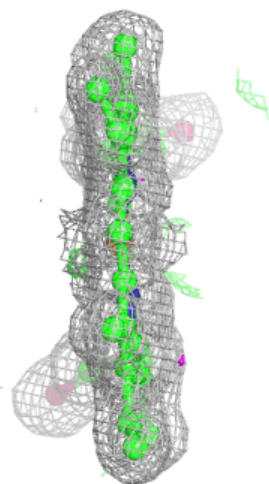
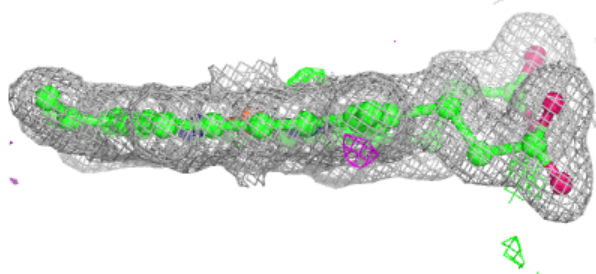
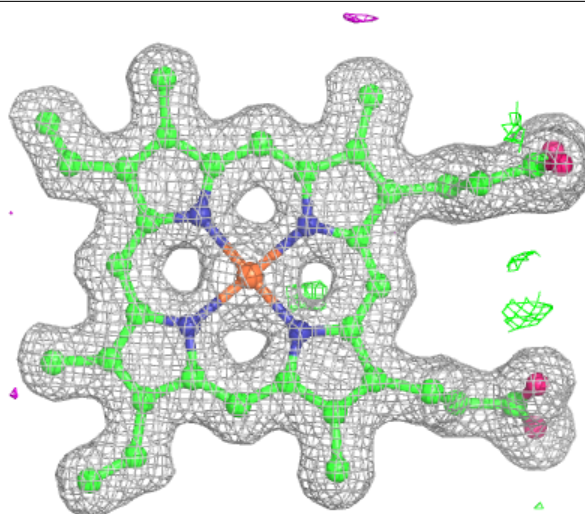

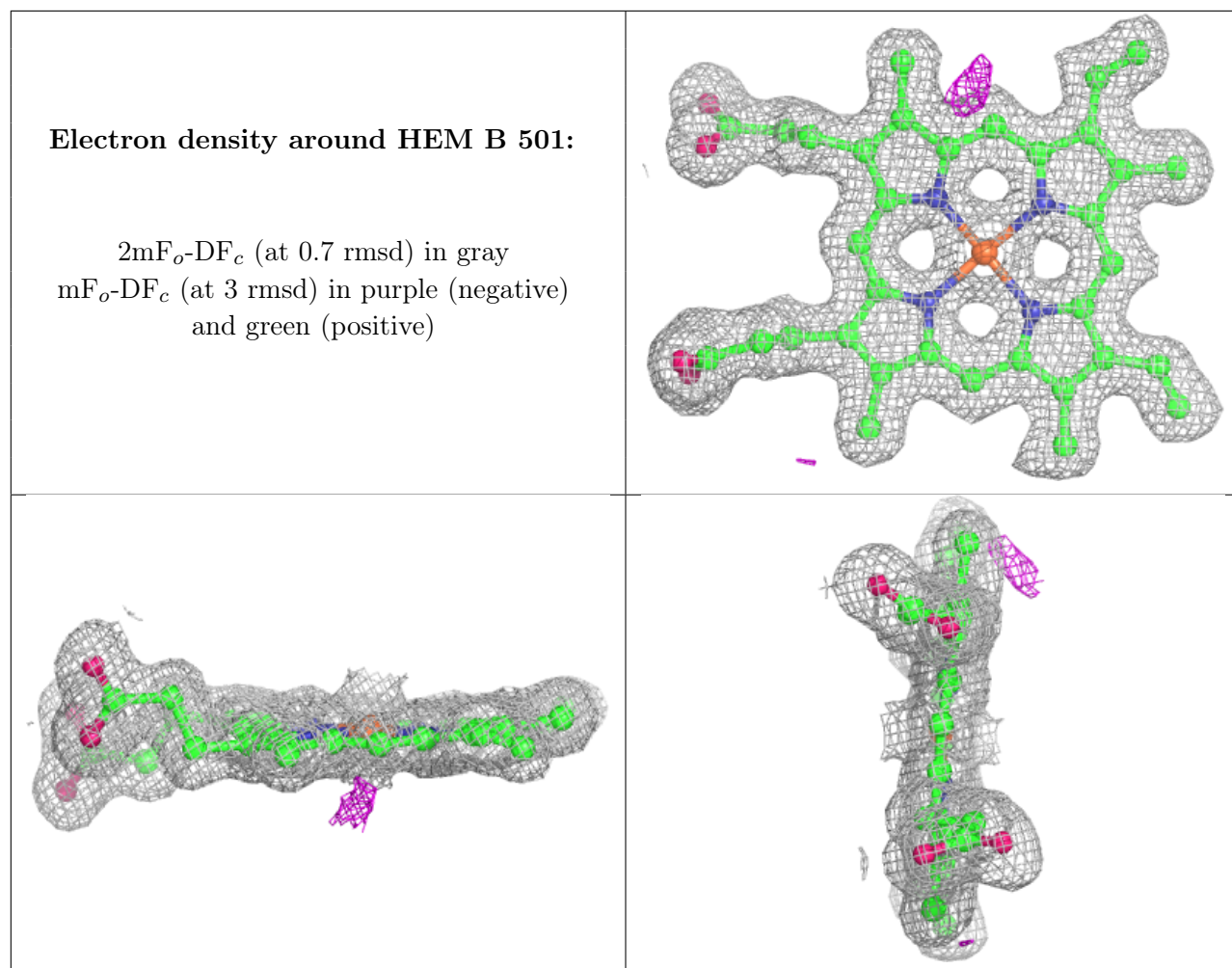

## 6.5 Other polymers [i](#)

There are no such residues in this entry.